

FIGURE 3-1—INTAKE MANIFOLD - EXPLODED VIEW

Key	Part Name	Group	Key	Part Name	Group
1	Stud (To Block).....	3.000	4	Stud (To Exhaust Manifold).....	3.000
2	Gasket (To Block).....	3.000	5	Nut.....	3.000
3	Manifold, Intake.....	3.000	6	Retainer.....	3.000

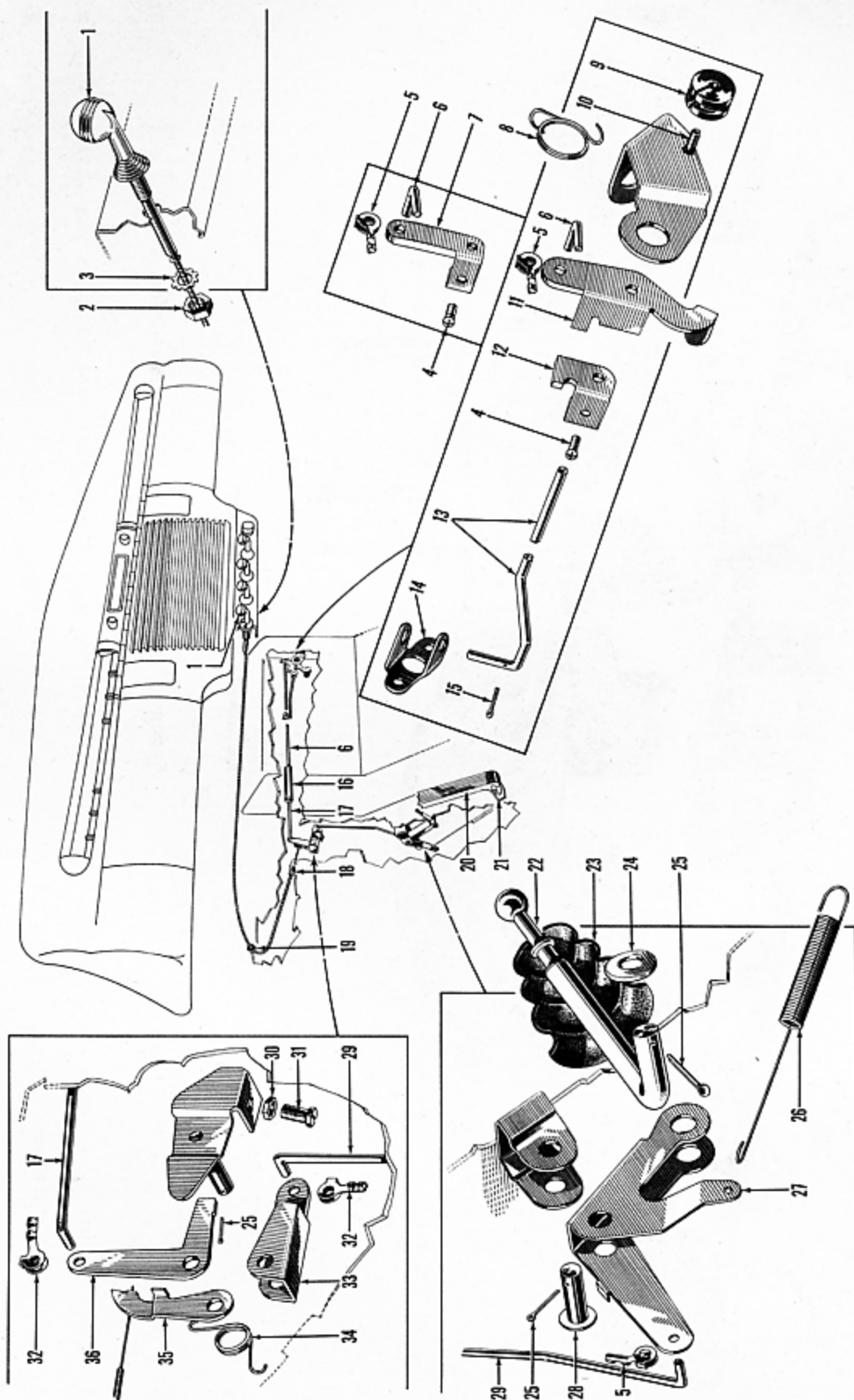

FIGURE 3-2—THROTTLE AND ACCELERATOR CONTROL AND LINKAGE - EXPLODED VIEW

FIGURE 3-2—THROTTLE AND ACCELERATOR CONTROL AND LINKAGE - EXPLODED VIEW

Key	Part Name	Group	Key	Part Name	Group
1	Control, Throttle.....	3.040	19	Grommet, Throttle Control.....	3.040
2	Nut.....	3.040	20	Pedal, Accelerator.....	3.070
3	Lockwasher.....	3.040	21	Bracket, Accelerator Pedal.....	3.070
4	Set Screw, Carburetor Extension Shaft Lever....	3.440	22	Rod, Accelerator Pedal to Bell Crank.....	3.080
5	Clip, L.H. ....	3.410	23	Boot, Accelerator Pedal.....	3.070
6	Rod, Accelerator Cross Shaft.....	3.430	24	Flatwasher.....	3.420
7	Lever, Carburetor Extension Shaft.....	3.440	25	Cotter Pin.....	3.420
8	Spring, Carburetor Extension Shaft Lever.....	3.440	26	Spring, Accelerator Linkage Tension.....	3.400
9	Grommet, Carburetor Extension Shaft.....	3.450	27	Bell Crank, Accelerator-Lower.....	3.090
10	Bushing, Carburetor Extension Shaft.....	3.450	28	Clevis Pin, Accelerator Bell Crank-Lower.....	3.090
11	Lever, Carburetor Extension Shaft.....	3.440	29	Rod, Accelerator Bell Crank Link.....	3.410
12	Lever, Carburetor Extension Shaft (W/OD).....	3.440	30	Nut, Throttle Control Lever Adjusting Screw....	3.060
13	Shaft, Carburetor Extension.....	3.450	31	Screw, Throttle Control Lever Adjusting.....	3.060
14	Connector, Carburetor Extension Shaft.....	3.460	32	Clip, R.H. ....	3.410
15	Cotter Pin.....	3.450	33	Lever, Accelerator Cross Shaft.....	3.430
16	Adjusting Nut, Accelerator Cross Shaft.....	3.430	34	Spring, Throttle Control Lever Return.....	3.060
17	Rod, Accelerator Cross Shaft.....	3.430	35	Lever, Throttle Control.....	3.060
18	Support, Throttle Control.....	3.050	36	Lever, Throttle Control Adjusting.....	3.060

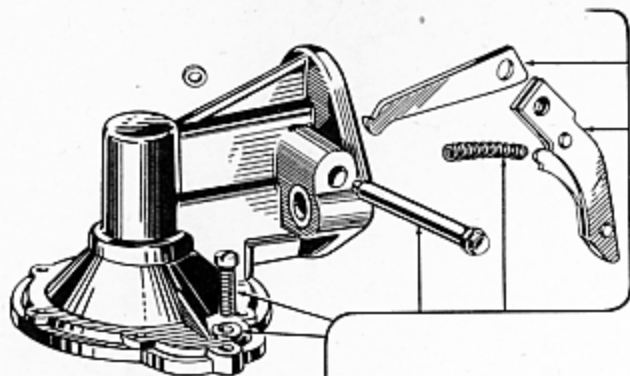

FIGURE 3-3—TYPICAL FUEL PUMP -  
EXPLODED VIEW

Key	Part Name	Group
1	Repair Kit.....	3.480
2	Bail.....	3.490
3	Bowl.....	3.490
4	Gasket.....	3.490
5	Screen.....	3.490
6	Diaphragm Kit.....	3.500

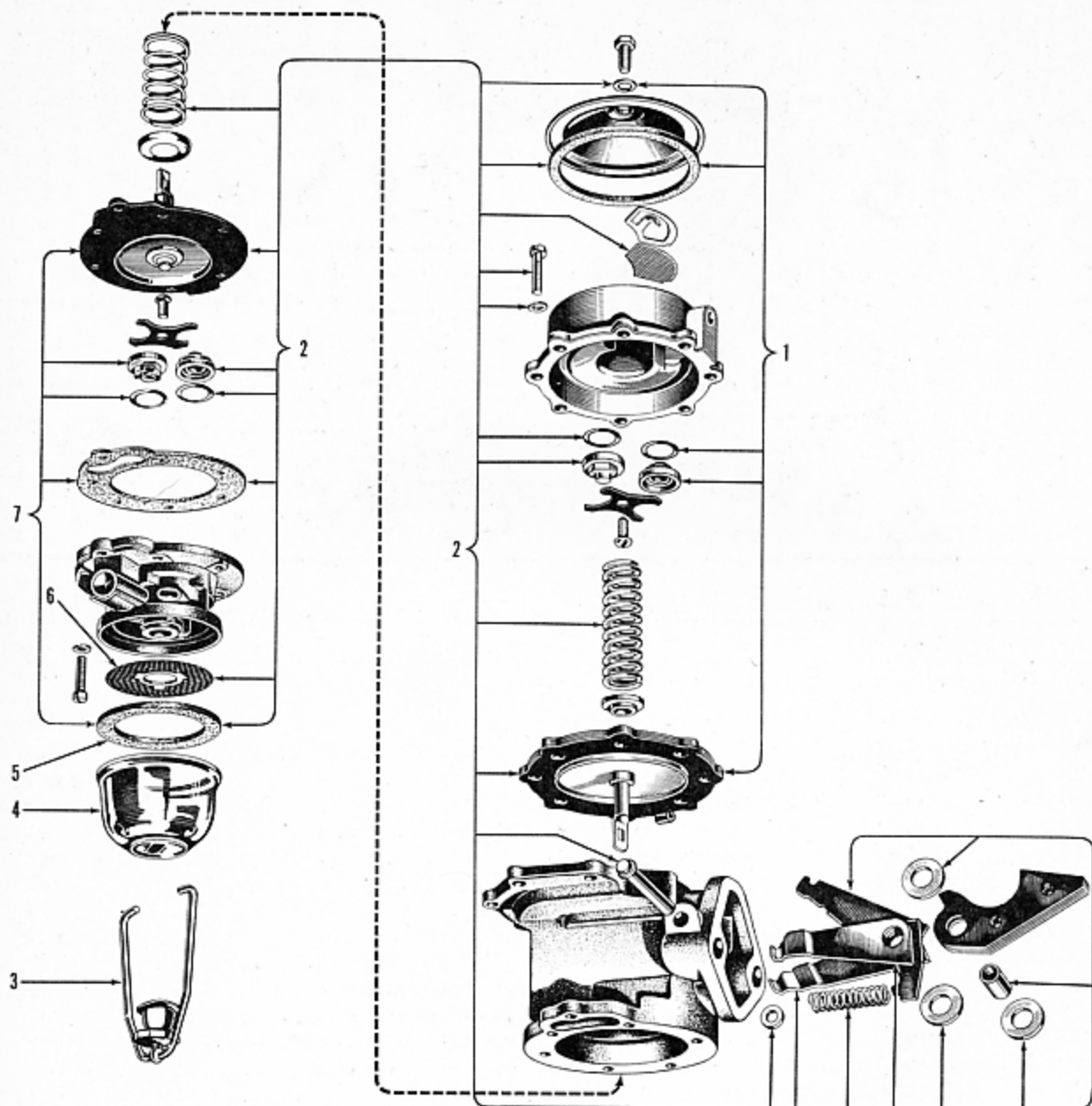

FIGURE 3-4—TYPICAL FUEL AND VACUUM PUMP - EXPLODED VIEW

Key	Part Name	Group	Key	Part Name	Group
1	Diaphragm Kit (Vacuum).....	3.500	5	Gasket.....	3.490
2	Repair Kit.....	3.480	6	Screen.....	3.490
3	Bail.....	3.490	7	Diaphragm Kit (Fuel).....	3.500
4	Bowl.....	3.490			

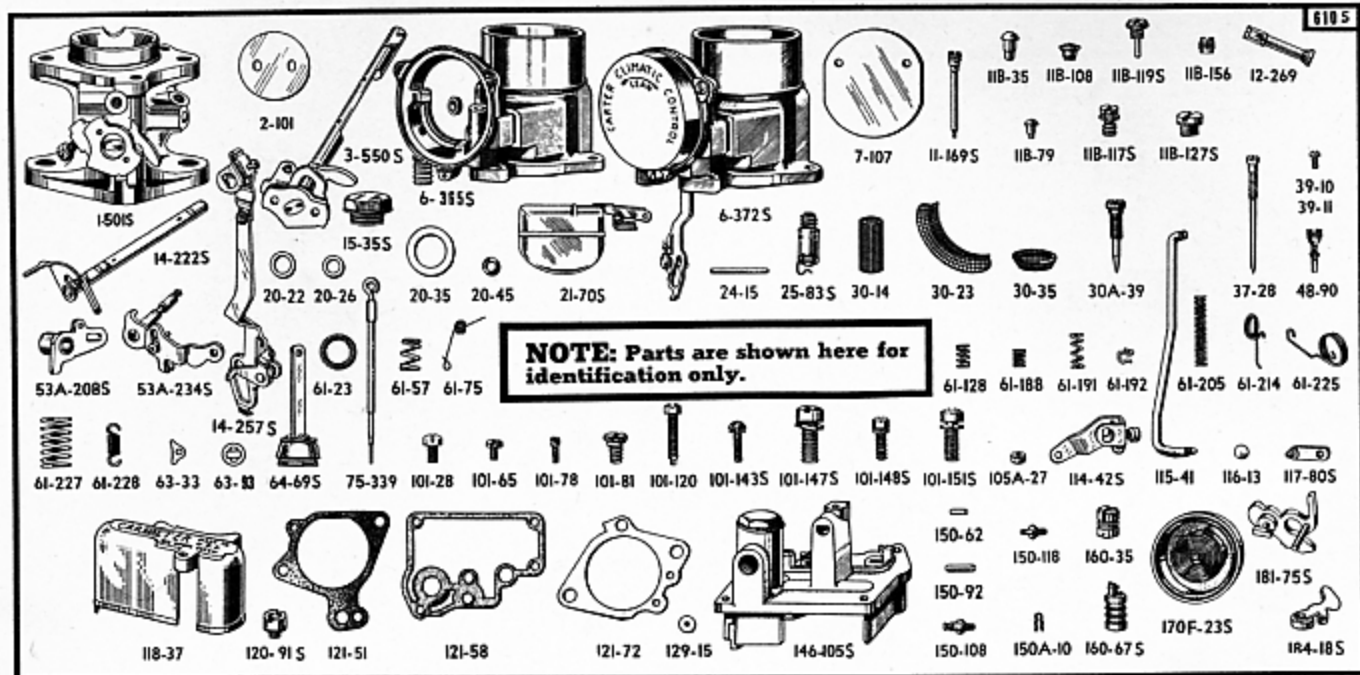

FIGURE 3-5—CARBURETOR - CARTER MODEL WA1-610S

CARTER NO.	PART NO.	DESCRIPTION	QTY.	MODELS
Group 3.600 - Carburetor, Carter Model WA1 - 610S				
1-501S	201643	Body Flange Assembly.....	1	F47, K100
2-101	201644	Valve, Throttle.....	1	F47, K100
3-550S	201646	Shaft Assembly, Throttle Valve.....	1	F47, K100
6-365S	201652	Air Horn Assembly.....	1	F47, K100
6-372S	201651	Air Horn & Climatic Control Assembly.....	1	F47, K100
7-107	201669	Valve, Choke.....	1	F47, K100
11-169S	201692	Jet, Low Speed.....	1	F47, K100
11B-35	201722	Rivet Plug.....	1	F47, K100
11B-79	201723	Rivet Plug.....	5	F47, K100
11B-108	201724	Rivet Plug, Idle Port.....	2	F47, K100
11B-117S	201693	Plug & Gasket Assembly, Idle Passage.....	1	F47, K100
11B-119S	201705	Plug & Gasket Assembly, Pump Check Ball.....	1	F47, K100
11B-127S	201691	Plug & Gasket Assembly, Main Discharge Nozzle...	2	F47, K100
11B-156	201690	Plug, Main Discharge Nozzle Retaining.....	1	F47, K100
12-269	201688	Nozzle, Main Discharge.....	1	F47, K100
14-222S	201659	Piston, Link and Shaft Assembly, Choke.....	1	F47, K100
14-257S	201662	Lever, Link and Screw Assembly, Choke.....	1	F47, K100
15-35S	201676	Plug & Gasket Assembly, Bowl Strainer.....	1	F47, K100
20-22	201679	Gasket, Float Needle Seat.....	3	F47, K100
20-26	201684	Gasket, Metering Rod Jets.....	3	F47, K100
20-35	201677	Gasket, Bowl Strainer Plug.....	1	F47, K100
20-45	201689	Gasket, Main Discharge Nozzle.....	1	F47, K100
21-70S	201681	Float and Lever Assembly.....	1	F47, K100
24-15	201682	Pin, Float Lever Fulcrum.....	1	F47, K100
25-83S	201678	Needle and Seat Assembly, Float.....	1	F47, K100
30-14	201675	Strainer, Bowl.....	1	F47, K100
30-23	201658	Screen, Climatic Control Housing.....	1	F47, K100
30-35	201703	Strainer, Accelerating Pump.....	1	F47, K100
30A-39	201667	Screw, Idle Adjusting.....	1	F47, K100
37-28	201694	Screw, High Speed Adjusting.....	1	F47, K100
39-10	201670	Screw, Choke Valve.....	2	F47, K100
39-11	201645	Screw, Throttle Valve.....	2	F47, K100
48-90	201713	Jet, Pump.....	1	F47, K100

FIGURE 3-5—CARBURETOR - CARTER MODEL WA1-610S (CONT'D.)

CARTER NO.	PART NO.	DESCRIPTION	QTY.	MODELS
53A-208S	201712	Arm and Collar Assembly, Pump.....	1	F47, K100
61-23	201701	Spring, Accelerating Pump Piston.....	1	F47, K100
61-57	201668	Spring, Idle Adjusting Screw.....	1	F47, K100
61-75	201685	Spring, Metering Rod.....	1	F47, K100
61-128	201720	Spring, Throttle Connector Rod.....	2	F47, K100
61-188	201699	Spring, Anti-Percolator Rocker Arm.....	1	F47, K100
61-191	201695	Spring, High Speed Adjusting Screw.....	1	F47, K100
61-192	201680	Clip, Float Needle Valve.....	1	F47, K100
61-205	201715	Spring, Vacuum Piston.....	1	F47, K100
61-214	201664	Spring, Choke Trip Lever.....	1	F47, K100
61-225	201711	Spring, Vacuum Hold Down.....	1	F47, K100
61-227	201702	Spring, Accelerating Pump.....	1	F47, K100
61-228	201710	Spring, Pump Operating Lever.....	1	F47, K100
63-33	201656	Retainer, Climatic Control Housing.....	3	F47, K100
63-93	202383	Retainer, Throttle Connector Rod Spring.....	2	F47, K100
64-69S	201740	Rod and Plunger Assembly, Accelerating Pump.....	1	F47, K100
75-339	201686	Metering Rod.....	1	F47, K100
101-28	201718	Screw, Throttle Shaft Arm Set.....	1	F47, K100
101-65	201657	Screw, Climatic Control Housing.....	3	F47, K100
101-78	201663	Screw, Choke Lever Clamp.....	1	F47, K100
101-81	201666	Screw, Fast Idle Cam.....	1	F47, K100
101-120	201647	Adjusting Screw, Throttle Lever.....	1	F47, K100
101-143S	201654	Screw & Washer, Choke Body to Main Body,.....	1	F47, K100
101-147S	201649	Screw & Washer, Main Body to Throttle Body.....	2	F47, K100
101-148S	201672	Screw & Washer Assembly, Dust Cover.....	5	F47, K100
101-151S	201653	Screw & Washer, Choke Body to Main Body.....	2	F47, K100
105A-27	201709	Nut, Pump Link Counter Pin, Hex. ....	2	F47, K100
114-42S	201717	Arm and Screw Assembly, Throttle Shaft.....	1	F47, K100
115-41	201716	Rod, Throttle Connector.....	1	F47, K100
116-13	201704	Ball, Accelerating Pump Check.....	2	F47, K100
117-80S	201706	Link and Pin Assembly, Pump.....	1	F47, K100
118-37	201671	Dust Cover.....	1	F47, K100
120-91S	201683	Jet and Gasket Assembly, Metering Rod.....	1	F47, K100
121-51	201650	Gasket, Main Body.....	1	F47, K100
121-58	201674	Gasket, Bowl Cover.....	1	F47, K100
121-72	201648	Gasket, Throttle Body to Main Body.....	1	F47, K100
129-15	201696	Disc, Metering Rod.....	1	F47, K100
146-105S	201673	Cover and Strainer Assembly, Bowl.....	1	F47, K100
150-62	201661	Pin, Choke Piston.....	1	F47, K100
150-92	201698	Pin, Anti-Percolator Rocker Arm.....	1	F47, K100
150-108	201721	Pin, Connector Link Upper.....	1	F47, K100
150-118	201708	Counter Pin, Pump Link.....	1	F47, K100
150A-10	201687	Pin, Metering Rod Retaining.....	2	F47, K100
160-35	201660	Piston, Choke.....	1	F47, K100
160-67S	201714	Piston and Pin, Vacuum.....	1	F47, K100
170F-23S	201655	Housing and Coil, Climatic Control.....	1	F47, K100
181-75S	201665	Cam and Pin Assembly, Fast Idle.....	1	F47, K100
184-18S	201697	Arm and Cap Assembly, Anti-Percolator Rocker....	1	F47, K100

Note: The following parts not illustrated.

200322	Stud, Carb. Mounting, 3/8"-16 x 3/8"-24 x 1 3/8"	2	F47, K100	
291	Lockwasher, Carb. Mounting, 3/8" Ext. Tooth.....	2	F47, K100	
290	Nut, Carb. Mounting, 3/8"-24 Hx. ....	2	F47, K100	
200495	Gasket (to Manifold).....	1	F47, K100	
53A-277U	201707	Lever and Link Unit, Pump Operating.....	1	F47, K100
162	201753	Gasket Assortment.....	1	F47, K100
1095	201752	Repair Kit.....	1	F47, K100

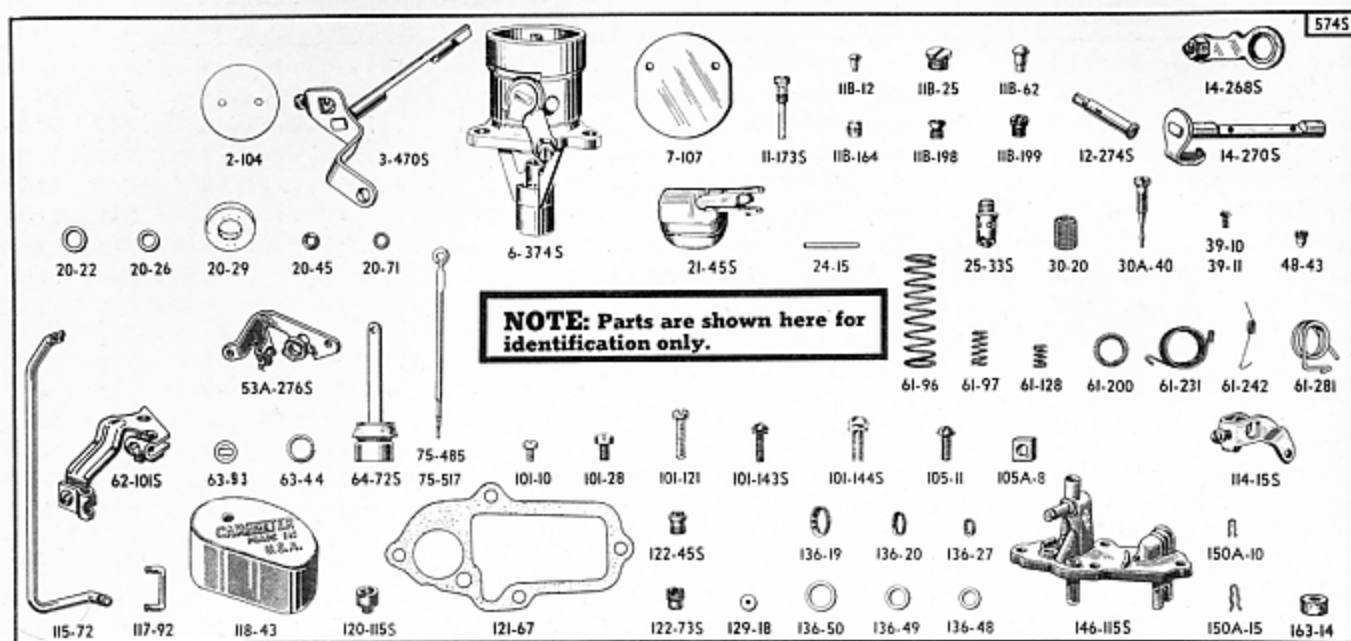

FIGURE 3-6—CARBURETOR - CARTER MODEL WA1-574S (Manual Choke)

CARTER NO.	PART NO.	DESCRIPTION	QTY.	MODEL
Group 3.620 - Carburetor - Carter Model WA1-574S (Manual Choke) Part No. 203043				
2-104	203188	Valve, Throttle.....	1	F47, F47C, K100, K101
3-470S	203189	Shaft Assy., Throttle Valve.....	1	F47, F47C, K100, K101
6-374S	203190	Air Horn Assy. ....	1	F47, F47C, K100, K101
7-107	201669	Valve, Choke.....	1	F47, F47C, K100, K101
11-173S	203191	Jet Assy., Low Speed.....	1	F47, F47C, K100, K101
11B-12	203239	Rivet Plug.....	7	F47, F47C, K100, K101
11B-25	203243	Plug, Disc Check Passage.....	1	F47, F47C, K100, K101
11B-62	203249	Rivet Plug.....	1	F47, F47C, K100, K101
11B-164	203847	Plug, Nozzle.....	1	F47, F47C, K100, K101
11B-198	203192	Plug, Pump Jet Passage.....	1	F47, F47C, K100, K101
11B-199	203193	Plug, Idle Hole Passage.....	1	F47, F47C, K100, K101
12-274S	203194	Nozzle Assy. ....	1	F47, F47C, K100, K101
14-268S	203220	Choke Lever Assy. ....	1	F47, F47C, K100, K101
14-270S	203195	Shaft & Lever Assy., Choke.....	1	F47, F47C, K100, K101
20-22	201679	Gasket, Idle Hole Passage Plug.....	1	F47, F47C, K100, K101
20-26	201684	Gasket, Metering Rod Jet.....	1	F47, F47C, K100, K101
20-29	203221	Gasket, Pump Cylinder - Upper.....	1	F47, F47C, K100, K101
20-45	201689	Gasket, Main Discharge Nozzle.....	1	F47, F47C, K100, K101
20-71	203196	Gasket, Air Horn.....	1	F47, F47C, K100, K101
21-45S	203197	Float, Lever Assy. ....	1	F47, F47C, K100, K101
24-15	201682	Pin, Float Lever Fulcrum.....	1	F47, F47C, K100, K101
25-33S	203198	Needle & Seat Assy. ....	1	F47, F47C, K100, K101
30-20	203242	Strainer, Bowl.....	1	F47, F47C, K100, K101
30A-40	203199	Screw, Idle Adjustment.....	1	F47, F47C, K100, K101
39-10	201670	Screw, Choke Valve.....	2	F47, F47C, K100, K101
39-11	201645	Screw, Throttle Valve.....	2	F47, F47C, K100, K101
48-43	203200	Jet, Pump.....	1	F47, F47C, K100, K101
53A-276S	203201	Lever Assy., Pump.....	1	F47, F47C, K100, K101
61-96	203202	Spring, Pump.....	1	F47, F47C, K100, K101



FIGURE 3-6—CARBURETOR - CARTER MODEL WA1-574S (MANUAL CHOKE) (CONT'D.)

CARTER NO.	PART NO.	DESCRIPTION	QTY.	MODEL
61-97	203203	Spring, Adjusting Screw Lock.....	1	F47, F47C, K100, K101
61-128	201720	Spring, Throttle Connector Rod.....	1	F47, F47C, K100, K101
61-200	203204	Spring, Accelerating Pump Piston.....	1	F47, F47C, K100, K101
61-231	203205	Spring, Choke Valve.....	1	F47, F47C, K100, K101
61-242	203206	Spring, Metering Rod.....	1	F47, F47C, K100, K101
61-281	203207	Spring, Pump Connector Link.....	1	F47, F47C, K100, K101
62-101S	203222	Clamp Assy., Tube.....	1	F47, F47C, K100, K101
63-44	203223	Ring, Retainer.....	1	F47, F47C, K100, K101
63-93	202383	Retainer.....	1	F47, F47C, K100, K101
64-72S	203208	Plunger & Rod Assy. ....	1	F47, F47C, K100, K101
75-485	203209	Metering Rod.....	1	F47, F47C, K100, K101
75-517	203210	Metering Rod, 1st Lean.....	1	F47, F47C, K100, K101
101-10	203324	Screw, Wire Clamp.....	1	F47, F47C, K100, K101
101-28	201718	Screw, Throttle Shaft Arm Set.....	1	F47, F47C, K100, K101
101-121	203211	Screw, Throttle Lever Adjusting.....	1	F47, F47C, K100, K101
101-143S	201654	Screw & Washer, Dust Cover.....	1	F47, F47C, K100, K101
101-144S	203226	Screw & Washer, Air Horn & Bowl Cover...	7	F47, F47C, K100, K101
105-11	203228	Screw, Tube Clamp.....	2	F47, F47C, K100, K101
105A-8	203229	Nut, Tube Clamp.....	2	F47, F47C, K100, K101
114-15S	203230	Arm & Screw Assy., Throttle Shaft.....	1	F47, F47C, K100, K101
115-72	203212	Rod, Throttle Connector.....	1	F47, F47C, K100, K101
117-92	203213	Link, Connector.....	1	F47, F47C, K100, K101
118-43	203214	Cover, Dust.....	1	F47, F47C, K100, K101
120-115S	203215	Jet Assy., Metering Rod.....	1	F47, F47C, K100, K101
121-67	203231	Gasket, Bowl Cover.....	1	F47, F47C, K100, K101
122-45S	203241	Check Assy., Intake Disc.....	1	F47, F47C, K100, K101
122-73S	203240	Check Assy., Discharge Disc.....	1	F47, F47C, K100, K101
129-18	203216	Disc, Metering Rod.....	1	F47, F47C, K100, K101
136-19	203232	Washer, Plug (conical).....	1	F47, F47C, K100, K101
136-20	203233	Washer, Plug (conical).....	2	F47, F47C, K100, K101
136-27	203234	Washer, Plug (conical).....	2	F47, F47C, K100, K101
136-48	203237	Washer, Plug (flat).....	2	F47, F47C, K100, K101
136-49	203236	Washer, Plug (flat).....	2	F47, F47C, K100, K101
136-50	203235	Washer, Plug (flat).....	1	F47, F47C, K100, K101
146-115S	203238	Cover and Countershaft Assy., Bowl.....	1	F47, F47C, K100, K101
150A-10	201687	Pin, Metering Rod.....	3	F47, F47C, K100, K101
150A-15	203217	Pin, Metering Rod Retainer.....	1	F47, F47C, K100, K101
163-14	203250	Packing, Felt.....	1	F47, F47C, K100, K101

Note: The following parts not illustrated.

200322	Stud, Carb. Mounting, 3/8"-16 x 3/8" - 24 x 1 3/8".....	2	F47, F47C, K100, K101	
291	Lockwasher, Carb. Mounting, 3/8" Ext. Tooth.....	2	F47, F47C, K100, K101	
290	Nut, Carb. Mounting, 3/8"-24 Hx. ....	2	F47, F47C, K100, K101	
200437	Gasket (to Manifold).....	1	F47, F47C, K100, K101	
138A	203218	Gasket Assortment.....	1	F47, F47C, K100, K101
1089B	203219	Repair Kit.....	1	F47, F47C, K100, K101

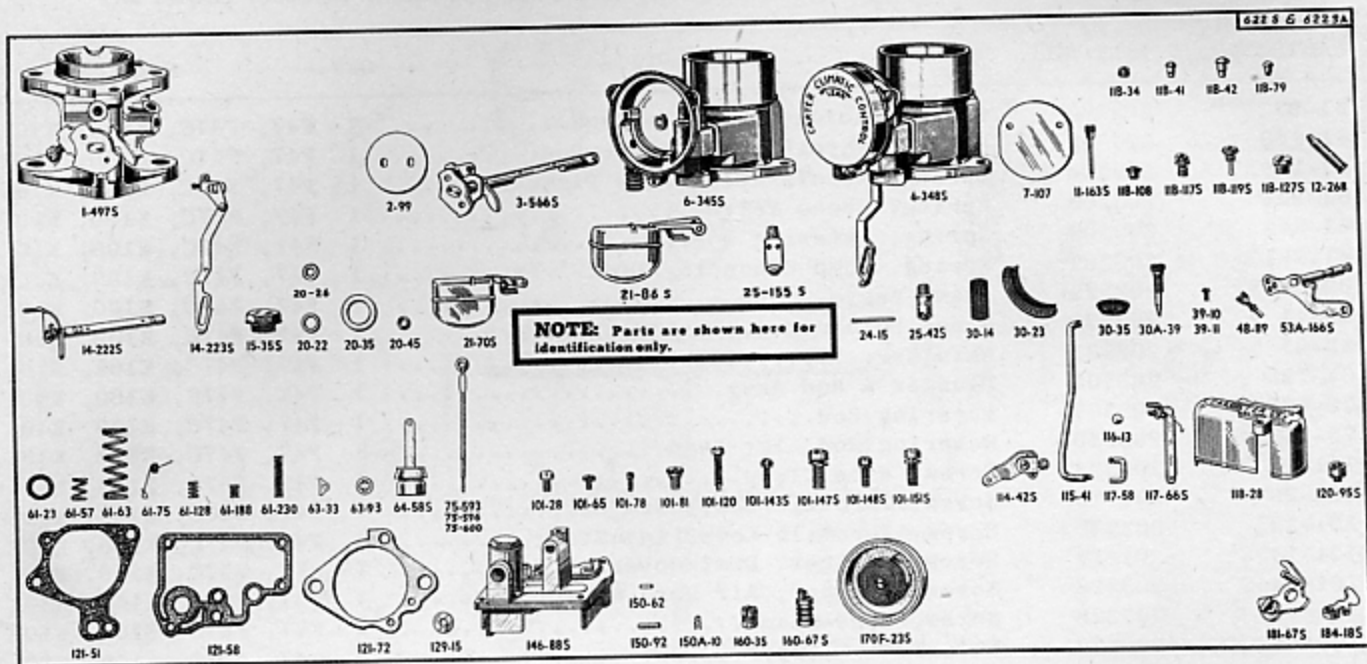

FIGURE 3-7—CARBURETOR - CARTER MODELS WA1-622S AND 622SA

CARTER NO.	PART NO.	DESCRIPTION	QTY.	MODEL
<b>3.640 - Carburetor, Carter Models WA1-622S, 622SA (Part No. 202382, 622SA Only)</b>				
1-497S	201726	Body Flange Assembly .....	1	All
2-99	201727	Valve, Throttle .....	1	All
3-566S	201728	Shaft Assembly, Throttle Valve .....	1	All
6-345S	201730	Air Horn Assembly .....	1	All
6-348S	201729	Air Horn & Climatic Control Assembly .....	1	All
7-107	201669	Valve, Choke .....	1	All
11-163S	201741	Jet Assembly, Low Speed .....	1	All
11B-34	201740	Plug, Main Discharge Nozzle Retaining .....	1	All
11B-41	201750	Rivet Plug .....	1	All
11B-42	201751	Rivet Plug .....	1	All
11B-79	201723	Rivet Plug .....	5	All
11B-108	201724	Rivet Plug, Idle Port .....	1	All
11B-117S	201693	Plug & Gasket Assembly, Idle Passage .....	1	All
11B-119S	201705	Plug & Gasket Assembly, Pump Check Ball .....	1	All
11B-127S	201691	Plug & Gasket Assembly, Main Discharge Nozzle ..	1	All
12-268	201739	Nozzle, Main Discharge .....	1	All
14-222S	201659	Piston, Link and Shaft Assembly, Choke .....	1	All
14-223S	201731	Lever, Link & Screw Assembly, Choke .....	1	All
15-35S	201676	Plug & Gasket Assembly, Bowl Strainer .....	3	All
20-22	201679	Gasket, Float Needle Seat .....	3	All
20-26	201684	Gasket, Metering Rod Jets .....	1	All
20-35	201677	Gasket, Bowl Strainer Plug .....	1	All
20-45	201689	Gasket, Main Discharge Nozzle .....	1	All
21-70S	201681	Float and Lever Assembly (622S only) .....	1	F47, K100
21-86S	202371	Float and Lever Assembly (622SA only) .....	1	All
24-15	201682	Pin, Float Lever Fulcrum .....	1	All
25-42S	201736	Needle and Seat Assembly, Float (622S only) ....	1	F47, K100
25-155S	202372	Needle and Seat Assembly, Float (622SA only)....	1	All
30-14	201675	Strainer, Bowl .....	1	All

FIGURE 3-7—CARBURETOR - CARTER MODELS WA1-622S AND 622SA (CONT'D.)

CARTER NO.	PART NO.	DESCRIPTION	QTY.	MODEL
30-23	201658	Screen, Climatic Control Housing .....	1	All
30-35	201703	Strainer, Accelerating Pump .....	1	All
30A-39	201667	Screw, Idle Adjusting .....	1	All
39-10	201670	Screw, Choke Valve .....	2	All
39-11	201645	Screw, Throttle Valve .....	2	All
48-89	201748	Jet, Pump .....	1	All
53A-166S	201746	Lever & Countershaft, Pump Operating .....	1	All
61-23	201701	Spring, Accelerating Pump Piston .....	1	All
61-57	201668	Spring, Idle Adjusting Screw .....	1	All
61-63	201743	Spring, Accelerating Pump .....	1	All
61-75	201685	Spring, Metering Rod .....	1	All
61-128	201720	Spring, Throttle Connector Rod .....	1	All
61-188	201699	Spring, Anti-Percolator Rocker Arm .....	1	All
61-230	201749	Spring, Vacuum Piston .....	1	All
63-33	201656	Retainer, Climatic Control Housing .....	3	All
63-93	202383	Retainer, Throttle Connector Rod Spring .....	1	All
64-58S	201742	Rod and Plunger Assembly, Accelerating Pump ....	1	All
75-593	201738	Metering Rod .....	1	All
75-599	201786	Metering Rod, 1st Lean .....	1	All
75-600	201787	Metering Rod, 2nd Lean .....	1	All
101-28	201718	Screw, Throttle Shaft Arm Set .....	1	All
101-65	201657	Screw, Climatic Control Housing .....	3	All
101-78	201663	Screw, Choke Lever Clamp .....	1	All
101-81	201666	Screw, Fast Idle Cam .....	1	All
101-120	201647	Adjusting Screw, Throttle Lever .....	1	All
101-143S	201654	Screw & Washer, Choke Body to Main Body .....	1	All
101-147S	201649	Screw & Washer, Main Body to Throttle Body ....	2	All
101-148S	201672	Screw & Washer, Dust Cover .....	5	All
101-151S	201653	Screw & Washer, Choke Body to Main Body .....	2	All
114-42S	201717	Arm and Screw Assembly, Throttle Shaft .....	1	All
115-41	201716	Rod, Throttle Connector .....	1	All
116-13	201704	Ball, Accelerating Pump Check .....	2	All
117-58	201744	Link, Pump .....	1	All
117-66S	201747	Link and Spring, Pump Operating .....	1	All
118-28	201733	Cover, Dust .....	1	All
120-95S	201737	Jet and Gasket Assembly, Metering Rod .....	1	All
121-51	201650	Gasket, Main Body .....	1	All
121-58	201674	Gasket, Bowl Cover .....	1	All
121-72	201648	Gasket, Throttle Body to Main Body .....	1	All
129-15	201696	Disc, Metering Rod .....	1	All
146-88S	201735	Cover, Bowl .....	1	All
150-62	201661	Pin, Choke Piston .....	1	All
150-92	201698	Pin, Anti-Percolator Rocker Arm .....	1	All
150A-10	201687	Pin, Metering Rod Retaining .....	3	All
160-35	201660	Piston, Choke .....	1	All
160-67S	201714	Piston and Pin, Vacuum .....	1	All
170F-23S	201655	Housing and Coil, Climatic Control .....	1	All
181-67S	201732	Cam and Pin Assembly, Fast Idle .....	1	All
184-18S	201697	Arm and Cap Assembly, Anti-Percolator Rocker ...	1	All

Note: The following parts not illustrated.

200322	Stud, Carb. Mtg., 3/8"-16 x 3/8" - 24 x 1 3/8" .	2	All
291	Lockwasher, Carb. Mtg., 3/8" Ext. Tooth .....	2	All
290	Nut, Carb. Mtg., 3/8" - 24 Hx. ....	2	All
200437	Gasket (to Manifold).....	1	All
75-602U	Metering Rod Kit (Export).....	1	All
139A	Gasket Assortment .....	1	All
1362A	Repair Kit .....	1	All

## GROUP 3.660 - CARBURETOR - CARTER MODEL WCD-685S (DUAL) PART NO. 203354

CARTER NO.	PART NO.	DESCRIPTION	QTY.	MODELS
1-601S	203754	Body Flange Assembly.....	1	F486
2-92	203755	Throttle Valve.....	2	F486
3-624S	203756	Shaft and Lever Assembly, Throttle.....	1	F486
6-588S	203757	Air Horn Assembly.....	1	F486
7-154	203758	Valve, Choke.....	1	F486
11-191S	203759	Jet Assembly, Low Speed.....	2	F486
11B-41	201750	Rivet Plug.....	2	F486
11B-79	201723	Rivet Plug.....	3	F486
11B-108	201724	Rivet Plug, Idle Port.....	2	F486
11B-129S	203760	Plug and Gasket Assembly, Pump Discharge Passage..	1	F486
11B-223	203761	Plug, Nozzle Passage.....	2	F486
14-296S	203762	Lever and Screw Assembly, Choke.....	1	F486
14-344S	203763	Lever, Link and Shaft Assembly, Choke Piston.....	1	F486
14-355	203764	Trip Lever, Cam.....	1	F486
15-35S	201676	Nut and Gasket Assembly, Strainer.....	1	F486
17-66	203811	Check Needle, Pump Discharge.....	1	F486
20-22	201679	Gasket, Needle Seat.....	1	F486
20-26	201684	Gasket, Pump Discharge Passage Plug.....	1	F486
20-35	201677	Gasket, Bowl Strainer Nut.....	1	F486
20-54	203765	Gasket, Metering Rod Jet.....	2	F486
21-80S	203766	Float and Lever Assembly.....	1	F486
24-24	203767	Pin, Float Lever.....	1	F486
25-161S	203768	Needle and Seat Assembly.....	1	F486
30-14	201675	Strainer, Bowl Cover.....	1	F486
30-42	203769	Strainer, Pump.....	1	F486
30A-41	203770	Screw, Idle Adjustment.....	2	F486
39-10	201670	Screw, Choke Valve Attaching.....	2	F486
48-143S	203771	Jet and Housing Assembly, Pump.....	1	F486
53A-284S	203812	Lever and Countershaft Assembly, Pump Operating...	1	F486
61-57	201668	Spring, Idle Adjustment Screw Lock.....	2	F486
61-128	201720	Spring, Connector Rod.....	1	F486
61-207	203772	Spring, Intake Needle.....	1	F486
61-234	203773	Spring, Metering Rod.....	1	F486
61-266	203774	Spring, Fast Idle Cam.....	1	F486
61-338	203775	Spring, Plunger.....	1	F486
61-365	203776	Spring, Pump (Lower).....	1	F486
61-377	203777	Spring, Vacuum Piston.....	1	F486
61-378	203778	Spring, Pump (Upper).....	1	F486
63-58	203779	Retainer, Coil Housing.....	3	F486
63-92	203780	Retainer, Pump Spring.....	1	F486
63-93	202383	Retainer, Connector Rod Spring.....	1	F486
63-118	203781	Retaining Ring, Throttle Shaft (Prongs Extending Outward).....	1	F486
64-120S	203782	Spring and Retainer Assembly, Pump Plunger Rod....	1	F486
75-622	203783	Metering Rod.....	2	F486
101-19	203784	Screw, Choke Lever Clamp.....	1	F486
101-67	203813	Screw, Pump Retainer.....	1	F486
101-73	203814	Screw, Throttle Valve Attaching.....	4	F486
101-74	203785	Screw, Throttle Shaft Dog.....	1	F486
101-84	203786	Screw, Fast Idle Adjustment.....	1	F486
101-121	203211	Screw, Throttle Lever Adjustment.....	1	F486
101-136	203815	Screw, Coil Housing Attaching.....	3	F486
101-140	203816	Screw, Fast Idle Cam Attaching.....	1	F486

GROUP 3.660 CARBURETOR - CARTER MODEL WCD-685S (DUAL) PART NO. 203354 (CONT'D.)

CARTER NO.	PART NO.	DESCRIPTION	QTY.	MODELS
101-149S	203787	Screw and Washer Assembly, Body Flange Attaching..	4	F486
101-152S	203817	Screw and Washer Assembly, Air Horn Attaching.....	4	F486
101-155S	203788	Screw and Washer Assembly, Pump Jet Attaching.....	2	F486
101-160S	203818	Screw and Washer Assembly, Bowl Cover Attaching...	6	F486
101-161S	203789	Screw and Washer Assembly, Dust Cover Attaching...	2	F486
101-236	203790	Screw, Metering Rod Arm Clamp.....	1	F486
105A-10	203791	Nut, Choke Lever Clamp.....	1	F486
111-51S	203792	Arm Assembly, Pump and Metering Rod.....	1	F486
114-45	203793	Dog, Throttle Lever.....	1	F486
115-70	203794	Connector Rod, Fast Idle.....	1	F486
115-77	203819	Connector Rod, Throttle.....	1	F486
117-28	203795	Link, Pump.....	1	F486
117-83	203796	Link, Vacuum Piston.....	1	F486
118-39	203797	Dust Cover.....	1	F486
120-125S	203798	Jet and Gasket Assembly, Metering Rod.....	2	F486
121-78	203821	Gasket, Coil Housing.....	1	F486
121-79	203799	Gasket, Body Flange.....	1	F486
121-80	203800	Gasket, Air Horn.....	1	F486
121-81	203801	Gasket, Bowl Cover.....	1	F486
122-81	203802	Plug, Pump Discharge Check.....	1	F486
122-85S	203803	Disc Check Assembly, Intake.....	1	F486
136-37	203804	Washer, Connector Rod.....	1	F486
136-38	203805	Washer, Throttle Shaft Dog.....	1	F486
136-129	203820	Washer, Choke Shaft.....	2	F486
146-171S	203806	Cover Assembly, Bowl.....	1	F486
150-62	201661	Pin, Piston.....	1	F486
150-150	203822	Pin, Intake Needle.....	1	F486
150A-10	201687	Pin Spring.....	3	F486
160-35	201660	Piston, Choke.....	1	F486
160-67S	201714	Piston and Pin Assembly, Vacuum.....	1	F486
170P-62S	203807	Housing and Coil Assembly, Thermostatic.....	1	F486
181-144S	203808	Cam Assembly, Fast Idle.....	1	F486
186-15	203809	Baffle Plate, Climatic Control.....	1	F486
196-15	203810	Guide, Pump Plunger.....	1	F486

Note: The following parts not illustrated.

	203448	Stud, Carb. Mounting, 5/16"-18 x 5/16" - 24 x 1/2"	4	F486
	240	Lockwasher, Carb. Mounting, 5/16" Med.....	4	F486
	189	Nut, Carb. Mounting, 5/16"-24 Hx.....	4	F486
	203355	Gasket (to Manifold).....	1	F486
189	203849	Gasket Assortment.....	1	F486
1390	203850	Repair Kit.....	1	F486

## FUEL

FIGURE NUMBER	GROUP	PART NAME and DESCRIPTION	PART NUMBER	QTY.	MODELS
3.000 - INTAKE MANIFOLD					
3-1-3		Manifold.....	200274	1	All
		Manifold (Dual Type).....	203351	1	F486
3-1-1		Stud (to Block) 3/8" - 16 x 3/8" - 16 x 2".....	200275	8	All
		Stud (to Block) (Dual Manifold).....	203611	8	F486
3-1-4		Stud (to Exhaust Manifold) (Dual Manifold).....	200276	4	All
		Stud (to Exhaust Manifold) (Dual Manifold).....	203448	4	F486
3-1-6		Retainer.....	200277	8	All
		Retainer (Dual Manifold).....	203352	8	F486
5-1-11		Flatwasher (to Exhaust Manifold).....	200059	4	All
3-1-5		Nut, 3/8" - 16 Hx.....	200278	12	All
		Nut (to Exhaust Manifold) (Dual Manifold).....	203353	4	F486
3-1-2		Gasket (to Block).....	200279	1	All
		Gasket (to Exhaust Manifold).....	200319	1	All
		Gasket (to Exhaust Manifold) (Dual Manifold).....	203376	1	F486
3.010 - CARBURETOR CHOKE TUBE					
		Tube (Engine with Exhaust Outlet at front)	200795	1	F47, K100
		Tube (Engine with Exhaust Outlet at rear).	202413	1	All
		Tube (incl. Insulation and Nuts) (Dual Manifold).....	203356	1	F486
		Tube (R.H.D.).....	203733	1	F485, K481
		Sleeve, 1/4" Tube.....	202130	1	All
		Nut, 7/16" - 24 Hx. x 1/4" Tube.....	202131	1	All
3.020 - CARBURETOR CHOKE CONTROL (USED WITH MODEL W1-574S CARBURETOR)					
19-1-21		Control.....	203046	1	F47, F47C
		Control.....	203047	1	K100
		Lockwasher, 3/8" Ext. Tooth.....	291	1	F47, F47C, K100
		Nut, 3/8" - 24 Hx. ....	290	1	F47, F47C, K100
		Knob and Wire.....	203048	1	F47, F47C
		Knob and Wire.....	203049	1	K100
		Grommet (Through Dash).....	200499	1	F47, F47C, K100
3.030 - CARBURETOR CHOKE CONTROL BRACKET (USED WITH MODEL W1-574S CARBURETOR)					
		Bracket (Chrome).....	203050	1	F47, F47C, K100
		Screw, No. 10 - 32 x 3/8" Rd. Hd. Sl. ..	283	2	F47, F47C, K100
		Lockwasher, No. 10 Ext. Tooth.....	294	2	F47, F47C, K100
		Nut, No. 10 - 32 Hx. ....	202	2	F47, F47C, K100
3.040 - THROTTLE CONTROL					
3-2-1		Control, up to Serial F47-9514.....	200496	1	F47
3-2-1		Control, after Serial F47-9514.....	202585	1	F47, F47C, F485, F486
		Control, up to Serial K100-17455.....	201542	1	K100
3-2-1		Control, after Serial K100-17455.....	202586	1	K100, K101, K481, K482

FIGURE NUMBER	GROUP	PART NAME and DESCRIPTION	PART NUMBER	QTY.	MODELS
3.040 - THROTTLE CONTROL (CONT'D.)					
		Control (Dual Manifold).....	203446	1	F486
3-2-3		Lockwasher, 3/8" Ext. Tooth.....	291	1	All
3-2-2		Nut, 3/8" - 24 Hx. Lt. ....	290	1	All
		Clip (to Cross Shaft Lever) (Dual Manifold).....	203447	1	F486
3-2-19		Grommet (Through Dash).....	200499	1	All
3.050 - THROTTLE CONTROL SUPPORT					
3-2-18		Support.....	200498	1	All
		Screw, No. 10 - 12 x 3/8" Rd. Hd. Sl. ..	311	1	All
		Screw, No. 10 - 32 x 3/8" Rd. Hd. Sl.....	283	1	All
		Lockwasher, No. 10			
		Ext. Tooth.....	294	1	All
		Nut, No. 10 - 32 Hx. ....	202	1	All
3.060 - THROTTLE CONTROL LEVER					
		Lever, up to Serial F47-9514, K100-17455..	200500	1	F47, K100
3-2-35		Lever, after Serial F47-9514, K100-17455..	201910	1	All
3-2-34		Spring, Lever Return.....	201920	1	All
3-2-36		Lever, Adjusting.....	201922	1	All
3-2-31		Screw, Adjusting, No. 10 - 32 x 5/8" Hx. Hd. ....	450	1	All
3-2-30		Nut, No. 10 - 32 Hx. ....	202	1	All
		Lever (on Accel. Cross Shaft) (Dual Manifold).....	203365	1	F486
		Bolt, 1/4" - 28 x 1 1/4" Hx. Hd. ....	634	1	F486
		Lockwasher, 1/4".....	243	2	F486
		Nut, 1/4" - 28 Hx. ....	261	1	F486
3.070 - ACCELERATOR PEDAL					
3-2-20		Pedal.....	201907	1	All
		Pivot.....	200473	2	F47, K100
		Lockwasher			
		5/16" Med. ..	240	2	F47, K100
3-2-21		Bracket, after Serial F47-9514, K100- 17455.....	203307	1	All
		Boot, up to Serial F47-9514, K100-17455...	200474	1	F47, K100
		Retainer.....	200475	1	F47, K100
		Screw, No. 10 - 32 x 7/16" Rd. Hd. Sl. .	283	1	F47, K100
		Lockwasher, No. 10 Int. Tooth.....	259	1	F47, K100
		Nut, No. 10 - 32 Hx. ....	202	1	F47, K100
3-2-23		Bolt, after Serial F47-9514, K100-17455...	201908	1	All
3.080 - ACCELERATOR PEDAL TO BELL CRANK ROD					
		Rod, up to Serial F47-9514, K100-17455....	200476	1	F47, K100
		Flatwasher, No. 10 Sm. ....	248	2	F47, K100
		Clevis Pin, 3/16" x 21/32".....	200477	1	F47, K100
		Cotter Pin, 1/16" x 7/16".....	255	1	F47, K100
3-2-22		Rod, after Serial F47-9514, K100-17455....	202327	1	All
		Flatwasher, 3/8" Sm. ....	247	1	All

FIGURE NUMBER	GROUP	PART NAME and DESCRIPTION	PART NUMBER	QTY.	MODELS
3.080 - ACCELERATOR PEDAL TO BELL CRANK ROD (CONT'D.)					
		Cotterpin, 3/32" x 5/8".....	139	1	All
		Rod (R.H.D. and Dual Manifold).....	203357	1	F485, F486, K481
		Clip.....	203445	1	F485, F486, K481
3.090 - ACCELERATOR BELL CRANK - LOWER					
3-2-27		Bell Crank, up to Serial F47-9514, K100-17455.....	200478	1	F47, K100
		Flatwasher, 3/8" Sm. ....	247	1	F47, K100
		Clevis Pin, 31/32" Long.....	200479	1	F47, K100
		Cotter Pin, 3/32" x 3/4".....	139	1	F47, K100
		Bell Crank, after Serial F47-9514, K100-17455.....	202328	1	All
3-2-28		Clevis Pin, 5/16" x 31/32".....	416	1	All
		Cotter Pin, 3/32" x 3/4".....	139	1	All
		Bell Crank (R.H.D.).....	203593	1	F485, K481
		Bell Crank (Dual Manifold).....	203358	1	F486
3-2-28		Clevis Pin, 5/16" x 31/32".....	416	1	F485, F486, K481
		Cotter Pin, 3/32" x 1/2".....	414	1	F485, F486, K481
		Bracket, Lower, up to Serial F47-9514, K100-17455.....	200480	1	F47, K100
		Bolt, 1/4" - 20 x 7/16" Rd. Hd. Sl. ....	250	2	F47, K100
		Lockwasher, 1/4" Med. ....	190	2	F47, K100
		Nut, 1/4" - 20 Hx. ....	203	2	F47, K100
3.400 - ACCELERATOR LINKAGE TENSION SPRING					
		Spring, up to Serial F47-9514, K100-17455. ....	200492	1	F47, K100
		Clip.....	200493	1	F47, K100
		Screw, No. 10 - 32 x 7/16" Rd. Hd. Sl. .	283	1	F47, K100
		Lockwasher, No. 10 Int. Tooth.....	259	1	F47, K100
		Nut, No. 10 - 32 Hx. ....	202	1	F47, K100
3-2-26		Spring, after Serial F47-9514, K100-17455. ....	201902	1	All
3.410 - ACCELERATOR BELL CRANK LINK ROD					
		Rod, up to Serial F47-9514, K100-17455....	200486	1	F47, K100
		Clip.....	200485	2	F47, K100
3-2-29		Rod, after Serial F47-9514, K100-17455....	202584	1	All
3-2-32		Clip, Right.....	200485	1	All
3-2-5		Clip, Left.....	201919	1	All
		Rod (R.H.D.).....	203594	1	F485, K481
		Clip.....	203445	2	F485, K481
		Rod (Dual Manifold).....	203360	1	F486
		Clip, Lower.....	200484	1	F486
		Clip, Upper.....	203445	1	F486
3-2-33		Lever, after Serial F47-9514, K100-17455..	202390	1	All
		Lever (WO/OD) (R.H.D. and Dual Manifold).....	203365	1	F485, F486, K481
		Lever (W/OD) (Dual Manifold).....	203359	1	F486
		Bolt, 1/4" - 28 x 1 1/4" Hx. Hd. ....	634	1	F485, F486, K481
		Lockwasher, 1/4".....	243	2	F485, F486, K481
		Nut, 1/4" - 28 Hx. ....	261	1	F485, F486, K481



FIGURE NUMBER	GROUP	PART NAME and DESCRIPTION	PART NUMBER	QTY.	MODELS
<b>3.420 - ACCELERATOR BELL CRANK - UPPER</b>					
		Bell Crank, up to Serial F47-9514, K100-17455.....	200481	1	F47, K100
3-2-24		Flatwasher, 3/8" Sm. ....	247	1	F47, K100
3-2-25		Cotter Pin, 3/32" x 3/4".....	139	1	F47, K100
		Pivot, up to Serial F47-9514, K100-17455..	200482	1	F47, K100
		Lockwasher, 3/8" Med. ....	192	1	F47, K100
<b>3.430 - ACCELERATOR CROSS SHAFT</b>					
		Rod, up to Serial F47-9514, K100-17455....	200483	1	F47, K100
		Rod, 8 3/16" Long, 1/4" Diam. ....	202227	1	F47, K100
		Rod, 10 3/16" Long, 1/4" Diam. ....	202228	1	F47, K100
		Adjusting Nut.....	202229	1	F47, K100
		Nut (Long Rod) 1/4" - 20 Hx. Lt. ....	203	1	F47, K100
		Nut, L.H. Thr. (Short Rod) 1/4" - 20.....	202318	1	F47, K100
NOTE: The above five items may be used to replace the solid Rod Part No. 200483.					
		Clip.....	200484	2	F47, K100
		Rod, 7 3/4" Long, 3/16" Diam. ....	202230	1	F47, K100
		Rod, 10 3/4" Long, 3/16" Diam. ....	202231	1	F47, K100
3-2-17		Rod, 5 1/4" Long, 3/16" Diam. ....	202778	1	All
3-2-6		Rod, 13 1/4" Long, 3/16" Diam. ....	202779	1	All
3-2-16		Adjusting Nut.....	202232	1	All
		Nut, No. 10 - 32 Hx. (Long Rod).....	202	1	All
		Nut, L.H. Thr. (Short Rod).....	202492	1	All
		Clip.....	200485	1	All
		Clip (at Kick Down Switch).....	201909	1	All
		Shaft (R.H.D.).....	203595	1	F485, K481
		Shaft (Dual Manifold).....	203361	1	F486
		Bearing (R.H.D. and Dual Manifold).....	203362	2	F485, F486, K481
		Bracket (less Bearing (R.H.D. and Dual Manifold).....	203363	2	F485, F486, K481
		Bolt, 1/4" - 20 x 1/2" Hx. Hd. ....	179	4	F485, F486, K481
		Lockwasher, 1/4" Med. ....	190	4	F485, F486, K481
		Lever, Overdrive Kick Down Switch (R.H.D.)	203569	1	F485, K481
		Bolt, 1/4" - 28 x 1 1/4" Hx. Hd. ....	634	1	F485, K481
		Lockwasher 1/4".....	243	1	F485, K481
		Nut, 1/4" - 28 Hx. ....	261	1	F485, K481
<b>3.440 - ACCELERATOR CROSS SHAFT TO CARBURETOR EXTENSION SHAFT LEVER</b>					
3-2-7		Lever (WO/OD).....	202015	1	All
		Screw, No. 8 - 32 x 7/16" Hd'ls. Sl. Cup Point.....	468	1	All
		Screw, No. 10 - 32 x 1/2" Rd. Hd. Sl. ..	633	1	All
		Lever (W/OD)....{ up to Serial F47-9514 }....	201631	1	F47
		Spring (W/OD)....{ up to Serial F47-9514 }....	201632	1	F47
3-2-12		Lever (W/OD).....	201918	1	F47, F485, F47C, F486
3-2-4		Set Screw, No. 8 - 32 x 7/16" Hd'ls Sl. Cup Pt. ....	468	1	F47, F485, F47C, F486
		Screw, No. 8 - 32 x 1/2" Rd. Hd. Sl. ....	633	1	F47, F485, F47C, F486

FIGURE NUMBER	GROUP	PART NAME and DESCRIPTION	PART NUMBER	QTY.	MODELS
3.440 - ACCELERATOR CROSS SHAFT TO CARBURETOR EXTENSION SHAFT LEVER (CONT'D.)					
3-2-11		Lever.....{after Serial F47-9514}.....	201916	1	F47, F485, F47C, F486
3-2-8		Spring.....{after Serial F47-9514}.....	201917	1	F47, F485, F47C, F486
		Lever (R.H.D. and Dual Manifold).....	203365	1	F485, F486, K481
		Bolt, 1/4" - 28 x 1 1/4" Hx. Hd. ....	634	1	F485, F486, K481
		Lockwasher, 1/4".....	243	2	F485, F486, K481
		Nut, 1/4" - 28 Hx. ....	261	1	F485, F486, K481
3.450 - CARBURETOR EXTENSION SHAFT					
		Shaft (WO/OD) up to Serial F47-9514, K100-17455.....	200487	1	F47, K100
		Spring.....	200488	1	F47, K100
		Flatwasher, 7/16" x 15/32" x 3/64".....	201366	1	F47, K100
		Cotter Pin, 3/32" x 3/4".....	139	1	F47, K100
		Shaft (W/OD) up to Serial F47-9514, Support, up to Serial F47-9514, K100- 17455.....	200489	1	F47, K100
		Screw, No. 10 - 16 x 3/8" Bind. Hd. ....	249	2	F47, K100
		Lockwasher, No. 10 Med. ....	254	2	F47, K100
3-2-9		Grommet.....	202554	1	All
3-2-10		Bushing.....	202590	1	All
3-2-13		Shaft, after Serial F47-9514, K100-17455..	201900	1	All
3-2-15		Cotter Pin, 1/16" x 7/16".....	452	1	All
		Shaft (incl. Ball and Stud) (R.H.D.).....	203597	1	F485, K481
		Lockwasher, 1/4".....	410	1	F485, K481
		Nut, 1/4" - 28 Hx. ....	261	1	F485, K481
		Rod, Ball Joint Shaft (R.H.D.).....	203598	1	F485, K481
		Jam Nut, 1/4" - 28.....	649	1	F485, K481
		Clip (to Bell Crank).....	203445	1	F485, K481
		Bell Crank (R.H.D.).....	203599	1	F485, K481
		Flatwasher, 3/8" Sm. ....	247	1	F485, K481
		Cotter Pin, 3/32" x 3/4".....	139	1	F485, K481
		Bracket (incl. Pivot) (R.H.D.).....	203600	1	F485, K481
		Bolt, 1/4" - 20 x 3/8" Hx. Hd. ....	471	2	F485, K481
		Lockwasher, 1/4" Med. ....	190	2	F485, K481
		Rod, Bell Crank to Carburetor (R.H.D.)....	203601	1	F485, K481
		Flatwasher, 1/4" Sm. ....	243	1	F485, K481
		Cotter Pin, 1/16" x 7/16".....	452	2	F485, K481
		Swivel (R.H.D.).....	203602	1	F485, K481
		Locknut, 1/4" - 28.....	635	1	F486, K481
		Spring (R.H.D.).....	203368	1	F486, K481
		Shaft (Dual Manifold).....	203366	1	F486
		Clip.....	200484	1	F486
		Swivel (Dual Manifold).....	203367	1	F486
		Lock Nut, 1/4" - 28 Hx. ....	635	1	F486
		Spring (Dual Manifold).....	203368	1	F486
		Flatwasher, 1/4" Sm. ....	243	1	F486
		Cotter Pin, 1/16" x 7/16".....	452	1	F486
3.460 - CARBURETOR EXTENSION SHAFT CONNECTOR					
		Connector.....{up to Serial F47-9514}.....	200491	1	F47, K100
		Coupling.....{K100-17455}.....	201368	1	F47, K100
		Clevis Pin.....	201367	1	F47, K100

FIGURE NUMBER	GROUP	PART NAME and DESCRIPTION	PART NUMBER	QTY.	MODELS
<b>3.460 - CARBURETOR EXTENSION SHAFT CONNECTOR (CONT'D)</b>					
3-2-14		Retainer.....	203746	1	F47, K100
		Connector, after Serial F47-9514, K100-17455.....	201901	1	All
		Screw, No. 8 - 32 x 5/16" Rd. Hd. Sl. ..	251	2	All
		Lockwasher, No. 8 Med. ....	253	2	All
		Connector (used with Manuel Choke Carburetor).....	203044	1	F47, F47C, K100
		Bolt, 1/4" - 28 x 1/2" Hx. Hd. ....	276	1	F47, F47C, K100
		Locknut, 1/4" - 28.....	203045	1	F47, F47C, K100
		Connector (R.H.D.).....	203603	1	F485, K481
		Screw, No. 8 - 32 x 5/16" Rd. Hd. Sl. ..	251	2	F485, K481
		Lockwasher, No. 8 Med. ....	253	2	F485, K481
		Connector (Dual Manifold).....	203369	1	F486
		Screw, No. 10 - 32 x 3/8" Rd. Hd. Sl. ..	283	2	F486
		Lockwasher, No. 10 Med. ....	254	2	F486
<b>3.470 - FUEL PUMP</b>					
1-1-63		Pump (Engines with Fuel Pump at rear).....	200281	1	F47, K100
		Pump (Engines with Fuel Pump at front)....	201509	1	F47, F47C, K100
		Pump, Fuel and Vacuum.....	202319	1	All
		Stud (used with 200281 Pump) 5/16" - 18 x 1 1/4".....	200127	2	F47, K100
		Stud, 5/16" - 18 x 1 3/4".....	202010	2	All
		Lockwasher, 5/16" Hy. ....	191	2	All
		Nut, 5/16" - 18 Hx. ....	205	2	All
1-1-62		Gasket (Pump to Block).....	200283	1	All
<b>3.480 - FUEL PUMP REPAIR KIT</b>					
3-3-1		Repair Kit (use for 200281 Pump).....	201782	*	F47, K100
		Repair Kit (use for 201509 Pump).....	201784	*	F47, F47C, K100
3-4-2		Repair Kit (use for 202319 Pump).....	202877	*	All
<b>3.490 - FUEL PUMP BOWL</b>					
3-3-3		Bowl (used on 200281 Pump).....	200294	1	F47, K100
3-4-4		Bowl (used on 201509 and 202319 Pumps)....	201577	1	All
3-3-4		Gasket (used on 200294 Bowl).....	200295	1	F47, K100
3-4-5		Gasket (used on 201577 Bowl).....	201578	1	All
3-3-5		Screen (used on 200281 Pump).....	200296	1	F47, K100
3-4-6		Screen (used on 201509 and 202319 Pumps)..	201579	1	All
3-3-2		Bail (incl. Screw, Nut and Seat) (used on 200281 Pump).....	203259	1	F47, K100
3-4-3		Bail (incl. Screw, Nut and Seat) (used on 201579 and 202319 Pumps).....	203260	1	All
<b>3.500 - FUEL PUMP DIAPHRAGM KIT</b>					
3-3-6		Diaphragm Kit (use for 200281 Pump).....	201783	*	F47, K100
		Diaphragm Kit (Export) (For use with Alcohol Base Fuel) (Use for 200281 Pump)	203344	*	F47, K100

\*As required

FIGURE NUMBER	GROUP	PART NAME and DESCRIPTION	PART NUMBER	QTY.	MODELS
3.500 - FUEL PUMP DIAPHRAGM KIT (CON'T.)					
3-4-7		Diaphragm Kit (use for 201509 and Fuel Side of 202319 Pump).....	201785	* All	
3-4-1		Diaphragm Kit (use for Vacuum Side of 202319 Pump).....	202876	* All	
		Diaphragm Kit (Export) (use with Alcohol Base Fuel) (use for 201509 and Fuel Side of 202319 Pump).....	203345	* All	
3.510 - FUEL PUMP HEAT SHIELD					
		Shield (use with 200281 Pump).....	201375	1	F47, K100
		Stud, No. 10 - 32.....	201591	3	F47, K100
		Lockwasher, No. 10 Ext. Tooth.....	294	3	F47, K100
		Nut, No. 10 - 32 Hx. ....	202	3	F47, K100
3.520 - FUEL TANK					
		Tank, up to Serial F47-1300, K100-1312....	201374	1	F47, K100
		Tank, after Serial F47-1300, K100-1312....	200457	1	All
		Bolt, 3/8" - 24 x 1 1/4".....	200446	2	F47, K100
		Bolt, 3/8" - 24 x 1" Hx. Hd. ....	327	1	F47, K100
		Flatwasher, 3/8" Sm. ....	247	1	F47, K100
		Spacer.....	200458	2	F47, K100
		Locknut.....	202257	3	F47, K100
		Anti-Squeak.....	200459	1	F47, K100
		Bolt.....	200446	3	All
		Spacer.....	200458	3	All
		Locknut, 3/8" - 24 Hx. ....	202257	3	All
		Plug, Drain, 1/4" Pipe Hx. Hd. ....	256	1	All
		Cap.....	200460	1	All
3.530 - FUEL TANK FILLER TUBE					
		Tube (incl. Clamp).....	200461	1	All
		Bolt, 1/4" - 28 x 7/8" Hx. Hd. ....	303	1	All
		Lockwasher, 1/4" Med. ....	190	1	All
		Nut, 1/4" - 28 Hx. ....	261	1	All
		Insulator, up to Serial F47-1346, K100-1345.....	200570	1	F47, K100
		Insulator, after Serial F47-1346, K100-1345.....	201924	1	All
		Hose, 2 1/4" x 3".....	200462	1	All
		Clamp, 2 5/8".....	202129	2	All
3.540 - FUEL TANK FILLER TUBE CAP COVER (IN REAR FENDER)					
		Cover (incl. Hinge and Spring).....	200566	1	All
		Bolt, 1/4" - 20 x 3/8" Rd. Hd. Cr. Rec..	474	2	All
		Lockwasher, 1/4" Ext. Tooth.....	370	2	All
		Nut, 1/4" - 20 Hx. ....	203	2	All
		Spring.....	200567	1	All
		Bumper.....	200568	2	All

FIGURE NUMBER	GROUP	PART NAME and DESCRIPTION	PART NUMBER	QTY.	MODELS
3.550 - FUEL TANK TO FUEL PUMP LINE					
		Tube (Engines with Fuel Pump at rear of Block).....	200463	1	F47, K100
		Tube (Engines with Fuel Pump at front of Block).....	201874	1	All
		Nut, 1/2" - 20 Hx. x 5/16" Inv. ....	202133	2	All
		Clip, 5/16" Tube.....	201544	8	All
		Fitting (on Frame).....	200464	1	All
		Bolt, 5/16" - 12 x 5/8" Hx. Hd. ....	284	1	All
		Lockwasher, 5/16" Med. ....	240	1	All
		Tube, Fitting to Fuel Pump (Flexible).....	200465	1	All
3.560 - PUMP TO CARBURETOR FUEL LINE					
		Tube (Engine with Fuel Pump at rear of Block).....	200466	1	F47, K100
		Elbow (Pump Outlet) 1/2" - 20 x 1/8" Pipe 45° x 5/16" Inv. Fl. Tube.....	202137	1	F47, K100
		Elbow (Carburetor Inlet) (1/2" - 20 x 1/8" Pipe 90° x 5/16".....	202132	1	F47, K100
		Tube (use with Fuel Pump 201509).....	202388	1	All
		Elbow (Pump Outlet, Carburetor Inlet)...	202132	1	All
		Nut, 1/2" - 20 Hx. x 5/16" Inv. Fl. Tube.....	202133	2	All
		Tube (incl. Nuts) (use with Fuel Pump 202319).....	202878	1	All
		Tube (incl. Nuts) (use with Fuel Pump 202319) (Dual Manifold).....	203370	1	F486
		Elbow (Pump Outlet) (1/2" - 20 x 1/8" Pipe 45° x 5/16" Inv. Fl. Tube.....	202137	1	All
		Connector (Carburetor Inlet) 1/2" - 20 x 1/8" Pipe 5/16" Inv. Fl. Tube....	202880	1	All
		Tube (incl. Nuts) Vacuum Pump to Manifold.	202879	1	All
		Tube (incl. Nuts) Vacuum Pump to Manifold (Dual Manifold).....	203371	1	F486
		Elbow (Pump Outlet) 7/16" - 24 x 1/8" Pipe 90° 1/4" Inv. Fl. Tube.....	202123	1	All
		Connector (Manifold Outlet) 7/16" - 24 x 1/8" Pipe 1/4" Inv. Fl. Tube.....	202125	1	All
		Tube (incl. Nut) to Windshield Wiper Tube (Dual Manifold).....	203568	1	F486
		Tube (incl. Nut) to Windshield Wiper Tube. Connector, 7/16" - 24 x 1/8" Pipe 1/4" Inv. Fl. Tube. ....	203056	1	All
			202125	1	All
3.570 - FUEL GAUGE - DASH UNIT					
		Gauge.....	200471	1	F47, F485, F47C, F486
		Gauge (Green).....	201545	1	K100,
		Gauge (Sandtone Beige).....	202786	1	K100, K101, K481, K482
		Screw, No. 8 - 32 x 1/4" Rd. Hd. Sl. ...	310	2	F47, F485, F47C, F486
		Screw, No. 8 - 32 x 1/4" Fil. Hd. Sl. ..	357	2	K100, K481, K101, K482
		Gasket.....	201379	1	F47, F485, F47C, F486
		Gauge (R.H.D.).....	203491	1	F485
		Gauge (R.H.D.).....	203492	1	K481
		Nut (Terminal) No. 10 - 32 Hx. ....	202	2	All
		Lockwasher, No. 10 Int. Tooth.....	259	2	All

FIGURE NUMBER	GROUP	PART NAME and DESCRIPTION	PART NUMBER	QTY.	MODELS			
3.580 - FUEL GAUGE - TANK UNIT								
		Gauge.....	200468	1	F47, F485, F47C, F486			
		Gauge (L.H.D. and R.H.D.).....	201546	1	F485, K100, K481, K101, K482			
		Screw, No. 10 - 32 x 7/16" Rd. Hd. Cr.						
		Rec. ....	539	6	All			
		Flatwasher, No. 10.....	200469	6	All			
		Screw, No. 8 - 32 x						
		1/4" Rd. Hd. Sl. ....	} Terminal	}	}			
		Lockwasher, No. 8 Int. ....				310	1	All
		Tooth.....				273	1	All
		Nut, No. 8 - 32 Hx. ....				272	1	All
		Gasket.....				200470	1	All

## 3.590 - FUEL GAUGE COVER

		Cover (in Rear Floor Pan).....	200544	1	All
		Screw, No. 14 - 10 x 1/2" Rd. Hd. Sl. ..	383	2	All
		Gasket, up to Serial F47-28864, F47C-1,016,709, K100-44903.....	202415	1	F47, F47C, K100
		Gasket, after Serial F47-28864, F47C-1,016,709, K100-44903.....	202709	1	All
		Filler (Rubber).....	202414	1	All