

FIGURE 5-1—EXHAUST MANIFOLD - EXPLODED VIEW

Key	Part Name	Group	Key	Part Name	Group
1	Stud.....	5.000	13	Bushing, Heat Control.....	5.010
2	Gasket (To Block).....	5.000	14	Shield, Heat Control.....	5.010
3	Stud.....	5.000	15	Thermostat, Heat Control.....	5.010
4	Retainer.....	5.000	16	Cover, Heat Control.....	5.015
5	Nut.....	5.000	17	Screw, Counterweight.....	5.020
6	Manifold (with Outlet at Front).....	5.000	18	Counterweight, Heat Control Valve.....	5.020
7	Gasket (To Exhaust Manifold).....	5.000	19	Key, Counterweight.....	5.020
8	Flatwasher (Center).....	5.000	20	Nut, Counterweight Screw.....	5.020
9	Flatwasher (Ends).....	5.000	21	Bolt, Cover.....	5.015
10	Manifold (with Outlet at Rear).....	5.000	22	Lockwasher, Cover Bolt.....	5.015
11	Flatwasher (To Intake Manifold).....	3.000	23	Spacer, Cover.....	5.015
12	Shaft, Heat Control.....	5.010	24	Valve, Heat Control.....	5.010

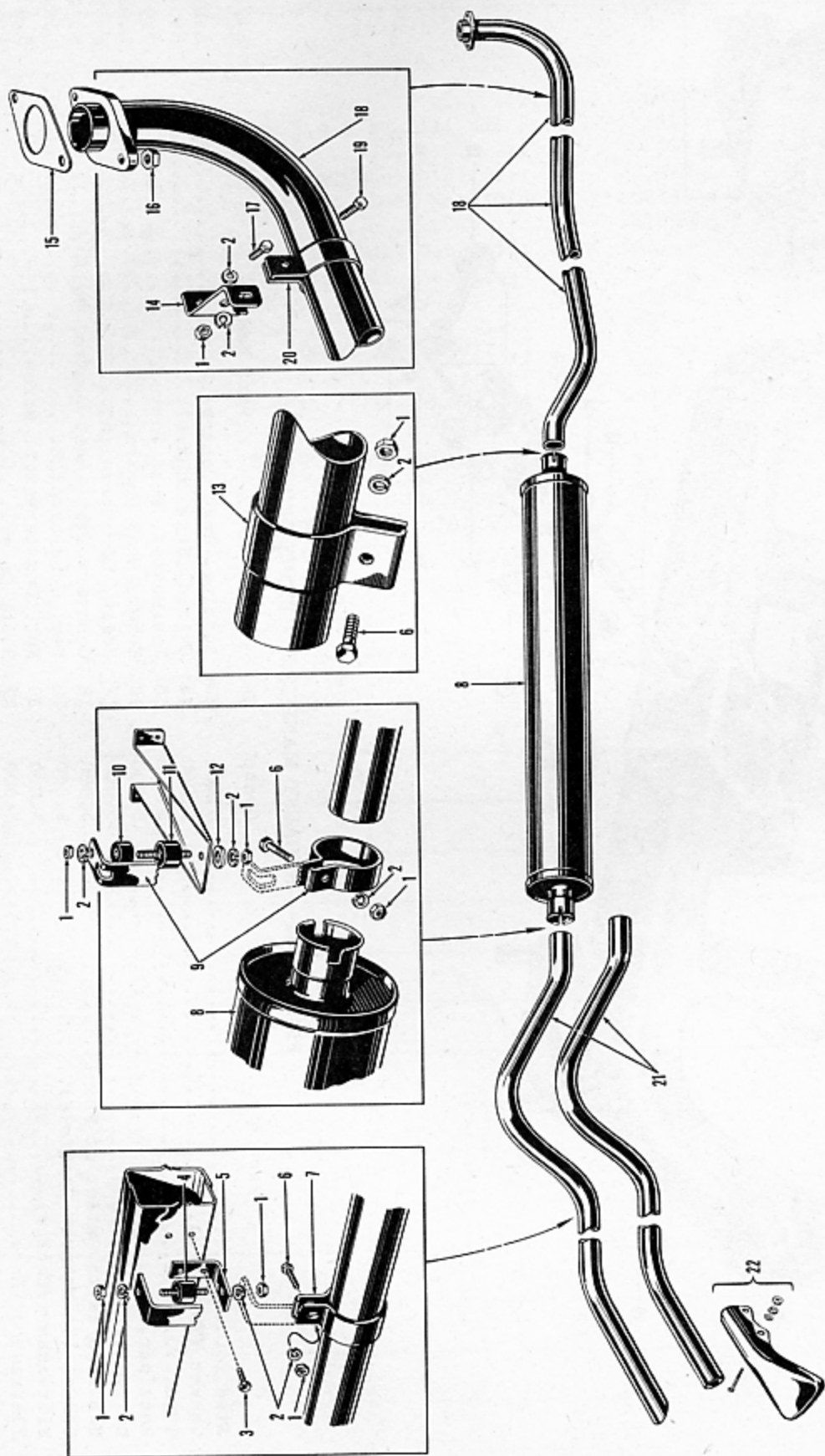

FIGURE 5-2—EXHAUST SYSTEM - EXPLODED VIEW

FIGURE 5-2—EXHAUST SYSTEM - EXPLODED VIEW

Key	Part Name	Group	Key	Part Name	Group
1	Nut.....	5.050	13	Clamp, Exhaust Pipe to Muffler.....	5.050
2	Lockwasher.....	5.050	14	Hanger, Exhaust Pipe.....	5.050
3	Bolt.....	5.060	15	Gasket, Exhaust Pipe.....	5.040
4	Insulator, Tail Pipe Clamp.....	5.070	16	Nut.....	5.040
5	Bracket, Tail Pipe.....	5.070	17	Bolt.....	5.050
6	Bolt.....	5.055	18	Pipe, Exhaust.....	5.040
7	Clamp, Tail Pipe.....	5.070	19	Bolt.....	5.050
8	Muffler, Exhaust.....	5.055	20	Clamp, Exhaust Pipe Hanger.....	5.050
9	Clamp, Tail Pipe to Muffler.....	5.060	21	Pipe, Tail.....	5.070
10	Spacer, Insulator.....	5.060	22	Deflector, Tail Pipe Exhaust.....	5.070
11	Insulator, Tail Pipe to Muffler Clamp.....	5.060			

FIGURE NUMBER	GROUP	PART NAME and DESCRIPTION	PART NUMBER	QTY.	MODELS
5.000 - EXHAUST MANIFOLD (INCL. HEAT VALVE)					
5-1-6		Manifold, With Outlet at front.....	200310	1	F47, K100
5-1-10		Manifold, With Outlet at rear.....	201965	1	All
		Manifold, Used with Dual Intake Manifold..	203374	1	F486
5-1-3		Stud (to Block).....	200275	8	All
		Stud (to Block) (Dual Manifold).....	203611	8	All
5-1-1		Stud (Ends and Center).....	200312	3	All
		Stud (Ends) (Dual Manifold).....	200312	2	F486
		Stud (Center) (Dual Manifold).....	203375	1	F486
5-1-4		Retainer.....	200277	8	All
		Retainer (Dual Manifold).....	203352	8	F486
5-1-9		Flatwasher (Ends).....	200314	2	All
5-1-8		Flatwasher (Center).....	200315	1	All
5-1-5		Nut.....	200278	11	All
5-1-2		Gasket (to Block).....	200279	1	All
5-1-7		Gasket (to Exhaust Manifold).....	200319	1	All
		Gasket (to Exhaust Manifold) (Dual Manifold).....	203376	1	F486
5.010 - EXHAUST MANIFOLD HEAT CONTROL					
5-1-24		Valve.....	200324	1	All
		Valve (Dual Manifold).....	203377	1	F486
5-1-12		Shaft.....	200325	1	All
		Shaft (Dual Manifold).....	203378	1	F486
5-1-13		Bushing.....	200326	2	All
5-1-15		Thermostat.....	200327	1	All
5-1-14		Shield.....	200328	1	All
5.015 - EXHAUST MANIFOLD HEAT CONTROL COVER					
5-1-16		Cover.....	200329	1	All
5-1-23		Spacer.....	200330	1	All
5-1-21		Bolt, 1/4" - .20 x 1" Hx. Hd. ....	207	1	All
5-1-22		Lockwasher, 1/4" Med. ....	190	1	All
		Stop Pin.....	200331	1	All
5.020 - EXHAUST MANIFOLD HEAT CONTROL VALVE COUNTERWEIGHT					
5-1-18		Counterweight.....	200332	1	All
		Counterweight (Dual Manifold).....	203379	1	F486
5-1-19		Key.....	200333	1	All
5-1-17		Screw, No. 10 - 32 x 3/4" Fil. Hd. Sl. .	164	1	All
5-1-20		Nut, No. 10 - 32 Hx. ....	202	1	All
5.040 - EXHAUST PIPE					
		Pipe, Front Outlet Manifold.....	200211	1	F47, K100
		Nut, 3/8" - 16 Hx. ....	200278	2	F47, K100
		Gasket.....	200323	3	F47, K100
		Flange, Front Outlet Manifold.....	200320	1	F47, K100
		Stud, 3/8" - 16 x 3/8" - 16 x 2 1/8"....	201970	2	F47, K100
5-2-18		Pipe, Rear Outlet Manifold.....	201547	1	All
		Pipe (R.H.D.).....	203559	1	F485, K481
		Pipe (Dual Manifold).....	203380	1	F486

## EXHAUST

5

FIGURE NUMBER	GROUP	PART NAME and DESCRIPTION	PART NUMBER	QTY.	MODELS
5.040 - EXHAUST PIPE (CONT'D.)					
		Stud, 7/16" - 14 x 7/16 x 14 x 1 5/8"...	201855	2	All
5-2-16		Nut, 7/16" - 14 Hx. ....	426	2	All
5-2-15		Gasket.....	201852	1	All
5.050 - EXHAUST PIPE HANGER					
		Hanger, Front Outlet			
		Manifold.....	201377	1	F47, K100
5-2-14		Hanger, Rear Outlet			
		Manifold.....	202782	1	All
		Hanger (R.H.D.).....	203560	1	F485, K481
		Hanger (Dual Manifold)....	203381	1	F486
5-2-17		Bolt, 5/16" - 18 x 5/8" Hx. Hd. ....	208	2	All
		Lockwasher, 5/16" Med. ....	240	2	All
5-2-20		Clamp.....	200438	1	All
5-2-19		Bolt, 5/16" - 18 x 1 1/8" Hx. Hd. ....	330	1	All
5-2-2		Lockwasher, 5/16" Med. ....	240	1	All
5-2-1		Nut, 5/16" - 18 Hx. Lt. ....	205	1	All
5.055 - EXHAUST MUFFLER					
5-2-8		Muffler.....	200440	1	All
		Muffler (Dual Manifold).....	203382	1	F486
5-2-13		Clamp, Exhaust Pipe to Muffler.....	200439	1	All
5-2-6		Bolt, 5/16" - 18 x 1 1/8" Hx. Hd. ....	296	1	All
		Lockwasher, 5/16" Med. ....	240	1	All
		Nut, 5/16" - 18 Hx. ....	205	1	All
5.060 - EXHAUST MUFFLER BRACKET AND CLAMP					
17-1-5		Bracket (to Frame).....	201376	1	All
5-2-3		Bolt, 3/8" - 24 x 5/8" Hx. Hd. ....	638	4	All
		Clamp.....	201386	1	F47, F47C, K100, K101
		Bolt, 5/16" - 18 x			
		1 1/8" Hx. Hd. ....	296	1	F47, F47C, K100, K101
		Lockwasher, 5/16"			
		Med. ....	240	1	F47, F47C, K100, K101
		Nut, 5/16" - 18			
		Hx. ....	205	1	F47, F47C, K100, K101
		Strap, Support.....	201388	1	F47, F47C, K100, K101
		Bolt, 5/16" - 18 x			
		7/8" Hx. Hd. ....	209	3	F47, F47C, K100, K101
		Flatwasher, 5/16"			
		Lg. ....	300	3	F47, F47C, K100, K101
		Lockwasher, 5/16"			
		Med. ....	240	3	F47, F47C, K100, K101
		Nut, 5/16" - 18 Hx.	205	3	F47, F47C, K100, K101
		Lock.....	201387	3	F47, F47C, K100, K101
		Clamp (Dual Manifold).....	203383	1	F486
5-2-9		Clamp.....	203129	1	All
5-2-6		Bolt, 5/16" - 18 x			
		1 1/8" Hx. Hd. ....	296	1	All
		Lockwasher, 5/16"			
		Med. ....	240	1	All
		Nut, 5/16" - 18 Hx.	205	1	All
5-2-11		Insulator (incl. Stud).....	203130	1	All

## EXHAUST

FIGURE NUMBER	GROUP	PART NAME and DESCRIPTION	PART NUMBER	QTY.	MODELS
5.060 - EXHAUST MUFFLER BRACKET AND CLAMP (CONT'D.)					
5-2-12		Flatwasher, 5/16" Lg. ....	after Serial F47-34259, F47C-1,028,982, K100-60589, K101-2,003,831	300	1 All
		Lockwasher, 5/16" Med. ....		240	2 All
		Nut, 5/16" - 18 Hx. ....		205	2 All
5-2-10		Spacer.....		203131	1 All
5.070 - TAIL PIPE					
5-2-21		Pipe.....	200442	1	All
		Pipe (Dual Manifold).....	203384	1	F486
		Bracket (to Frame).....	201548	1	F47, F47C, K100, K101
		Bolt, 5/16" - 12 x 3/4" Hx. Hd. Tap. ....	445	2	F47, F47C, K100, K101
		Hanger.....	201394	1	F47, F47C, K100, K101
		Bolt.....	201393	1	F47, F47C, K100, K101
		Flatwasher, 5/16" Lg. ....	300	1	F47, F47C, K100, K101
		Nut, 5/16" - 24 Hx. Sl. ....	299	1	F47, F47C, K100, K101
		Cotter Pin, 1/16" x 7/8".....	298	1	F47, F47C, K100, K101
		Bolt, 5/16" - 18 x 1 1/8" Hx. ....	296	1	F47, F47C, K100, K101
		Lockwasher, 5/16" Med. ....	240	1	F47, F47C, K100, K101
		Nut, 5/16" - 18 Hx. ....	205	1	F47, F47C, K100, K101
		Bushing (Rubber).....	201392	1	F47, F47C, K100, K101
		Washer.....	201390	1	F47, F47C, K100, K101
		Retainer.....	201391	1	F47, F47C, K100, K101
		Clamp (Dual Manifold).....	203385	1	F486
5-2-7		Clamp.....	203133	1	All
5-2-6		Bolt, 5/16" - 18 x 1 1/8" Hx. Hd. ....	296	1	All
		Lockwasher, 5/16" Med. ....	240	1	All
		Nut, 5/16" - 18 Hx. ....	205	1	All
5-2-5		Bracket (to Frame).....	203132	1	All
5-2-3		Bolt, 5/16" - 12 x 3/4" Hx. Hd. Tap. ....	445	2	All
5-2-4		Insulator (incl. Stud). Lockwasher, 5/16" Med. ....	203134	1	All
		Nut, 5/16" - 18 Hx. ....	240	2	All
5-2-22		Deflector.....	200023	1	All