

FIGURE 8-1—TYPICAL CLUTCH - 9 SPRING - EXPLODED VIEW

Key	Part Name	Group	Key	Part Name	Group
1	Cover, Pressure Plate...	8.104	8	Eyebolt & Nut Ass'y.,	
2	Spring, Pressure Plate			Pressure Plate Lever..	8.104
	Lever.....	8.104	9	Lever, Pressure Plate...	8.104
3	Spring, Pressure Plate..	8.104	10	Strut, Pressure Plate...	8.104
4	Facing Set.....	8.100	11	Plate Ass'y., Pressure..	8.104
5	Disc.....	8.100	12	Bolt, Pressure Plate....	8.104
6	Plate, Pressure.....	8.104	13	Lockwasher, Pressure	
7	Pin, Pressure Plate			Plate.....	8.104
	Lever.....	8.104			

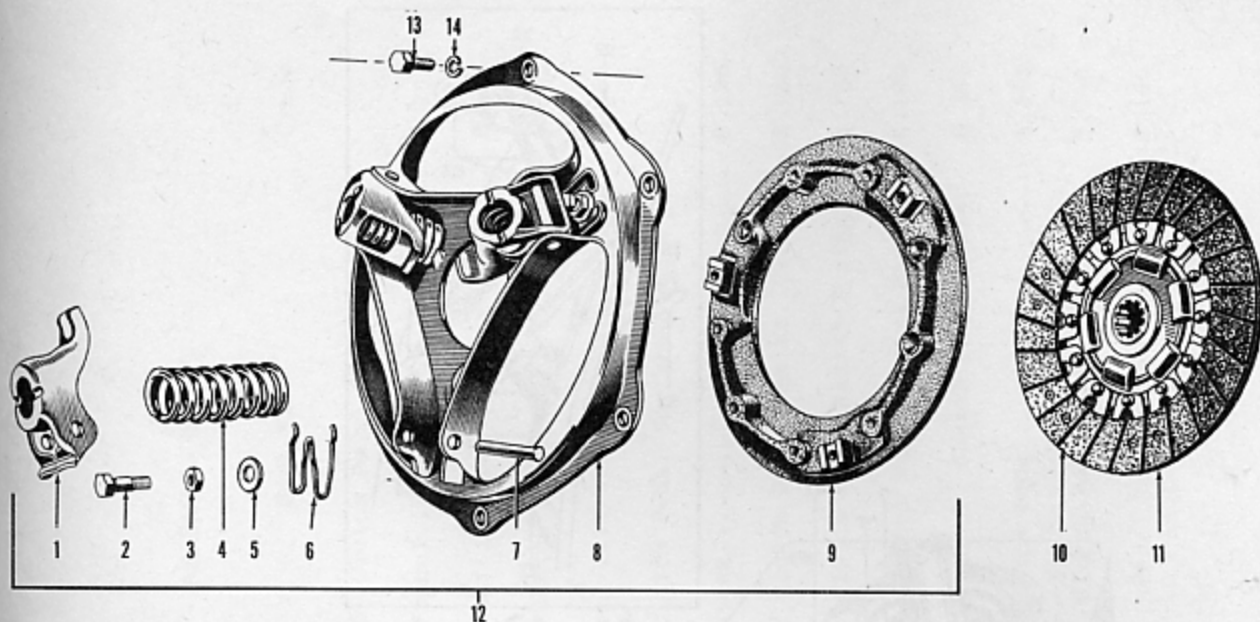

FIGURE 8-2—TYPICAL CLUTCH - 3 SPRING -. EXPLODED VIEW

Key	Part Name	Group	Key	Part Name	Group
1	Lever, Pressure Plate...	8.106	7	Pin, Pressure Plate	
2	Screw, Pressure Plate			Lever.....	8.106
	Lever Adjusting.....	8.106	8	Cover, Pressure Plate...	8.106
3	Locknut, Pressure Plate		9	Plate, Pressure.....	8.102
	Lever.....	8.106	10	Disc.....	8.102
4	Spring, Pressure Plate..	8.106	11	Facing Set.....	8.102
5	Flatwasher, Pressure		12	Plate Ass'y.....	8.106
	Plate Lever.....	8.106	13	Bolt, Pressure Plate....	8.106
6	Spring, Pressure Plate		14	Lockwasher, Pressure	
	Lever.....	8.106		Plate.....	8.106

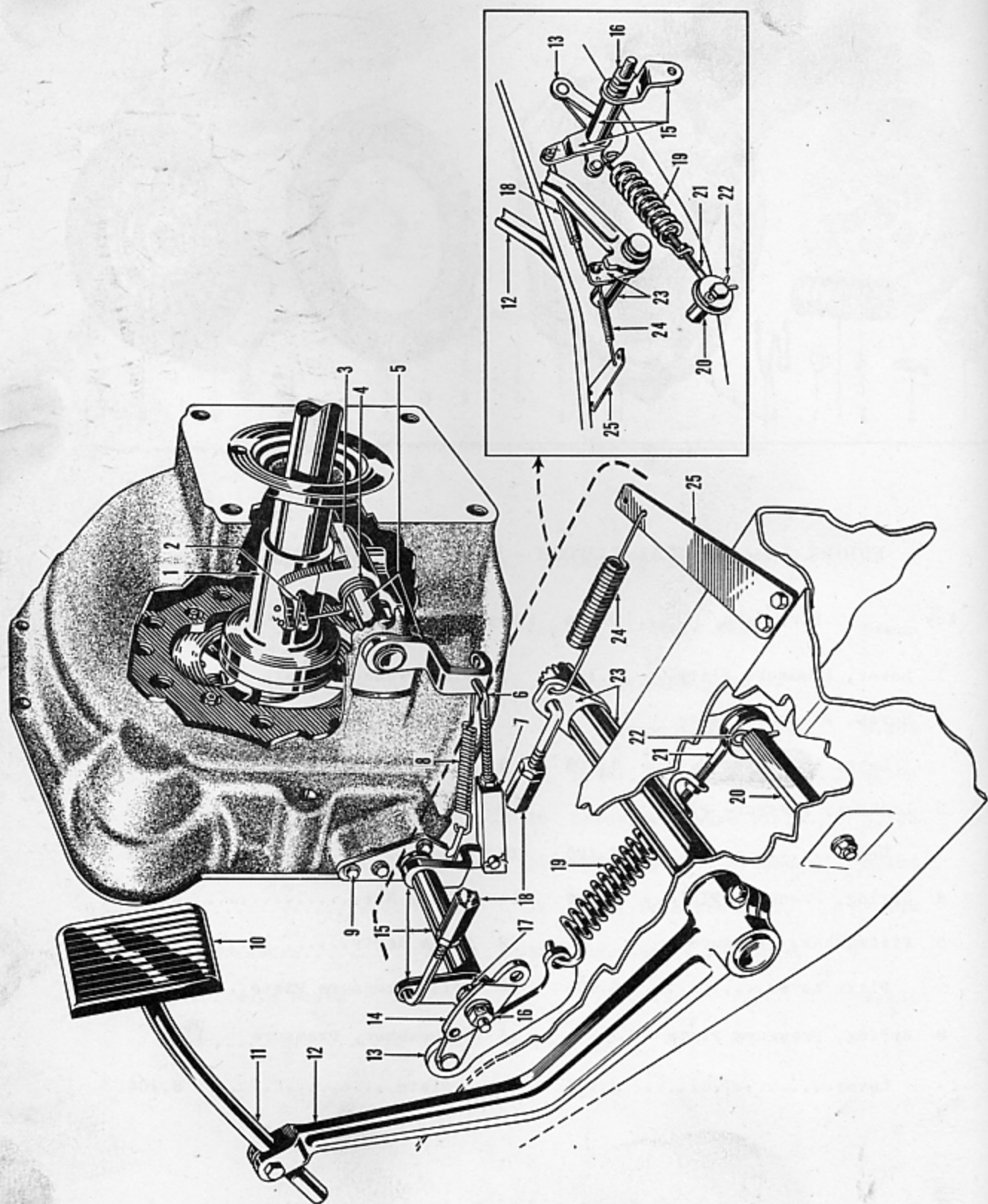

FIGURE 8-3—CLUTCH RELEASE MECHANISM - ASSEMBLED VIEW

FIGURE 8-3—CLUTCH RELEASE MECHANISM - ASSEMBLED VIEW

Key	Part Name	Group	Key	Part Name	Group
1	Bearing and Sleeve Ass'y., Clutch Release.....	8.120	14	Bracket, Clutch Pedal Cross Shaft (to Frame).....	8.155
2	Blade, Clutch Release Bearing and Sleeve.....	8.120	15	Cross Shaft Ass'y., Clutch Pedal.....	8.155
3	Fork, Clutch Release.....	8.125	16	Pivot, Clutch Pedal Cross Shaft.....	8.155
4	Spring, Clutch Release Bearing.....	8.120	17	Dust Seal.....	8.155
5	Shaft, Clutch Release Fork.....	8.125	18	Link, Clutch Pedal to Cross Shaft Adjusting.....	8.150
6	Rod, Clutch Adjusting.....	8.165	19	Spring, Clutch Pedal Assist.....	8.160
7	Clevis, Clutch Adjusting Rod.....	8.165	20	Anchor, Clutch Pedal Assist Spring....	8.160
8	Spring, Clutch Release Fork Shaft....	8.125	21	Eyebolt, Clutch Pedal Assist Spring..	8.160
9	Bracket, Clutch Pedal Cross Shaft....	8.155	22	Spring Retainer, Clutch Pedal Assist.	8.160
10	Pad, Clutch Pedal.....	8.140	23	Shaft, Clutch Pedal.....	8.145
11	Pedal, Clutch.....	8.140	24	Spring, Clutch Pedal Return.....	8.140
12	Arm, Clutch Pedal.....	8.140	25	Bracket, Pedal Return Spring.....	8.140
13	Link, Clutch Pedal Assist Spring.....	8.160			

## CLUTCH and CONTROLS

FIGURE NUMBER	GROUP	PART NAME and DESCRIPTION	PART NUMBER	QTY.	MODELS
8.100 - CLUTCH DISC (NINE SPRING CLUTCH)					
8-1-5		Disc. (Incl. Facings).....	200200	1	All
8-1-4		Facing Set.....	200201	1	All
8.102 - CLUTCH DISC (THREE SPRING CLUTCH)					
8-2-10		Disc. (Incl. Facings).....	202970	1	All
8-2-11		Facing Set.....	202981	1	All
8.104 - CLUTCH PRESSURE PLATE (NINE SPRING CLUTCH)					
8-1-11		Plate (Incl. Cover).....	200204	1	All
8-1-12		Bolt, 5/16" - 18 x 7/8" Hx. Hd. ....	200169	6	All
8-1-13		Lockwasher, 5/16" Hy. ....	191	6	All
8-1-6		Plate.....	200205	1	All
8-1-3		Spring.....	200206	9	All
8-1-1		Cover.....	200213	1	All
8-1-9		Lever.....	200207	3	All
8-1-7		Pin.....	200209	3	All
8-1-2		Spring.....	200212	3	All
8-1-10		Strut.....	200208	3	All
8-1-8		Eyebolt and Nut.....	200210	3	All
8.106 - CLUTCH PRESSURE PLATE (THREE SPRING CLUTCH)					
8-2-12		Plate (Incl. Cover).....	202971	1	All
8-2-13		Bolt, 5/16" - 18 x 7/8" Hx. Hd. ....	200169	6	All
8-2-14		Lockwasher, 5/16" Hy. ....	191	6	All
8-2-9		Plate.....	202972	1	All
8-2-4		Spring.....	202980	3	All
8-2-8		Cover.....	202973	1	All
8-2-1		Lever.....	202974	3	All
8-2-7		Pin.....	202975	3	All
8-2-6		Spring.....	202976	3	All
8-2-5		Flatwasher.....	202979	3	All
8-2-2		Screw, Adjusting.....	202977	3	All
8-2-3		Locknut.....	202978	3	All
8.120 - CLUTCH RELEASE BEARING					
8-3-1		Bearing and Sleeve (Incl. Blades).....	200214	1	All
8-3-4		Spring.....	200217	2	All
NOTE: A number of Springs with a Hole Diameter of 15/16" were used in this location. Replacement should be made with two (2) 13/16" Diam. 200217 Springs.					
8-3-2		Blade, up to Serial F47-11029, K100-18989.	200259	2	F47, K100
		Blade, after Serial F47-11029, K100-18989.	202048	2	All
		Cotter Pin, 1/16" x 1 3/8".....	472	4	All

## CLUTCH and CONTROLS

8

FIGURE NUMBER	GROUP	PART NAME and DESCRIPTION	PART NUMBER	QTY.	MODELS
8.125 - CLUTCH RELEASE FORK					
8-3-3		Fork.....	200215	1	All
		Set Screw, 7/16" - 14 x 1 1/8" Sq. Hd.			
		Drld. ....	200216	1	All
		Lockwire, 1/32" x 3".....	-----	*	All
8-3-5		Shaft.....	200218	1	All
		Shaft.....(R.H.D.).....	203467	1	F485, K481
8-3-8		Spring.....	201143	1	All
8.130 - CLUTCH HOUSING					
		Housing (Incl. Bushings).....	200124	1	All
		Bolt,.....(Thru End Plate).....	200125	2	All
		Lockwasher, 3/8" Med.. { and } ..	192	2	All
		Nut, 3/8" - 24 Hx. Lt. { Housing } ..	188	2	All
		Bolt, 7/16" - 14 x 1 1/2" { } ..			
		Hx. Hd. Soc. .... { to } ..	575	2	All
		Lockwasher, 7/16" Med.... { Block } ..	193	2	All
		Bolt, 3/8" - 16 x 7/8" { to } ..			
		Hx. Hd. .... { End Plate } ..	268	3	All
		Lockwasher, 3/8" Med..... { } ..	192	3	All
		Bushing, Clutch Release Bearing Shaft.....	200869	4	All
		Oiler.....	202139	2	All
8.135 - CLUTCH HOUSING PAN					
		Pan.....	200174	1	All
		Bolt, 1/4" - 20 x 1/2" Hx. Hd. ....	179	6	All
		Lockwasher, 1/4" Med. ....	190	6	All
8.140 - CLUTCH PEDAL					
8-3-11		Pedal.....	201063	1	All
		Bolt, 3/8" - 16 x 1 1/8" Hx. Hd. ....	182	1	All
		Lockwasher, 3/8" Med. ....	192	1	All
8-3-10		Pad, Rubber.....	200220	1	All
		Dust Seal.....	200221	1	All
8-3-12		Arm.....	200222	1	All
		Key, No. 9, 3/16" x 3/4".....	194	1	All
		Bolt, 5/16" - 24 x 1 3/4" Hx. Hd. ....	184	1	All
		Lockwasher, 5/16" Med. ....	240	1	All
		Nut, 5/16" - 24 Hx. Lt. ....	189	1	All
		Thrustwasher.....	200223	1	All
8-3-24		Spring, Pedal Return(L.H.D. and R.H.D.)...	201853	1	All
		Pedal (incl. Bushing).....(R.H.D.).....	203468	1	F485, K481
		Bushing.....(R.H.D.).....	203469	1	F485, K481
		Thrustwasher.....(R.H.D.).....	203470	2	F485, K481
		Lock Ring.....(R.H.D.).....	203471	2	F485, K481
		Oiler, 1/8" Pipe Straight..(R.H.D.).....	202120	1	F485, K481
		Pad.....(R.H.D.).....	203472	1	F485, K481
		Locknut, 3/8" - 24 Hx. Hd. ....	639	1	F485, K481
		Dust Seal.....(R.H.D.).....	203473	1	F485, K481
8-3-25		Bracket, Pedal Return Spring.....	200225	1	All
		Bolt, 1/4" - 20 x 1/2" Hx. Hd. Tap.....	285	2	All

\*As required

## CLUTCH and CONTROLS

FIGURE NUMBER	GROUP	PART NAME and DESCRIPTION	PART NUMBER	QTY.	MODELS
8.145 - CLUTCH PEDAL SHAFT					
8-3-23		Shaft (incl. Lever) up to Serial F47-3695, K100-5905.....	200226	1	F47, K100
		Shaft (incl. Lever) after Serial F47-3695, K100-5905.....	201886	1	All
		Bushing.....	200227	2	All
		Thrustwasher.....	200223	1	All
		Oiler, 1/4" - 28.....	202121	1	All
		Shaft.....(R.H.D.).....	203474	1	F485, K481
		Bolt, 5/16" - 12 x 3/4" Hx. Hd. Tap, up to Serial F485-5878, K481-21823.....	445	2	F485, K481
		Bolt, 3/8" - 24 x 1" Hx. Hd. ....	327	2	F485, K481
		Lockwasher, 3/8" Med. ....	192	2	F485, K481
8.150 - CLUTCH PEDAL TO CROSS SHAFT ADJUSTING LINK					
8-3-18		Link, up to Serial F47-3695, K100-5905....	200229	1	All
		Cotter Pin, 3/32" x 5/18".....	139	2	All
		Link, after Serial F47-3695, K100-5905....	201887	1	All
		Clevis Pin, 3/8" x 1 3/32".....	615	2	All
	Cotter Pin, 3/32" x 3/4".....	139	2	All	
8.155 - CLUTCH PEDAL CROSS SHAFT					
8-3-15		Shaft.....	200228	1	All
		Shaft.....(R.H.D.).....	203475	1	F485, K481
8-3-17		Spring.....	200234	1	All
		Seat.....	200235	2	All
		Washer.....	200233	2	All
8-3-16		Dust Seal.....	200230	2	All
		Oiler, 1/4" - 28.....	202121	1	All
8-3-9		Pivot.....	200231	2	All
		Lockwasher, 7/16" Med. ....	193	2	All
		Nut, 7/16" - 20 Hx. Hd. ....	187	2	All
8-3-14		Bracket (on Flywheel Housing).....	200232	1	All
		Bracket (on Flywheel Housing ) (R.H.D.)	203476	1	F485, K481
		Bolt, 5/16" - 18 x 3/4" Hx. Hd. ....	183	3	All
		Lockwasher, 5/16" Med. ....	240	3	All
8-3-14		Bracket (to Frame) up to Serial F485-5878, K481-21823 (R.H.D.).....	203485	1	F485, K481
		Bolt, 3/8" - 24 x 3/8" Hx. Hd. Tap.....	640	2	F485, K481
		Bracket (to Frame) L. H. D. and after Serial F485-5878, K481-21823 on R.H.D. only.....	200236	1	All
	Bolt, 3/8" - 24 x 3/4" Hx. Hd. ....	439	2	All	
	Lockwasher, 3/8" Med. ....	192	2	All	
8.160 - CLUTCH PEDAL ASSIST SPRING LINK					
8-3-13		Link.....	201371	1	All
		Link.....(R.H.D.).....	203477	1	F485, K481
8-3-19		Spring.....	201138	1	All
		Flatwasher.....	201370	1	All
8-3-21		Nut, 5/16" - 24 Hx. Lt. Thick.....	388	1	All
		Eyebolt.....	201139	1	All

## CLUTCH and CONTROLS

8

FIGURE NUMBER	GROUP	PART NAME and DESCRIPTION	PART NUMBER	QTY.	MODELS
8.160 - CLUTCH PEDAL ASSIST SPRING LINK (CONT'D.)					
8-3-22		Flatwasher, 23/32" x 1 3/8" x 1/16".....	201372	2	All
		Spring Retainer, 9/16".....	202138	2	All
		Anchor, up to Serial F47-1695, K100-1834..	201140	1	F47, K100
		Bolt, 3/8" - 24 x 3 3/4" Hx. Hd. ....	389	2	F47, K100
		Lockwasher, 3/8" Med. ....	192	2	F47, K100
8-3-20		Nut, 3/8" - 24 Hx. Hd. ....	188	2	F47, K100
		Anchor, after Serial F47-1695, K100-1834..	201373	1	All
		Anchor.....(R.H.D.).....	203478	1	F485, K481
		Lockwasher, 3/8" Med. ....	192	1	F485, K481
		Nut, 3/8" - 24 Hx. Hd. ....	188	1	F485, K481
8.165 - CLUTCH ADJUSTING ROD					
8-3-6		Rod.....	200237	1	All
		Cotter Pin, 3/32" x 3/4".....	139	1	All
8-3-7		Locknut, 3/8" - 24 Lt. ....	290	1	All
		Clevis.....	200238	1	All
		Clevis Pin, 3/8" x 3/4".....	200239	1	All
		Cotter Pin, 3/8" x 5/8".....	139	1	All
		Clevis Rod.....(R.H.D.).....	203480	1	F485, K481
		Clevis.....(R.H.D.).....	203479	1	F485, K481
		Jam Nut, 5/16" -24.....(R.H.D.).....	641	1	F485, K481
	Clevis Pin, 5/16" x 13/16".....	415	2	F485, K481	
	Cotter Pin, 3/32" x 1/2".....	414	2	F485, K481	
8.170 - CLUTCH PEDAL FLOOR PLATE					
		Plate, Upper.....	200506	1	All
		Plate, Lower.....	200507	1	All
		Plate, Upper.....(R.H.D.).....	203481	1	F485, K481
		Plate, Lower.....(R.H.D.).....	203482	1	F485, K481
		Bolt, 1/4" - 28 x 5/8" Rd. Hd. Sl. up to Serial F47-2834, K100-4166.....	302	6	F47, K100
		Bolt, 1/4" - 20 x 9/16" Hx. Hd. after Serial F47-2834, K100-4166.....	394	6	All
		Lockwasher, 1/4" Ext. Tooth.....	370	6	All
		Gasket.....	200508	1	All
		Gasket.....(R.H.D.).....	203483	1	F485, K481