

FIGURE 16-1—TYPICAL FRONT WHEEL AND BEARINGS - EXPLODED VIEW

Key	Part Name	Group	Key	Part Name	Group
1	Cap, Grease.....	16.010	6	Cup, Outer.....	16.010
2	Cotter Pin.....	16.002	7	Cup, Inner.....	16.010
3	Nut.....	16.002	8	Cone, Inner.....	16.010
4	Flatwasher.....	16.002	9	Seal, Inner.....	16.010
5	Cone, Outer.....	16.010	10	Knuckle, Steering.....	13.000

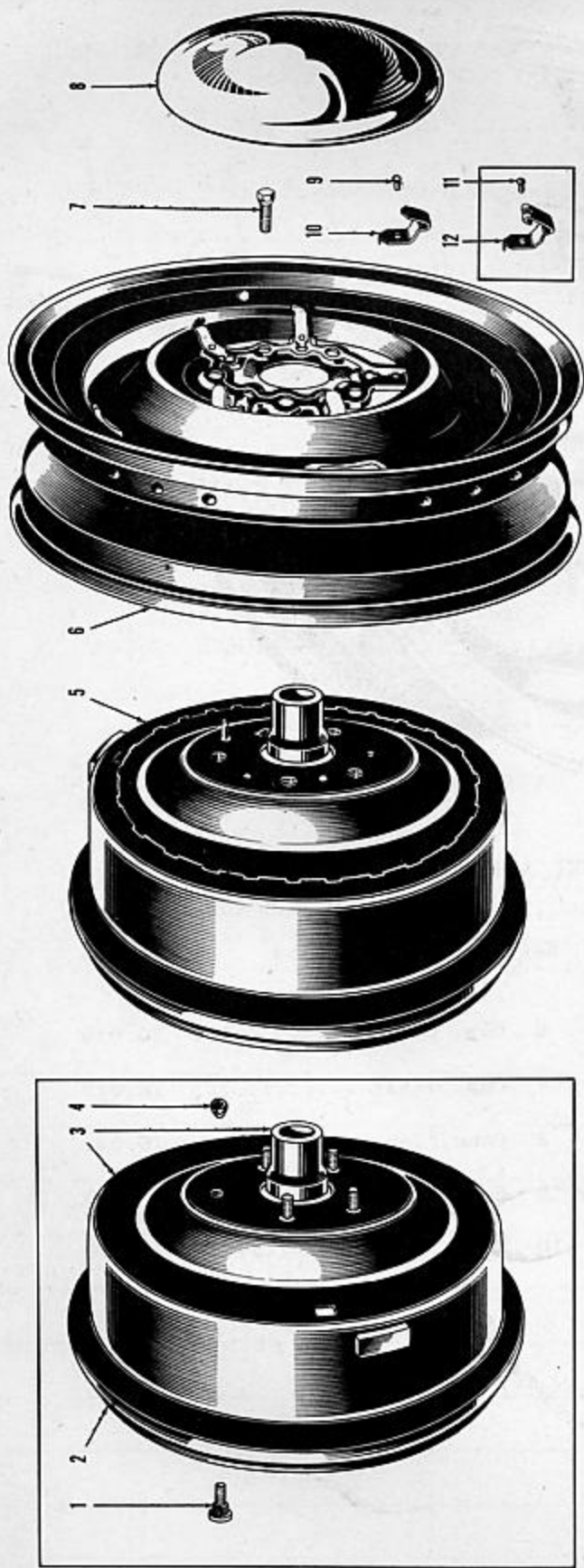

FIGURE 16-2 — TYPICAL WHEEL WITH HUBS AND DRUMS - EXPLODED VIEW

Key	Part Name	Group	Key	Part Name	Group
1	Stud.....	16.006	7	Bolt, Wheel.....	16.000
2	Drum, Brake.....	16.006	8	Cap (or Cover), Hub.....	16.026
3	Hub and Drum Assembly.....	16.002	9	Rivet.....	16.026
4	Nut, Wheel.....	16.000	10	Clip, Spring.....	16.026
5	Hub and Drum Assembly.....	16.002	11	Rivet.....	16.026
6	Wheel.....	16.000	12	Clip, Spring.....	16.026

FIGURE NUMBER	GROUP	PART NAME and DESCRIPTION	PART NUMBER	QTY.	MODELS
16.000 - WHEELS					
		Wheel (with Knob Type Hub Cap or Cover Retainer).....	201149	5	F47, K100
16-2-6	†	Wheel (21/32" Stud Holes).....	201809	5	F47, F47C, K100, K101
16-2-4		Nut, R.H. Thd. (13/16" Across Flats)....	201160	10	F47, F47C, K100, K101
16-2-4		Nut, L.H. Thd. (13/16" Across Flats)....	201161	10	F47, F47C, K100, K101
16-2-6		Wheel (9/16" Stud Holes).....	203258	5	All
16-2-6		Wheel (9/16" Stud Holes) (16") (Export)...	203308	5	All
16-2-4		Nut, R.H. Thd. (3/4" Across Flats).....	203119	20	All
16-2-4		Nut, L.H. Thd. (3/4" Across Flats).....	203120	*	All
16-2-7		Bolt, R.H. Thd.....	203121	20	All
16.002 - FRONT WHEEL HUB AND DRUM					
16-2-3		Hub and Drum (with Studs for Mtg. Wheels).	201152	2	All
16-2-5		Hub and Drum (with Tapped Holes for Wheel Mtg. Bolts).....	203123	2	F485, F486, K481, K482
16-1-4		Flatwasher, 3/4" x 1 11/16" x 1/8".....	201166	2	All
16-1-3		Nut, 3/4" - 16 Hx. Sl. Lt.	436	2	All
16-1-2		Cotter Pin, 1/8" x 1 1/2".....	341	2	All
16.006 - FRONT WHEEL BRAKE DRUM					
16-2-2	‡	Drum.....	201156	2	All
16-2-1		Stud, R.H. Thd.	201158	5	All
16-2-1		Stud, L.H. Thd.	201159	5	All
16.010 - FRONT WHEEL BEARINGS					
16-1-8		Bearing Cone, Inner.....	201163	2	All
16-1-7		Bearing Cup, Inner.....	201162	2	All
16-1-5		Bearing Cone, Outer.....	201165	2	All
16-1-6		Bearing Cup, Outer.....	201164	2	All
16-1-9		Seal, Inner.....	201167	2	All
16-1-1		Cap, Grease.....	201151	2	All
16.020 - REAR WHEEL HUB AND DRUM					
16-2-3		Hub and Drum (with Studs for Mtg. Wheels).	201154	2	All
16-2-5		Hub and Drum (with Tapped Holes for Wheel Mtg. Bolts).....	203125	2	All
		Key.....	200374	2	All
		Flatwasher, 1 1/32" x 1 15/16" x 1/8"...	200376	2	All
		Nut, 1" - 14 Hx. Hd.	200375	2	All
		Cotter Pin, 1/8" x 1 1/2".....	341	2	All
16.022 - REAR WHEEL BRAKE DRUM					
16-2-2	‡	Drum.....	201157	2	All
16-2-1		Stud, R.H. Thd., 1/2" - 20 x 1 7/16"....	201158	5	All
16-2-1		Stud, L.H. Thd., 1/2" - 20 x 1 7/16"....	201159	5	All

*As required †Identified by Yellow Paint Daub near Stud Hole ‡Replaceable only on Hub and Drum fastened by Wheel Studs

WHEELS

FIGURE NUMBER	GROUP	PART NAME and DESCRIPTION	PART NUMBER	QTY.	MODELS
16.026 - WHEEL HUB CAP OR COVER					
		Cap, Red Lettering... {Wheels with Knob} ...	201150	4	F47
		Cap, Red Lettering... {Type Retainers} ...	201808	4	K100
		Cap, Plain.....	202548	4	F47, K100
16-2-8		Cap, Black Lettering..... {Wheels with Spring} ...	201811	4	K100
16-2-8		Cap, Plain..... {Clip Type Retainers} ...	202547	4	All
16-2-12		Clip, Spring (Free End Rolled Under).....	202681	25	All
16-2-11		Rivet, Rd. Hd.	202741	25	All
16-2-10		Clip, Spring (Free End Tapered).....	203262	25	F485, F486, F481, F482
16-2-9		Rivet, Fl. Hd.	203263	25	F485, F486, K481, K482
16.028 - WHEEL TRIM RING (FOR SETS SEE GROUP 40.122)					
		Ring (Single) Plastic.....	201780	*	All
		Ring (Single) Stainless Steel (Wide).....	203080	*	All
		Ring (Single) Stainless Steel (Narrow)....	201858	*	All
16.030 - SPARE WHEEL MOUNTING BRACKET					
		Bracket.....	200543	1	All
		Bolt, .1/4" - 20 x 5/8" Hx. Hd.	257	2	All
		Flatwasher, 1/4" Lg.	344	2	All
		Lockwasher, 1/4" Med.	190	2	All
		Nut, 1/4" - 20 Hx. Hd.	203	2	All
30-2-18		Clamp.....	200545	1	All
		Bolt, 1/2" - 13 x 1 1/4" Hx. Hd.	437	1	All