

FIGURE 40-1—AIR CONDITIONER - EXPLODED VIEW

FIGURE 40-1—AIR CONDITIONER - EXPLODED VIEW

Key	Part Name	Group	Key	Part Name	Group
1	Core, Air Conditioner.....	40.02	12	Fan.....	40.02
2	Cover, Front (Incl. in Air Conditioner Ass'y.).....	40.02	13	Clamp, Hose.....	40.02
3	Cover, Back (Incl. in Air Conditioner Ass'y.).....	40.02	14	Hose, Defroster.....	40.08
4	Gasket, Air Conditioner.....	40.02	15	Hose, Engine to Air Conditioner.....	40.02
5	Blower, Defroster.....	40.08	16	Pad, Motor.....	40.02
6	Nut, Defroster Wing.....	40.08	17	Spacer, Air Conditioner.....	40.02
7	Motor, Air Conditioner.....	40.02	18	Harness, Air Conditioner Wiring.....	40.04
8	Knob, Door.....	40.02	19	Elbow, Water Inlet.....	40.02
9	Door, Side (Incl. in Air Conditioner Ass'y.).....	40.02	20	Elbow, Water Outlet.....	40.02
10	Door, Front (Incl. in Air Conditioner Ass'y.).....	40.02	21	Knob, Defroster Switch.....	40.08
11	Shroud, Fan (Incl. in Air Conditioner Ass'y.).....	40.02	22	Switch, Defroster.....	40.08
			23	Switch, Heater.....	40.02
			24	Control, Temperature.....	40.06
			25	Knob, Temperature Control Rod.....	40.06
			26	Rod, Temperature Control.....	40.06
			27	Control, Ventilator Shutter.....	40.06

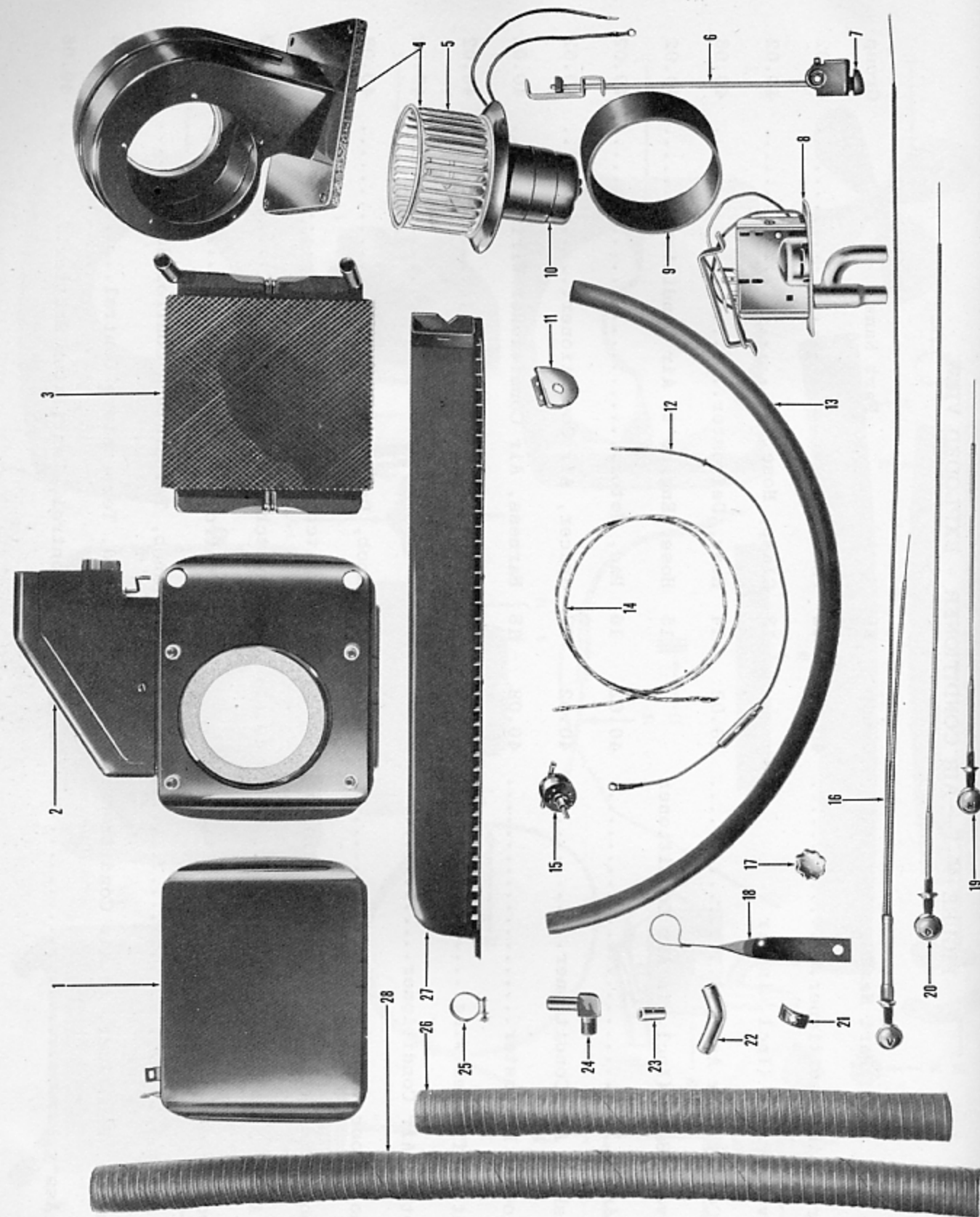

FIGURE 40-2—AIR CONDITIONER - MANHATTAN ONLY - EXPLODED VIEW

FIGURE 40-2—AIR CONDITIONER - MANHATTAN ONLY - EXPLODED VIEW

Key	Part Name	Group	Key	Part Name	Group
1	Cover, Front (Not Serviced).....		15	Switch, Air Conditioner.....	40.02
2	Cover, Back (Not Serviced).....		16	Control, Ventilator.....	30.034
3	Core, Air Conditioner.....	40.02	17	Knob, Air Conditioner Switch.....	40.02
4	Blower-Complete.....	40.02	18	Bracket, Temperature Control Hose.	40.02
5	Fan, Blower.....	40.02	19	Cable, Air Conditioner Control....	40.02
6	Rod, Temperature Control.....	40.06	20	Cable, Defroster Control.....	40.08
7	Knob, Temperature Control Rod.....	40.06	21	Speednut.....	30.034
8	Control, Temperature.....	40.06	22	Elbow, Water Outlet.....	40.02
9	Tube, Blower to Tee.....	40.02	23	Spacer.....	40.02
10	Motor, Blower.....	40.02	24	Elbow, Water Inlet.....	40.02
11	Bracket, Defroster Cable.....	40.08	25	Clamp, Hose.....	40.06
12	Cable, Air Conditioner Switch Feed.	40.04	26	Hose, Defroster.....	40.08
13	Hose, Air Conditioner Water.....	40.02	27	Duct, Air.....	40.02
14	Cable, Air Conditioner Blower.....	40.04	28	Hose, Defroster.....	40.08

## ACCESSORIES OR SPECIAL EQUIPMENT

FIGURE NUMBER	GROUP	PART NAME and DESCRIPTION	PART NUMBER	QTY.	MODELS
40.02 - AIR CONDITIONER					
		Air Conditioner (incl. All Fittings and Attaching Parts).....	200005	1	All
40-1-17		Spacer, 43/64" I.D. x 1".....	201980	4	All
		Lockwasher, 5/16" Int. Ext. Tooth.....	226	4	All
		Nut, 5/16" - 18 Hx. Lt. ....	205	4	All
40-1-4		Gasket, Air Conditioner (Sponge Rubber)...	203077	1	All
40-1-1		Core, Air Conditioner.....	203078	1	All
40-1-7		Motor, Air Conditioner Fan.....	201999	1	All
40-1-16		Pad, Motor (Rubber).....	203079	1	All
40-1-12		Fan (incl. Set Screw).....	202001	1	All
40-2-3		Core, Air Conditioner, after Body No. F486-8769.....	203264	1	F486
40-2-4		Blower Complete (incl. Motor and Fan) after Body No. F486-8769.....	203265	1	F486
40-2-10		Motor, Blower.....	203266	1	F486
		Pad, Motor (Rubber).....	203267	1	F486
40-2-5		Fan, Blower.....	203268	1	F486
40-2-9		Tube, Blower to Right Outlet (Rubber).....	203269	1	F486
40-2-27		Duct, Air (Inner Dash Panel).....	203270	1	F486
		Screw, No. 10 - 16 x 1 1/4" Pan Hd. Cr. Rec. Tap.....	626	1	F486
		Screw, No. 10 - 16 x 3/8" Pan Hd. Cr. Rec. Tap.....	249	1	F486
40-1-23		Switch, Air Conditioner.....	201981	1	All
		Gasket, Paper.....	200824	1	All
		Lockwasher, 7/16" Int. Tooth.....	305	1	All
		Nut, 7/16" - 28.....	200823	1	F47, F47C, F485, F486
		Nut, 7/16" - 28.....	201603	1	K100, K101, K481, K482
		Knob, Switch.....	202003	1	F47, F47C, F485, F486
		Knob, Switch.....	202002	1	K100, K101, K481, K482
		Screw, Set, No. 8 - 32 x 1/8" Hx. Soc. Cup Pt. ....	306	1	All
40-2-15		Switch, Air Conditioner, after Body No. F486-8769.....	201989	1	F486
		Spacer.....	200739	1	F486
		Lockwasher, 7/16" Int. Tooth.....	466	1	F486
		Nut, 7/16" - 28.....	200740	1	F486
40-2-17		Knob, Switch.....	200741	1	F486
40-2-19		Cable, Air Conditioner Control.....	203271	1	F486
		Lockwasher, 3/8" Ext. Tooth.....	291	1	F486
		Nut, Jam, 3/8" - 24 Hx. Lt. ....	290	1	F486
		Clip.....	202902	1	F486
		Screw, No. 8 - 32 x 3/8" Rd. Hd. Cr. Rec. ....	599	1	F486
		Speednut.....	202901	1	F486
40-1-8		Knob, Air Conditioner Door.....	202825	3	All
		Screw.....	614	3	All
40-1-19		Elbow, Water Inlet (to Cylinder Block)....	201997	1	All
40-1-20		Elbow, Water Outlet (to Water Pump).....	201998	1	All
		Bushing, 1/2" x 3/8" Pipe x 9/16".....	465	1	All
40-1-15		Hose (Engine to Air Conditioner) (5/8" I.D. x 15") (Cut from 202004 or 202006).		1	All
40-2-13		Hose (Temp. Control to Air Conditioner) (5/8" I.D. x 36") (Cut from 202004 or 202006)			

## ACCESSORIES OR SPECIAL EQUIPMENT

40

FIGURE NUMBER	GROUP	PART NAME and DESCRIPTION	PART NUMBER	QTY.	MODELS
40.02 - AIR CONDITIONER (CONT'D.)					
		Hose (5/8" I.D.) (50 Ft. Roll).....	202004	* All	
		Hose (5/8" I.D.) (100 Ft. Roll).....	202006	* All	
40-1-13		Clamp, 1 1/32" Diam. ....	203745	4 All	
40-2-18		Bracket, Temp. Control to Air Conditioner Hose.....	201996	1 All	
40.04 - AIR CONDITIONER AND DEFROSTER WIRING HARNESS					
40-1-18		Harness, Ignition to Air Conditioner and Defroster Switch (incl. Fuse).....	201990	1 All	
40-2-12		Harness, Air Conditioner Switch Feed (incl. Fuse) after Body No. F486-8769...	203272	1 F486	
7-1-11		Fuse (14 Amp.).....	202011	1 All	
40-2-14		Cable, Air Conditioner Blower Feed..... Screw, Air Conditioner Blower Ground Terminal, No. 10 - 12 x 3/8" Rd. Hd. Sl. Tap.....	203273   311	1   1	F486   F486
40.06 - AIR CONDITIONER CONTROLS					
40-1-24		Control, Temp. (incl. Air Coil)..... Screw, No. 10 - 12 x 1 1/4" Pan Hd. Sl. Tap.....	201982  461	1  1	All  All
		Screw, No. 8 - 15 x 3/8" Pan Hd. Sl. Tap	462	1	All
40-1-26		Rod, Temp. Control (incl. Knob)..... Spacer, 7/32" I.D. x 9/32"..... Spring, Retainer, 3/16" Hair Pin..... Bolt, 1/4" - 20 x 3/4" Hx. Hd. .... Lockwasher, 1/4" Ext. Tooth..... Nut, 1/4" - 20 Hx. Lt. ....	201983 201984 203746 529 370 203	1 1 1 1 1 1	All All All All All All
40-1-25		Knob.....	202008	1	All
40-1-27		Control Complete, Vent. Shutter.....  Lockwasher, 3/8" Ext. Tooth.....  Nut, Jam, 3/8" - 24 Hx. Lt. ....	201985  291  290	1  1  1	All except after Cars F486 All except after Cars F486 All except after Cars F486
		Knob and Wire, Vent. Shutter Control.....	202005	1	All except after Cars F486
		Bracket, Vent. Shutter Control..... Screw, No. 10 - 32 x 3/8" Rd. Hd. Sl. .. Lockwasher, No. 10 Ext. Tooth..... Nut, No. 10 - 32 Hx. ....	201986 283 294 202	1 2 2 2	All All All All
		Clip, Vent. Shutter Control..... Screw, No. 8 - 32 x 7/16" Rd. Hd. Sl. .. Lockwasher, No. 8 Ext. Tooth.....	201987 385 447	1 1 1	All All All
		Grommet, Vent. Shutter Control (Thru Dash) Hose (Temp. Control to Engine) (5/8" I.D. x 33") (Cut from 202004 or 202006)	200499	1	All
40-2-25		Clamp, 1 1/32" Diam. ....	203745	2	All
40.08 - DEFROSTER BLOWER					
40-1-5		Blower Complete (incl. Motor and Fan).....	201988	1	All except after Cars F486

\*As required

## ACCESSORIES OR SPECIAL EQUIPMENT

FIGURE NUMBER	GROUP	PART NAME and DESCRIPTION	PART NUMBER	QTY.	MODELS
40.08 - DEFROSTER BLOWER (CONT'D.)					
40-1-6		Nut, Wing, No. 10 - 24.....	202012	1	All
		Plate, Blower Mounting.....	203057	1	All
		Screw, No. 6 - 32 x 1/4" Rd. Hd. Sl. Tap	611	4	All
40-1-22		Switch, Defroster Blower.....	201989	1	All except after Cars F486
		Spacer.....	200739	1	All
		Lockwasher, 7/16" Int. Tooth.....	466	1	All
		Nut, 7/16" - 28.....	200740	1	All
40-1-21		Knob, Defroster Switch.....	200741	1	All
40-2-20		Cable, Defroster Control, after Body No. F486-8769.....	203274	1	F486
		Lockwasher, 3/8" Ext. Tooth.....	291	1	F486
		Nut, Jam, 3/8" - 24 Hx. Lt. ....	290	1	F486
40-2-11		Bracket, Defroster Control Cable.....	201986	1	F486
		Screw, No. 10 - 32 x 3/8" Rd. Hd. Sl. ..	283	2	F486
		Lockwasher, No. 10 Ext. Tooth.....	294	2	F486
		Nut, No. 10 - 32 Hx. ....	202	2	F486
		Nozzle, Defroster.....	200514	2	All
		Screw, No. 6 - 18 x 1/2" Pan Hd. Cr. Rec. Tap.....	498	4	All
40-2-26		Hose, Right Defroster (1 3/4" I.D. x 21")..	201991	1	All
40-1-14		Hose, Left Defroster (1 3/4" I.D. x 35")..	201992	1	All
40.100 - RADIO					
		Radio.....	200001	1	All
40.102 - ANTENNA (MANUAL)					
		Antenna (62").....	200003	1	All
		Antenna (93").....	200004	1	All
40.104 - SPOTLIGHT					
		Spotlight Complete (incl. Left Mounting Bracket).....	200008	1	All
		Bracket, Right Mounting.....	202765	1	All
		Lens.....	202176	1	All
		Gasket, Lens.....	203058	1	All
		Bezel, Lens.....	203059	1	All
		Screw and Nut.....	203065	1	All
		Bulb, Mazda No. 88.....	202175	1	All
40.108 - BACK-UP LIGHT					
		Light Complete (Rectangular).....	200028	1	All
		Lens (Rectangular).....	203286	1	All
		Gasket, Lens (Rectangular).....	200857	1	All
		Bezel, Lens (Rectangular).....	200855	1	All
		Screw, Bezel (Rectangular) No. 8 - 32 x 3/8" Ov. Hd. Cr. Rec. Pointed (Chrome).....	312	2	All
		Lens (Round).....	202956	1	All
		Gasket, Lens (Round).....	203062	1	All
		Bezel, Lens (Round).....	203063	1	All

## ACCESSORIES OR SPECIAL EQUIPMENT

40

FIGURE NUMBER	GROUP	PART NAME and DESCRIPTION	PART NUMBER	QTY.	MODELS
40.108		BACK-UP LIGHT (CONT'D.)			
		Screw, Bezel (Round) No. 6 - 32 x 1" Ov.			
		Hd. Sl. Header Pt. (Chrome).....	629	1	All
		Bulb, Mazda No. 1129 (Round).....	201360	1	All
		Switch (Round).....	202955	1	All
40.110		UTILITY LAMP			
		Lamp Complete.....	200025	1	All
		Bulb, Mazda No. 88.....	202459	1	All
40.112		FOGLIGHTS			
		Foglights (Pair).....	200009	1	All
		Bezel, Sealed Beam Retaining (KF Ornament).....	203064	1	All
		Screw and Nut.....	203065	1	All
		Bezel, Sealed Beam Retaining (KF Stamped).	203066	1	All
		Screw, No. 8 - 32 x 1" Ov. Hd. Sl. Header Pt. (Chrome).....	612	1	All
		Sealed Beam Unit.....	202178	2	All
		Switch.....	202179	1	All
40.114		UNDERHOOD LIGHT			
		Light.....	200034	1	All
		Bulb, Mazda No. 1129.....	201360	1	All
40.115		WINDSHIELD VISOR			
		Visor.....	100054	1	All
40.116		WINDSHIELD WASHER			
		Washer.....	200013	1	All
		Jet.....	202773	2	All
		Solvent Fluid (6 Oz. Bottle).....	200033	1	All
40.118		REAR VIEW MIRROR - OUTSIDE			
		Mirror, Right Hand.....	200010	1	All
		Mirror, Left Hand.....	200011	1	All
40.120		VANITY MIRROR			
		Mirror.....	200021	1	All
40.122		WHEEL TRIM RINGS			
		Plastic White Wall Rings (Set of 4).....	200007	1	All
		Stainless Steel Rings (Set of 5).....	200027	1	All
40.124		GAS TANK LOCKING CAP			
		Cap.....	200012	1	All
40.126		EXHAUST DEFLECTOR			
		Deflector.....	200023	1	All



## ACCESSORIES OR SPECIAL EQUIPMENT

FIGURE NUMBER	GROUP	PART NAME and DESCRIPTION	PART NUMBER	QTY.	MODELS
40.128 - LICENSE PLATE FRAMES					
		Frames (Pair).....	200014	1	All
40.129 - SEAT PROTECTOR PANEL					
		Panel.....	100061	*	All
40.130 - TRIM PANEL COVER SET					
		Cover Set.....	200015	1	All
40.132 - SEAT COVER SETS					
		Seat Cover (Matting).....	200026	1	All
		Seat Cover (Cloth) Maroon.....	200029	1	All
		Seat Cover (Cloth) Green.....	200030	1	All
		Seat Cover (Cloth) Blue.....	200031	1	All
		Seat Cover, Deluxe (incl. 200015 and 200026).....	200048	1	All
40.133 - WINDSHIELD "SEALZIT"					
		"Sealzit" (2 Oz. Bottle).....	100051	*	All
40.134 - PROTECTIVE MATERIALS					
		Auto Polish and Cleaner..... (Pint)....	200036	*	All
		Auto Polish and Cleaner..... (Gallon)..	100055	*	All
		Auto Cleaner and Wax..... (Pint)....	200037	*	All
		Radiator Stop Leak..... (10 Oz.)..	200038	*	All
		General Use Oil..... (4 Oz.)....	200039	*	All
		Fabric Cleaner..... (Pint)....	200040	*	All
		Radiator Rust Resistor..... (Pint)....	200041	*	All
		Glass Cleaner..... (12 Oz.)..	200042	*	All
		Black Rubber Finish..... (Gallon)..	200043	*	All
		Chrome Polish..... (8 Oz.)....	200044	*	All
		Spot Remover..... (5 Oz.)....	200045	*	All
		Radiator Flush..... (Pint)....	200046	*	All
		Lubriplate..... (2 Oz.)....	200032	*	All
		Perfect Seal Gasket Paste..... (16 Oz.)..	200047	*	All
		White Sidewall Tire Cleaner..... (13 Oz.)..	100052	*	All
		White Sidewall Tire Cleaner..... (Gallon)..	100053	*	All

\*As required