

FIGURE 8-1 — TYPICAL CLUTCH -9 SPRING - EXPLODED VIEW

KEY	PART NAME	GROUP	KEY	PART NAME	GROUP
1	Cover, Pressure Plate.....	8.104	8	Eyebolt and Nut Assembly, Pressure Plate Lever.....	8.104
2	Spring, Pressure Plate Lever.....	8.104	9	Lever, Pressure Plate.....	8.104
3	Spring, Pressure Plate.....	8.104	10	Strut, Pressure Plate.....	8.104
4	Facing Set.....	8.100	11	Plate Assembly, Pressure.....	8.104
5	Disc and Facings.....	8.100	12	Bolt, Pressure Plate.....	8.104
6	Plate, Pressure.....	8.104	13	Lockwasher, Pressure Plate.....	8.104
7	Pin, Pressure Plate Lever.....	8.104			

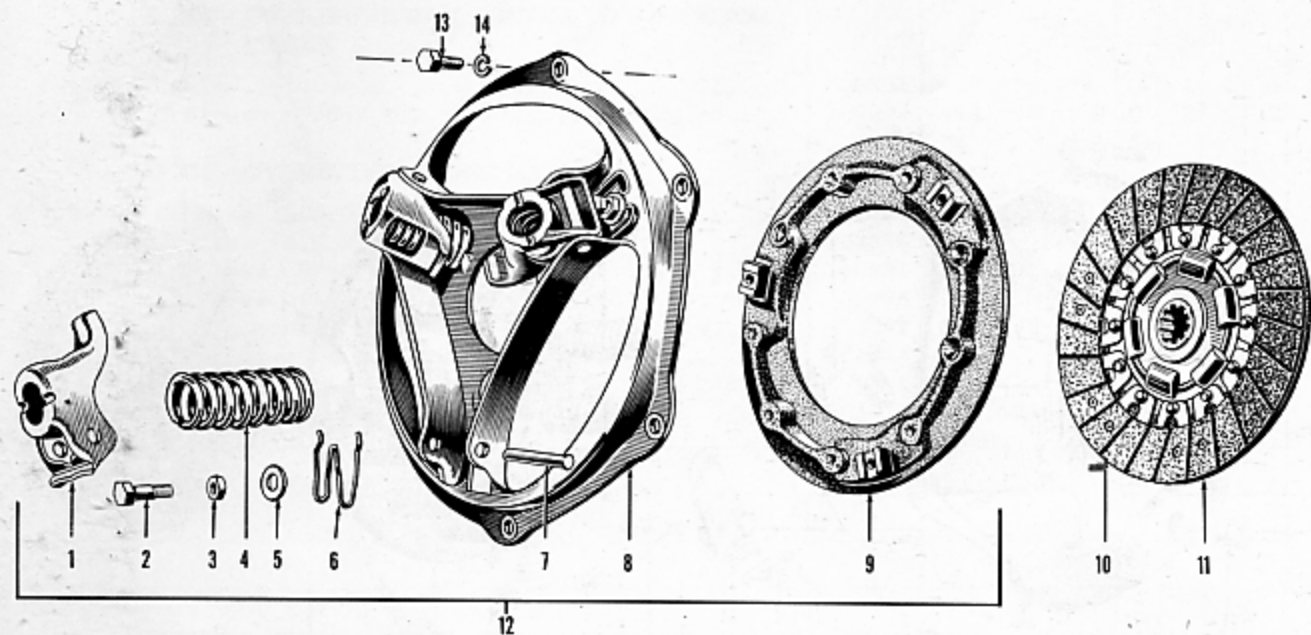

FIGURE 8-2 — TYPICAL CLUTCH - 3 SPRING - EXPLODED VIEW

KEY	PART NAME	GROUP	KEY	PART NAME	GROUP
1	Lever, Pressure Plate.....	8.106	8	Cover, Pressure Plate.....	8.106
2	Screw, Pressure Plate Lever Adjusting.....	8.106	9	Plate, Pressure.....	8.106
3	Locknut, Pressure Plate Lever.....	8.106	10	Disc and Facings.....	8.102
4	Spring, Pressure Plate.....	8.106	11	Facing Set.....	8.102
5	Flatwasher, Pressure Plate Lever..	8.106	12	Plate Assembly.....	8.106
6	Spring, Pressure Plate Lever.....	8.106	13	Bolt, Pressure Plate.....	8.106
7	Pin, Pressure Plate Lever.....	8.106	14	Lockwasher, Pressure Plate.....	8.106

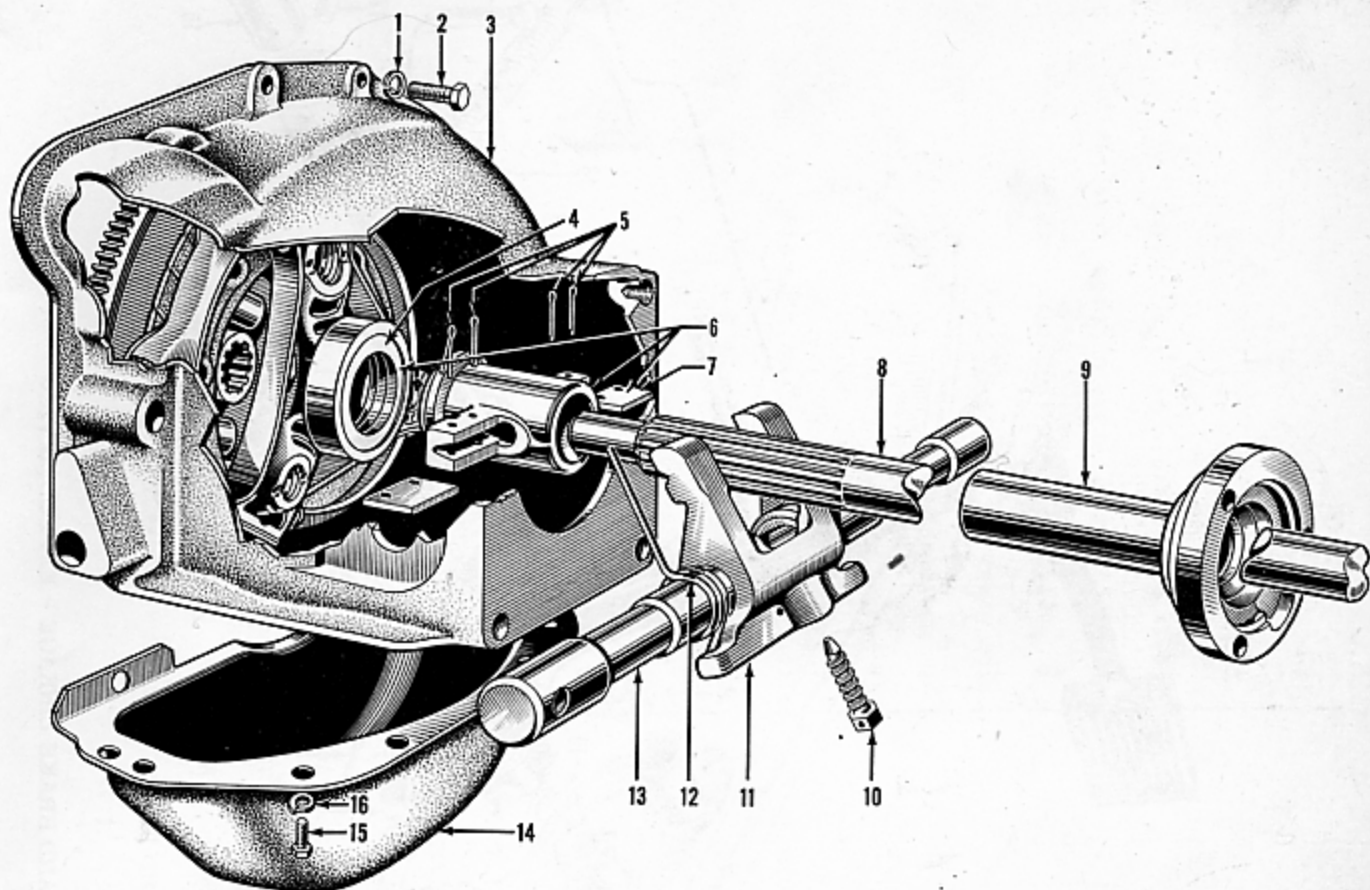

FIGURE 8-3 — CLUTCH RELEASE MECHANISM - EXPLODED VIEW

KEY	PART NAME	GROUP	KEY	PART NAME.	GROUP
1	Lockwasher.....	8.130	9	Retainer, Transmission Drive Pinion Bearing.....	9.115
2	Bolt.....	8.130	10	Set Screw, Fork.....	8.125
3	Housing.....	8.130	11	Fork.....	8.125
4	Bearing.....	8.120	12	Spring.....	8.120
5	Cotter Pin.....	8.120	13	Shaft, Clutch Release Fork.....	8.125
6	Bearing and Sleeve.....	8.120	14	Pan, Housing.....	8.135
7	Blade.....	8.120	15	Bolt, Housing Pan.....	8.135
8	Pinion, Transmission Drive.....	9.100	16	Lockwasher, Housing Pan.....	8.135

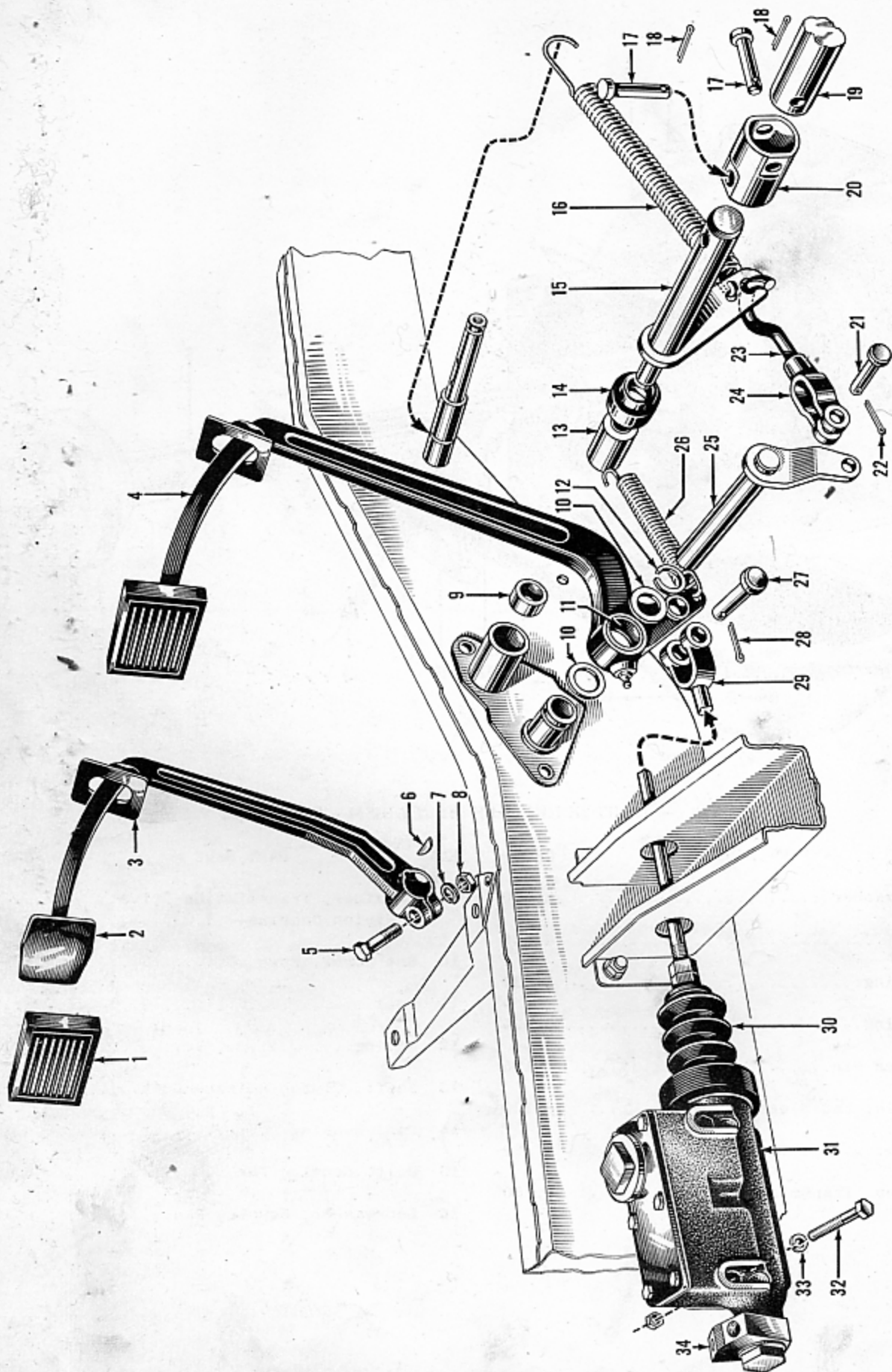

FIGURE 8-4 — CLUTCH AND BRAKE LINKAGE - EXPLODED VIEW

FIGURE 8-4 — CLUTCH AND BRAKE LINKAGE - EXPLODED VIEW

KEY	PART NAME	GROUP	KEY	PART NAME	GROUP
1	Pad, Clutch and Brake Pedal.....	8.140	19	Shaft, Clutch Release Fork.....	8.125
2	Pedal, Clutch.....	8.140	20	Coupling, Clutch Pedal Cross Shaft.....	8.155
3	Dust Seal.....	8.140	21	Clevis Pin, Clutch Pedal Shaft.....	8.145
4	Pedal, Brake.....	15.102	22	Cotter Pin, Clutch Pedal Shaft Clevis Pin.....	8.145
5	Bolt, Clutch Pedal.....	8.140	23	Adjusting Link, Clutch Pedal Shaft.....	8.145
6	Key, Clutch Pedal.....	8.140	24	Clevis, Clutch Pedal Shaft Adjusting Link.....	8.145
7	Lockwasher, Clutch Pedal.....	8.140	25	Shaft, Brake and Clutch Pedal.....	8.145
8	Nut, Clutch Pedal.....	8.140	26	Spring, Brake Pedal Return.....	15.108
9	Spacer, Clutch Pedal Cross Shaft.....	8.155	27	Clevis Pin, Master Cylinder Operating Rod.....	15.100
10	Washer, Brake Pedal.....	15.102	28	Cotter Pin, Master Cylinder Operating Rod Clevis Pin.....	15.100
11	Bushing, Brake Pedal.....	15.102	29	Rod, Master Cylinder Operating.....	15.100
12	Lock Ring, Brake Pedal.....	15.102	30	Boot, Master Cylinder.....	15.035
13	Pivot, Clutch Pedal Cross Shaft.....	8.155	31	Master Brake Cylinder.....	15.035
14	Dust Seal, Clutch Pedal Cross Shaft.....	8.155	32	Bolt, Master Brake Cylinder Mounting.....	15.035
15	Cross Shaft, Clutch Pedal.....	8.155	33	Lockwasher, Master Brake Cylinder Mounting.....	15.035
16	Spring, Clutch Pedal Return.....	8.140	34	Fitting, Master Brake Cylinder Outlet.....	15.035
17	Clevis Pin, Clutch Pedal Cross Shaft Coupling....	8.155			
18	Cotter Pin, Clutch Pedal Cross Shaft Coupling....	8.155			

CLUTCH and CONTROLS

FIGURE NUMBER	GROUP, PART NAME and DESCRIPTION	PART NUMBER	MODELS	BODY STYLES				
				4-DR. SEDAN	CONV.	VIRGINIAN	UTILITY	TAXICAB
				1	2	3	5	6
8.100 - CLUTCH DISC (NINE SPRING CLUTCH)								
8-1-5	Disc (incl. Facing) (For 3 Speed Trans.).....	200200	All	1			1	
	Disc (incl. Facing) (With Overdrive).....	206428	492, 495, 496	1	1	1	1	
	Disc (incl. Facing).....	205835	491					1
8-1-4	Facing Set.....	200201	All	1	1	1	1	
	Facing Set.....	205836	491					1
8.102 - CLUTCH DISC (THREE SPRING CLUTCH)								
8-2-10	Disc (incl. Facing).....	202970	All	1	1	1	1	
8-2-11	Facing Set.....	202981	All	1	1	1	1	
8.104 - CLUTCH PRESSURE PLATE (NINE SPRING CLUTCH)								
8-1-11	Plate (incl. Cover).....	200204	All	1	1	1	1	
	Plate (incl. Cover).....	205837	491					1
8-1-12	Bolt, 5/16"-18 x 7/8" Hx. Hd.....	200169	All	6	6	6	6	6
8-1-13	Lockwasher, 5/16" Hy.....	191	All	6	6	6	6	6
8-1-6	Plate.....	200205	All	1	1	1	1	
	Plate.....	205838	491					1
8-1-3	Spring.....	200206	All	9	9	9	9	
	Spring.....	205839	491					9
8-1-1	Cover.....	200213	All	1	1	1	1	
	Cover.....	205840	491					1
8-1-9	Lever.....	200207	All	3	3	3	3	
	Lever.....	205841	491					3
8-1-7	Pin.....	200209	All	3	3	3	3	3
8-1-2	Spring.....	200212	All	3	3	3	3	3
8-1-10	Strut.....	200208	All	3	3	3	3	3
8-1-8	Eyebolt and Nut.....	200210	All	3	3	3	3	
	Eyebolt and Nut.....	205842	491					3
8.106 - CLUTCH PRESSURE PLATE (THREE SPRING CLUTCH)								
8-2-12	Plate (incl. Cover).....	202971	All	1	1	1	1	
8-2-13	Bolt, 5/16"-18 x 7/8" Hx. Hd.....	200169	All	6	6	6	6	
8-2-14	Lockwasher, 5/16" Hy.....	191	All	6	6	6	6	
8-2-9	Plate.....	202972	All	1	1	1	1	
8-2-4	Spring.....	202976	All	3	3	3	3	
8-2-8	Cover.....	202973	All	1	1	1	1	
8-2-1	Lever.....	202974	All	3	3	3	3	
8-2-7	Pin.....	202975	All	3	3	3	3	
8-2-6	Spring.....	202980	All	3	3	3	3	
8-2-5	Flatwasher.....	202979	All	3	3	3	3	
8-2-2	Screw, Adjusting.....	202977	All	3	3	3	3	
8-2-3	Locknut.....	202978	All	3	3	3	3	
8.120 - CLUTCH RELEASE BEARING								
8-3-6	Bearing and Sleeve (incl. Blades).....	200214	All	1	1	1	1	1
8-3-4	Bearing.....	205745	All	1	1	1	1	1
8-3-12	Spring.....	200217	All	2	2	2	2	2
8-3-7	Blade.....	202048	All	2	2	2	2	2
8-3-5	Cotter Pin, 1/16" x 1 3/8".....	472	All	4	4	4	4	4

CLUTCH and CONTROLS

8

FIGURE NUMBER	GROUP, PART NAME and DESCRIPTION	PART NUMBER	MODELS	BODY STYLES							
				4-DR. SEDAN	CONV.	VIRGINIAN	UTILITY	TAXICAB			
				1	2	3	5	6			
8.125 - CLUTCH RELEASE FORK											
8-3-11	Fork.....	200215	All	1	1	1	1	1			
8-3-10	Set Screw, 7/16"-14 x 1 1/8" Sq. Hd. Dr'ld.	200216	All	1	1	1	1	1			
	Lockwire, 1/32" x 3".....		All	*	*	*	*	*			
8-3-13	Shaft (L.H.D.).....	204230	All	1	1	1	1	1			
	Shaft (RHD).....	203467	491,495	1							
	Spring (RHD).....	201143	491,495	1							
8.130 - CLUTCH HOUSING											
8-3-3	Housing.....	200124	All	1	1	1	1	1			
8-3-2	Bolt.....	200125	All	2	2	2	2	2			
8-3-1	Lockwasher 3/8" Med.....	192	All	2	2	2	2	2			
	Nut, 3/8"-24 Hx.....	188	All	2	2	2	2	2			
	Bolt, 7/16"-14 x 1 1/2" Hx.										
	Soc.....	575	All	2	2	2	2	2			
	Lockwasher, 7/16" Med.....	193	All	2	2	2	2	2			
	Bolt 3/8"-16 x 7/8" Hx. Hd..	268	All	3	3	3	3	3			
	Lockwasher, 3/8" Med.....	192	All	3	3	3	3	3			
	Oiler.....	202139	All	2	2	2	2	2			
8.135 - CLUTCH HOUSING PAN											
8-3-14	Pan.....	200174	All	1	1	1	1	1			
8-3-15	Bolt, 1/4"-20 x 1/2" Hx. Hd..	179	All	6	6	6	6	6			
8-3-16	Lockwasher, 1/4" Med.....	190	All	6	6	6	6	6			
	Screw, 5/16"-18 x 1/2" Hx. Hd..	322	All	2	2	2	2	2			
	Lockwasher, 5/16" Hy.....	191	All	2	2	2	2	2			
8.140 - CLUTCH PEDAL											
8-4-2	Pedal (L.H.D.).....	204231	All	1		1	1	1			
8-4-2	Pedal (L.H.D.).....	205696	492,496		1						
8-4-6	Key, No. 9 3/16" x 3/4".....	194	All	1	1	1	1	1			
8-4-5	Bolt, 3/8"-24 x 1 3/4" Hx. Hd.....	484	All	1	1	1	1	1			
8-4-7	Lockwasher, 3/8" Med.....	192	All	1	1	1	1	1			
8-4-8	Nut, 3/8"-24 Hx.....	188	All	1	1	1	1	1			
8-4-1	Pad (Black) (L.H.D.).....	204232	All	1	1	1	1	1			
8-4-1	Pad (Hickory Brown) (L.H.D.).....	204427	All	1	1	1	1	1			
8-4-1	Pad (Solar Gray) (L.H.D.).....	204428	All	1	1	1	1	1			
8-4-1	Pad (Emblem Blue) (L.H.D.).....	204429	492,495,496	1		1					
8-4-1	Pad (Maroon) (L.H.D.).....	204430	492,495,496	1							
8-4-1	Pad (Crystal Green) (L.H.D.).....	204431	All	1	1	1	1	1			
8-4-1	Pad (Teal Blue) (L.H.D.).....	204432	492,495,496	1		1					
8-4-3	Dust Seal.....	203473	All	2	2	2	2	2			
8-4-16	Spring, Pedal Return (L.H.D.).....	204234	All	1	1	1	1	1			
	Pedal (incl. Bushing) (R.H.D.).....	203468	491,495	1							
	Bushing (R.H.D.).....	203469	491,495	1							
	Thrustwasher (R.H.D.).....	203470	491,495	1							
	Lock Ring.....	203471	491,495	1							
	Oiler, 1/8" Taper Pipe Thd. x 3/4" Long (R.H.D.).....	202120	491,495	1							
	Pad (Black) (R.H.D.).....	203472	491,495	1							
	Pad (Hickory Brown) (R.H.D.).....	205911	491,495	1							
	Pad (Emblem Blue) (R.H.D.).....	205912	491,495	1							

* As required

CLUTCH and CONTROLS

FIGURE NUMBER	GROUP, PART NAME and DESCRIPTION	PART NUMBER	MODELS	BODY STYLES					
				4-DR. SEDAN	CONV.	VIRGINIAN	UTILITY	TAMICAB	
				1	2	3	5	6	
	8.140 - CLUTCH PEDAL (Cont'd)								
	Pad (Maroon) (R.H.D.).....	205913	491,495	1					
	Pad (Crystal Green) (R.H.D.).....	205914	491,495	1					
	Pad (Teal Blue) (R.H.D.).....	205915	491,495	1					
	Locknut 3/8"-24 Hx.....	639	491,495	1					
	Dust Seal.....	203473	491,495	1					
	Spring, Pedal Return (R.H.D.).....	201853	491,495	1					
	Bracket, Return Spring (R.H.D.).....	200225	491,495	1					
	Bolt, 1/4"-20 x 1/2" Hx. Hd. Tap.....	285	491,495	2					
	8.145 - CLUTCH PEDAL SHAFT								
8-4-25	Shaft (thru Frame) (L.H.D.).....	204235	All	1	1	1	1	1	
	Bushing (L.H.D.).....	204236	All	2	2	2	2	2	
8-4-23	Link, Adjusting (L.H.D.).....	204237	All	1	1	1	1	1	
8-4-24	Clevis (L.H.D.).....	204238	All	1	1	1	1	1	
8-4-21	Clevis Pin.....	204239	All	1	1	1	1	1	
8-4-22	Cotter Pin, 3/32 x 3/4".....	139	All	1	1	1	1	1	
	Shaft (R.H.D.).....	203474	491,495	1					
	Bolt, 3/8"-24 x 1" Hx. Hd.....	327	491,495	2					
	Lockwasher, 3/8" Med.....	192	491,495	2					
	8.150 - CLUTCH PEDAL TO CROSS SHAFT ADJUSTING LINK								
	Link (R.H.D.).....	201887	491,495	1					
	Clevis Pin.....	615	491,495	2					
	Cotter Pin.....	139	491,495	2					
	8.155 - CLUTCH PEDAL CROSS SHAFT								
8-4-15	Shaft (Frame to Clutch Housing) (L.H.D.).....	204240	All	1	1	1	1	1	
8-4-13	Pivot (incl. Bushing) (L.H.D.).....	204241	All	1	1	1	1	1	
8-4-9	Spacer, Pivot (L.H.D.).....	206121	All	1	1	1	1	1	
8-4-14	Dust Seal.....	201109	All	1	1	1	1	1	
8-4-20	Coupling (L.H.D.).....	204243	All	1	1	1	1	1	
8-4-17	Clevis Pin.....	204244	All	2	2	2	2	2	
8-4-18	Cotter Pin, 3/32" x 1/2".....	414	All	2	2	2	2	2	
	Shaft (R.H.D.).....	203475	491,495	1					
	Spring (R.H.D.).....	200234	491,495	1					
	Seat.....	200235	491,495	2					
	Washer (R.H.D.).....	200233	491,495	2					
	Dust Seal (R.H.D.).....	200230	491,495	2					
	Oiler, 1/4"-28 (R.H.D.).....	202121	491,495	1					
	Pivot (R.H.D.).....	200231	491,495	2					
	Lockwasher, 7/16" Med.....	193	491,495	2					
	Nut, 7/16"-20 Hx.....	187	491,495	2					
	Bracket (R.H.D.).....	203476	491,495	1					
	Bolt, 5/16"-18 x 3/4" Hx. Hd.....	183	491,495	3					
	Lockwasher, 5/16" Med.....	240	491,495	3					
	Bracket (to Frame) (R.H.D.).....	200236	491,495	1					
	Bolt, 3/8"-24 x 3/4" Hx. Hd.....	439	491,495	2					
	Lockwasher, 3/8" Med.....	192	491,495	2					

