

FIGURE 9-1 — TYPICAL TRANSMISSION - EXPLODED VIEW

FIGURE 9-1 — TYPICAL TRANSMISSION - EXPLODED VIEW

| KEY | PART NAME | GROUP | KEY | PART NAME | GROUP |
|-----|---|-------|-----|--|--------|
| 1 | Cover, Case..... | 9.007 | 33 | Oil Seal, Main Shaft..... | 9.145 |
| 2 | Gasket..... | 9.007 | 34 | Flange, Propeller Shaft Companion..... | 11.004 |
| 3 | Gear, Sliding, Low and Reverse..... | 9.135 | 35 | Flatwasher..... | 11.004 |
| 4 | Gear, Sliding, Second Speed Idler..... | 9.135 | 36 | Lockwasher..... | 11.004 |
| 5 | Blocking Ring, Second and High..... | 9.130 | 37 | Nut..... | 11.004 |
| 6 | Snap Ring, Shifting Plate..... | 9.130 | 38 | Shoe, Shifting, Low and Reverse..... | 9.185 |
| 7 | Hub, Second and High Synchronizer..... | 9.125 | 39 | Lever and Shaft, Shifting, Inner, Low and Reverse..... | 9.180 |
| 8 | Plate, Second and High Synchronizer Shifting..... | 9.130 | 40 | Spring, Shifting Lever Poppet Ball..... | 9.190 |
| 9 | Sleeve, Second and High Synchronizer..... | 9.130 | 41 | Pin, Shifting Lever Poppet Ball..... | 9.190 |
| 10 | Synchronizer Unit, Second and High..... | 9.125 | 42 | Flatwasher..... | 9.195 |
| 11 | Bearing, Main Shaft Roller..... | 9.120 | 43 | Lockwasher..... | 9.195 |
| 12 | Shaft, Transmission Main..... | 9.120 | 44 | Nut..... | 9.195 |
| 13 | Snap Ring, Second and High Synchronizer..... | 9.125 | 45 | Lever Assembly, Shifting, Outer, Low and Reverse..... | 9.195 |
| 14 | Thrustwasher, Countershaft Gear Cluster, Front..... | 9.155 | 46 | Ball, Shifting Lever Poppet..... | 9.190 |
| 15 | Gear Cluster, Countershaft..... | 9.155 | 47 | Sleeve, Shifting Lever Poppet Ball..... | 9.190 |
| 16 | Thrustwasher, Countershaft Gear Cluster, Rear..... | 9.155 | 48 | Insulator, Shifting Lever, Outer..... | 9.195 |
| 17 | Thrustwasher, Countershaft Gear Cluster, Rear..... | 9.155 | 49 | Lever Assembly, Shifting, Outer, Second and High..... | 9.195 |
| 18 | Washer, Countershaft Gear Bearing..... | 9.160 | 50 | Oil Seal, Shifting Lever, Inner..... | 9.180 |
| 19 | Spacer, Countershaft Gear Bearing..... | 9.160 | 51 | Lever and Shaft, Second and High..... | 9.180 |
| 20 | Bearing (Roller) Countershaft Gear..... | 9.160 | 52 | Fork, Shifting, Second and High..... | 9.185 |
| 21 | Countershaft..... | 9.165 | 53 | Pin..... | 9.180 |
| 22 | Bolt..... | 9.145 | 54 | Case Assembly..... | 9.005 |
| 23 | Lockwasher..... | 9.145 | 55 | Plug, Expansion..... | 9.005 |
| 24 | Lockplate, Reverse Idler Gear Shaft..... | 9.175 | 56 | Retainer, Drive Pinion Bearing..... | 9.115 |
| 25 | Shaft, Reverse Idler Gear..... | 9.175 | 57 | Snap Ring, Drive Pinion Bearing..... | 9.110 |
| 26 | Bushing, Reverse Idler Gear..... | 9.170 | 58 | Snap Ring, Drive Pinion Bearing..... | 9.110 |
| 27 | Gear Assembly, Reverse Idler..... | 9.170 | 59 | Bearing, Drive Pinion..... | 9.105 |
| 28 | Snap Ring, Main Shaft Bearing..... | 9.140 | 60 | Slinger, Drive Pinion Bearing..... | 9.105 |
| 29 | Bearing, Main Shaft..... | 9.140 | 61 | Not Serviced Separately (See Item 64)..... | |
| 30 | Gasket, Main Shaft Bearing Retainer..... | 9.145 | 62 | Gasket, Drive Pinion Bearing Retainer..... | 9.117 |
| 31 | Retainer, Main Shaft Bearing..... | 9.145 | 63 | Plug, Filler and Drain..... | 9.005 |
| 32 | Gear, Speedometer Drive..... | 9.286 | 64 | Pinion Assembly, Drive..... | 9.100 |

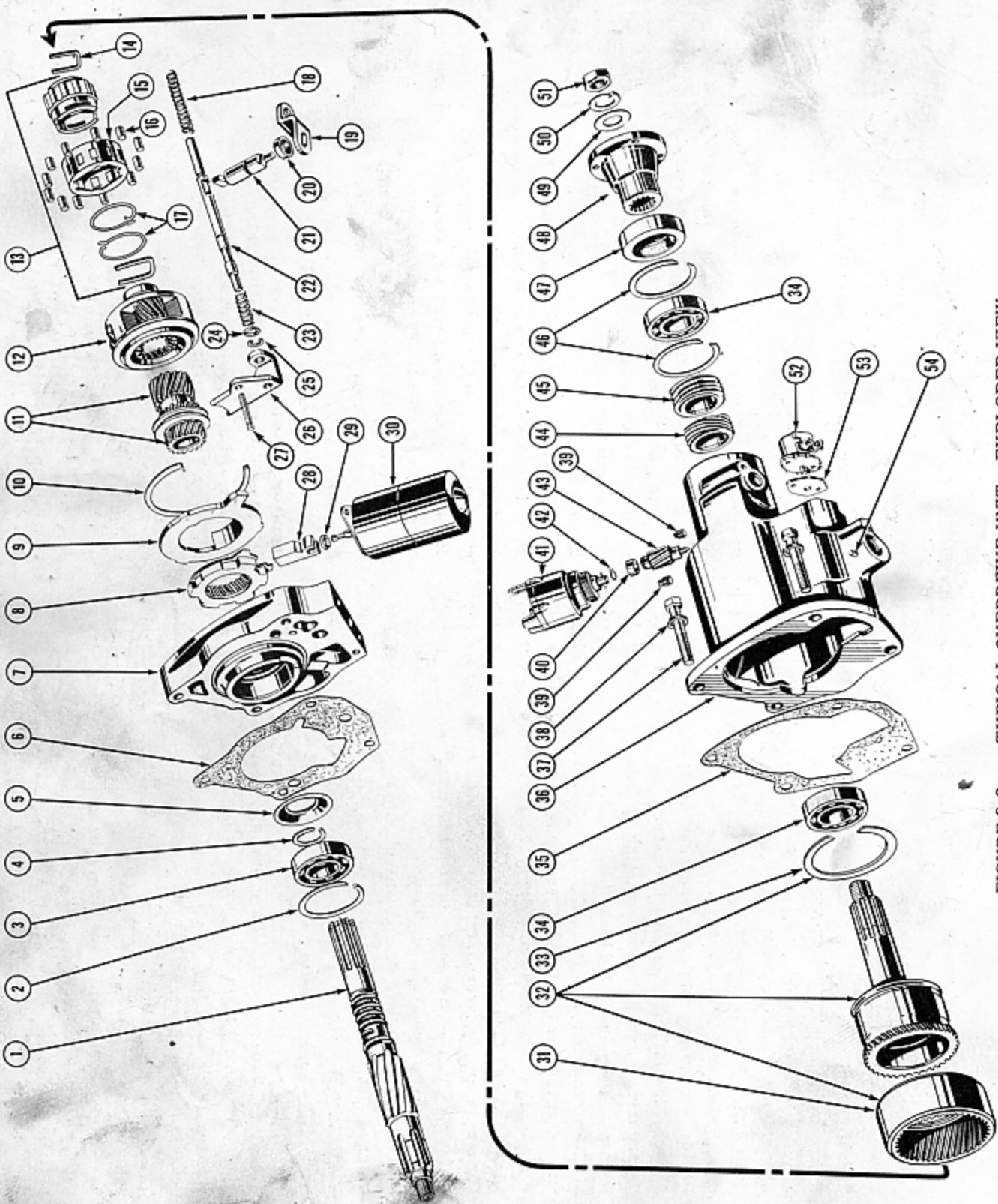

FIGURE 9-2 — TYPICAL OVERDRIVE UNIT - EXPLODED VIEW

FIGURE 9-2 — TYPICAL OVERDRIVE UNIT - EXPLODED VIEW

| KEY | PART NAME | GROUP | KEY | PART NAME | GROUP |
|-----|---|-------|-----|---|--------|
| 1 | Shaft, Overdrive Transmission..... | 9.120 | 28 | Pawl, Stationary Gear..... | 9.210 |
| 2 | Snap Ring, Main Shaft Bearing..... | 9.140 | 29 | Oil Seal, Solenoid..... | 7.800 |
| 3 | Bearing, Main Shaft..... | 9.140 | 30 | Solenoid..... | 7.800 |
| 4 | Snap Ring, Main Shaft Bearing..... | 9.140 | 31 | Ring Gear..... | 9.245 |
| 5 | Baffle, Main Shaft Bearing..... | 9.140 | 32 | Main Shaft Assembly..... | 9.235 |
| 6 | Gasket, Overdrive Adapter to Transmission Case... | 9.145 | 33 | Snap Ring, Ring Gear..... | 9.245 |
| 7 | Adapter, Overdrive Housing..... | 9.145 | 34 | Bearing, Main Shaft..... | 9.240 |
| 8 | Gear and Blocking Ring, Stationary..... | 9.205 | 35 | Gasket, Housing to Adapter..... | 9.200 |
| 9 | Plate, Stationary Gear Cover..... | 9.215 | 36 | Housing..... | 9.200 |
| 10 | Snap Ring, Stationary Gear Cover Plate..... | 9.215 | 37 | Bolt..... | 9.200 |
| 11 | Gear, Stationary..... | 9.210 | 38 | Lockwasher..... | 9.200 |
| 12 | Cage Assembly, Stationary Gear Pinion..... | 9.220 | 39 | Plug, Filler and Drain..... | 9.200 |
| 13 | Cam Assembly, Free Wheeling..... | 9.225 | 40 | Sleeve, Governor Pinion..... | 9.265 |
| 14 | Clip, Free Wheeling Cam..... | 9.225 | 41 | Governor..... | 9.265 |
| 15 | Retainer, Free Wheeling Cam Bearing..... | 9.230 | 42 | Retainer, Governor Pinion Sleeve..... | 9.265 |
| 16 | Bearing, Free Wheeling Cam, Roller..... | 9.230 | 43 | Pinion, Governor..... | 9.265 |
| 17 | Spring, Free Wheeling Cam Bearing Retainer..... | 9.230 | 44 | Gear, Governor..... | 9.265 |
| 18 | Spring, Shift Control Shaft, Retractor..... | 9.255 | 45 | Gear, Speedometer Drive..... | 9.286 |
| 19 | Lever, Control Shaft..... | 9.260 | 46 | Snap Ring, Main Shaft Bearing..... | 9.240 |
| 20 | Oil Seal, Shift Control Shaft..... | 9.255 | 47 | Oil Seal, Main Shaft..... | 9.235 |
| 21 | Shaft, Shift Control..... | 9.255 | 48 | Flange, Propeller Shaft Companion, Front..... | 11.004 |
| 22 | Rail, Overdrive Shift Fork..... | 9.250 | 49 | Flatwasher..... | 11.004 |
| 23 | Spring, Shift Control Shaft, Lock Up..... | 9.255 | 50 | Lockwasher..... | 11.004 |
| 24 | Cup, Shift Control Shaft Lock Up Spring..... | 9.250 | 51 | Nut..... | 11.004 |
| 25 | "C" Washer, Shift Fork..... | 9.250 | 52 | Switch, Shift Fork Rail..... | 7.802 |
| 26 | Fork, Shift..... | 9.250 | 53 | Gasket, Shift Fork Rail Switch..... | 7.802 |
| 27 | Guide, Shift Fork..... | 9.250 | 54 | Pin, Shift Control Shaft..... | 9.255 |

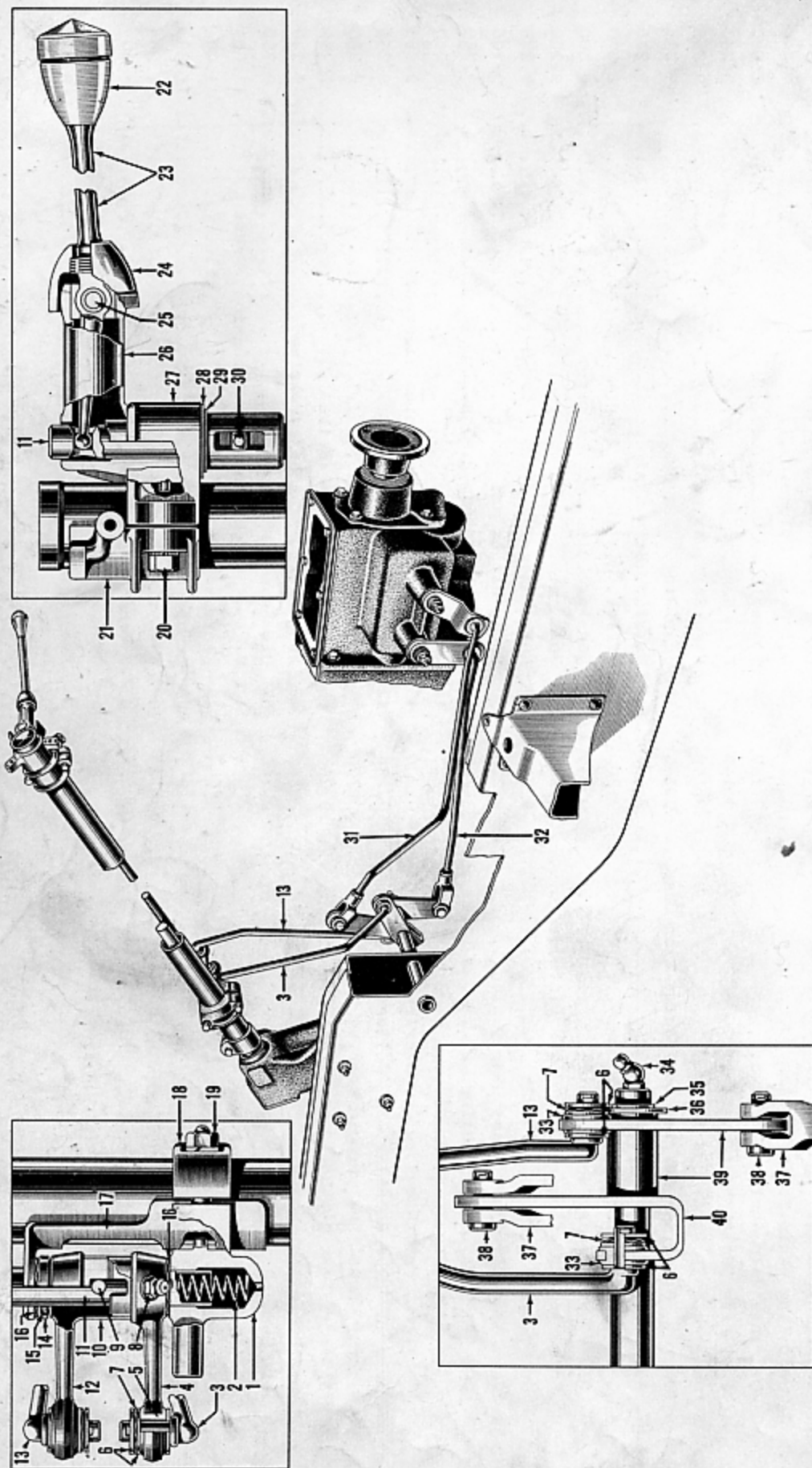

FIGURE 9-3 — TYPICAL TRANSMISSION GEAR SHIFT CONTROL - CROSS SECTIONAL VIEW

FIGURE 9-3 — TYPICAL TRANSMISSION GEAR SHIFT CONTROL - CROSS SECTIONAL VIEW

| KEY | PART NAME | GROUP | KEY | PART NAME | GROUP |
|-----|------------------------------------|-------|-----|--|-------|
| 1 | Bracket, Shaft, Lower..... | 9.335 | 22 | Knob, Lever..... | 9.300 |
| 2 | Spring, Shaft..... | 9.310 | 23 | Lever, Upper..... | 9.300 |
| 3 | Rod, Upper, Low and Reverse..... | 9.340 | 24 | Cap, Lever..... | 9.300 |
| 4 | Lever, Lower, Low and Reverse..... | 9.320 | 25 | Pin, Lever..... | 9.300 |
| 5 | Insulator, Lever, Lower..... | 9.320 | 26 | Guide, Shaft..... | 9.310 |
| 6 | Flatwasher, Rod Insulator..... | 9.340 | 27 | Bracket, Shaft, Upper..... | 9.315 |
| 7 | Springwasher, Rod Insulator..... | 9.340 | 28 | Flatwasher, Guide to Upper Bracket..... | 9.310 |
| 8 | Oiler, Lever, Lower..... | 9.320 | 29 | Snap Ring, Guide to Upper Bracket..... | 9.310 |
| 9 | Pin, Shaft, Lower..... | 9.310 | 30 | Pin, Shaft to Guide..... | 9.310 |
| 10 | Cover..... | 9.320 | 31 | Rod, Lower, Low and Reverse..... | 9.340 |
| 11 | Shaft..... | 9.310 | 32 | Rod, Lower, Second and High..... | 9.340 |
| 12 | Lever, Lower, Second and High..... | 9.320 | 33 | Insulator, Rod..... | 9.340 |
| 13 | Rod, Upper, Second and High..... | 9.340 | 34 | Oiler, Rod Bellcrank..... | 9.345 |
| 14 | Retainer, Lever Seal, Lower..... | 9.320 | 35 | Snap Ring, Rod Bellcrank..... | 9.345 |
| 15 | Seal, Lever, Lower..... | 9.320 | 36 | Thrustwasher, Rod Bellcrank..... | 9.345 |
| 16 | Springwasher, Lever..... | 9.320 | 37 | Clevis, Lower Rod..... | 9.340 |
| 17 | Retainer, Lower Lever..... | 9.330 | 38 | Clevis Pin, Lower Rod..... | 9.340 |
| 18 | Cap, Lower Bracket..... | 9.335 | 39 | Bellcrank, Rod, Second and High..... | 9.345 |
| 19 | Bolt, Bracket Cap..... | 9.335 | 40 | Bellcrank, Transmission Gear Shift Rod, Low and Reverse..... | 9.345 |
| 20 | Bolt, Upper Bracket..... | 9.315 | | | |
| 21 | Cap, Upper Bracket..... | 9.315 | | | |

TRANSMISSION

| FIGURE NUMBER | GROUP, PART NAME and DESCRIPTION | PART NUMBER | MODELS | BODY STYLES | | | | | |
|---------------|---|-------------|--------|-------------|-------|-----------|---------|---------|--|
| | | | | 4-DR. SEDAN | CONV. | VIRGINIAN | UTILITY | TAXICAB | |
| | | | | 1 | 2 | 3 | 5 | 6 | |
| | 9.000 - TRANSMISSION | | | | | | | | |
| | Transmission, Std. 3.73, 3.91, 4.09, 4.27 Ratio..... | 204842 | All | 1 | 1 | 1 | 1 | | |
| | Transmission, Std. 4.55 Ratio..... | 205653 | All | 1 | 1 | 1 | 1 | | |
| | Transmission, Std. (with Taximeter Outlet) 4.09 Ratio..... | 205793 | 491 | | | | | 1 | |
| | Transmission, Overdrive 4.27 Ratio..... | 204843 | All | 1 | 1 | 1 | 1 | | |
| | Transmission, Overdrive 4.55 Ratio..... | 205652 | All | 1 | 1 | 1 | 1 | | |
| | Bolt, 7/16"-14 x 1 1/4" Hx. Hd..... | 265 | All | 4 | 4 | 4 | 4 | 4 | |
| | Lockwasher, 7/16" Med..... | 193 | All | 4 | 4 | 4 | 4 | 4 | |
| | NOTE: Only the above listed Transmissions will be furnished for replacement. In replacing a R.H.D. Transmission, Outer Shifting Levers from old Transmission must be installed on new unit. | | | | | | | | |
| | 9.003 - TRANSMISSION REPAIR KIT | | | | | | | | |
| 60-29 † | Small Parts Kit..... | 206536 | All | 1 | 1 | 1 | 1 | 1 | |
| 60-30 † | Gasket Set..... | 206537 | All | 1 | 1 | 1 | 1 | 1 | |
| | 9.005 - TRANSMISSION CASE | | | | | | | | |
| 9-1-54 | Case, Std. (incl. Plug)..... | 201268 | All | 1 | 1 | 1 | 1 | 1 | |
| | Case, Overdrive (incl. Plug)..... | 201269 | All | 1 | 1 | 1 | 1 | 1 | |
| 9-1-63 | Plug, Filler and Drain, 1/2" Sq. Hd..... | 201270 | All | 2 | 2 | 2 | 2 | 2 | |
| 9-1-55 | Plug, Expansion, 13/16" Diam. 1/16" Thick.... | 672 | All | 1 | 1 | 1 | 1 | 1 | |
| | 9.007 - TRANSMISSION CASE COVER | | | | | | | | |
| 9-1-1 | Cover..... | 201272 | All | 1 | 1 | 1 | 1 | 1 | |
| | Bolt, 5/16"-18 x 5/8" Hx. Hd..... | 208 | All | 6 | 6 | 6 | 6 | 6 | |
| | Lockwasher, 5/16" Med..... | 240 | All | 6 | 6 | 6 | 6 | 6 | |
| 9-1-2 | Gasket..... | 201275 | All | 1 | 1 | 1 | 1 | 1 | |
| | 9.100 - TRANSMISSION DRIVE PINION | | | | | | | | |
| 9-1-64 | Pinion (incl. Bearing)..... | 201273 | All | 1 | 1 | 1 | 1 | | |
| | Pinion (incl. Bearing)..... | 205794 | 491 | | | | | 1 | |
| | Bushing (in Crankshaft)..... | 200064 | All | 1 | 1 | 1 | 1 | 1 | |
| | 9.105 - TRANSMISSION DRIVE PINION BEARING | | | | | | | | |
| 9-1-59 | Bearing..... | 201274 | All | 1 | 1 | 1 | 1 | | |
| | Bearing..... | 205795 | 491 | | | | | 1 | |
| 9-1-60 | Slinger..... | 201287 | All | 1 | 1 | 1 | 1 | 1 | |
| | 9.110 - TRANSMISSION DRIVE PINION BEARING SNAP RING | | | | | | | | |
| 9-1-58 | Snap Ring, .0625 Thick, 2 11/16" I.D..... | 201286 | All | 1 | 1 | 1 | 1 | 1 | |
| 9-1-57 | Snap Ring, .086 Thick, 1 15/64" I.D..... | 201282 | All | * | * | * | * | * | |
| 9-1-57 | Snap Ring, .089 Thick, 1 15/64" I.D..... | 201283 | All | * | * | * | * | * | |
| 9-1-57 | Snap Ring, .092 Thick, 1 15/16" I.D..... | 201284 | All | * | * | * | * | * | |
| 9-1-57 | Snap Ring, .095 Thick, 1 15/16" I.D..... | 201285 | All | * | * | * | * | * | |

* As required † For Component Parts SEE Group 60.9

TRANSMISSION

9

| FIGURE NUMBER | GROUP, PART NAME and DESCRIPTION | PART NUMBER | MODELS | BODY STYLES | | | | | |
|--|---|-------------|--------|-------------|-------|-----------|---------|---------|--|
| | | | | 4-DR. SEDAN | CONV. | VIRGINIAN | UTILITY | TAXICAB | |
| | | | | 1 | 2 | 3 | 5 | 6 | |
| 9.115 - TRANSMISSION DRIVE PINION BEARING RETAINER | | | | | | | | | |
| 9-1-56 | Retainer..... | 201276 | All | 1 | 1 | 1 | 1 | 1 | |
| | Bolt, 5/16"-18 x 7/8" Hx. Hd..... | 201277 | All | 3 | 3 | 3 | 3 | 3 | |
| | Lockwasher, 5/16" Med..... | 240 | All | 3 | 3 | 3 | 3 | 3 | |
| 9.117 - TRANSMISSION DRIVE PINION BEARING RETAINER GASKET | | | | | | | | | |
| 9-1-62 | Gasket, .009..... | 201278 | All | * | * | * | * | * | |
| 9-1-62 | Gasket, .0135..... | 201279 | All | * | * | * | * | * | |
| 9-1-62 | Gasket, .018..... | 201280 | All | * | * | * | * | * | |
| 9-1-62 | Gasket, .025..... | 201281 | All | * | * | * | * | * | |
| 9.120 - TRANSMISSION MAIN SHAFT | | | | | | | | | |
| | Shaft, Std. Trans.... {incl. Synchronizer}.... | 201288 | All | 1 | 1 | 1 | 1 | | |
| | Shaft, Std. Trans.... {Unit, Second Speed}.... | 205796 | 491 | | | | | 1 | |
| | Shaft, Overdrive {Idler, Low and Reverse Gear}.... | 201289 | All | 1 | 1 | 1 | 1 | | |
| 9-1-12 | Shaft, Std. Trans..... | 201290 | All | 1 | 1 | 1 | 1 | | |
| | Shaft, Std. Trans..... | 205797 | 491 | | | | | 1 | |
| 9-2-1 | Shaft, Overdrive Trans..... | 201291 | All | 1 | 1 | 1 | 1 | | |
| 9-1-11 | Bearing, Roller..... | 201292 | All | 14 | 14 | 14 | 14 | 14 | |
| 9.125 - TRANSMISSION SECOND AND HIGH SYNCHRONIZER | | | | | | | | | |
| 9-1-10 | Synchronizer Unit (incl. Hub, Sleeve, Shifting Plate and Snap Rings)..... | 201293 | All | 1 | 1 | 1 | 1 | 1 | |
| 9-1-7 | Hub..... | 201294 | All | 1 | 1 | 1 | 1 | 1 | |
| 9-1-13 | Snap Ring..... | 201282 | All | 1 | 1 | 1 | 1 | 1 | |
| 9.130 - TRANSMISSION SECOND AND HIGH SYNCHRONIZER SLEEVE | | | | | | | | | |
| 9-1-9 | Sleeve..... | 201295 | All | 1 | 1 | 1 | 1 | 1 | |
| 9-1-8 | Plate, Shifting..... | 201296 | All | 3 | 3 | 3 | 3 | 3 | |
| 9-1-6 | Snap Ring..... | 201297 | All | 2 | 2 | 2 | 2 | 2 | |
| 9-1-5 | Blocking Ring..... | 201298 | All | 2 | 2 | 2 | 2 | 2 | |
| 9.135 - TRANSMISSION SLIDING GEAR | | | | | | | | | |
| 9-1-4 | Gear, Second Speed Idler (incl. Bushing).... | 201299 | All | 1 | 1 | 1 | 1 | 1 | |
| 9-1-3 | Gear, Low and Reverse..... | 201300 | All | 1 | 1 | 1 | 1 | | |
| | Gear, Low and Reverse..... | 205798 | 491 | | | | | 1 | |
| 9.140 - TRANSMISSION MAIN SHAFT BEARING | | | | | | | | | |
| 9-1-29 | Bearing..... | 201301 | All | 1 | 1 | 1 | 1 | | |
| | Bearing..... | 205799 | 491 | | | | | 1 | |
| 9-1-28 | Snap Ring, .086 Thick, 2 31/32" O.D..... | 201302 | All | * | * | * | * | * | |
| 9-1-28 | Snap Ring, .089 Thick, 2 31/32" O.D..... | 201303 | All | * | * | * | * | * | |
| 9-1-28 | Snap Ring, .092 Thick, 2 31/32" O.D..... | 201304 | All | * | * | * | * | * | |
| 9-1-28 | Snap Ring, .095 Thick, 2 31/32" O.D..... | 201305 | All | * | * | * | * | * | |

* As required

TRANSMISSION

| FIGURE NUMBER | GROUP, PART NAME and DESCRIPTION | PART NUMBER | MODELS | BODY STYLES | | | | | |
|---------------|---|-------------|---------------|-------------|-------|-----------|---------|---------|----|
| | | | | 4-DR. SEDAN | CONV. | VIRGINIAN | UTILITY | TAMICAB | |
| | | | | 1 | 2 | 3 | 5 | 6 | |
| | 9.140 - TRANSMISSION MAIN SHAFT BEARING (Cont'd) | | | | | | | | |
| 9-2-4 | Snap Ring, .086 Thick, 1 15/64" I.D..... | 201282 | All | * | * | * | * | | |
| 9-2-4 | Snap Ring, .089 Thick, 1 15/64" I.D..... | 201283 | All | * | * | * | * | | |
| 9-2-4 | Snap Ring, .092 Thick, 1 15/64" I.D..... | 201284 | All | * | * | * | * | | |
| 9-2-4 | Snap Ring, .095 Thick, 1 15/64" I.D..... | 201285 | All | * | * | * | * | | |
| 9-2-5 | Baffle..... | 201306 | All | 1 | 1 | 1 | 1 | | |
| | 9.145 - TRANSMISSION MAIN SHAFT BEARING RETAINER AND ADAPTER | | | | | | | | |
| 9-1-31 | Retainer, Std. Trans..... | 201307 | All | 1 | 1 | 1 | 1 | | |
| | Retainer, Std. Trans. (incl. Pinion Bushings) | 205800 | 491 | | | | | | 1 |
| 9-1-22 | Bolt, 3/8"-16 x 7/8" Hx. Hd..... | 268 | All | * | * | * | * | | * |
| 9-1-22 | Bolt, 3/8"-16 x 1 1/8" Hx. Hd..... | 182 | All | 2 | 2 | 2 | 2 | | |
| | Bolt, 3/8"-16 x 1 7/8" Hx. Hd..... | 717 | 491 | | | | | | 1 |
| 9-1-23 | Lockwasher, 3/8" Ext. Tooth..... | 291 | All | 4 | 4 | 4 | 4 | 4 | 4 |
| 9-1-30 | Gasket, Std. Trans..... | 201309 | All | 1 | 1 | 1 | 1 | 1 | 1 |
| 9-1-33 | Oil Seal, Std. Trans..... | 201311 | All | 1 | 1 | 1 | 1 | 1 | 1 |
| 9-2-7 | Adapter, Overdrive Housing..... | 201308 | 492, 495, 496 | 1 | 1 | 1 | 1 | | |
| 9-2-6 | Gasket, Overdrive Adapter to Trans. Case..... | 200895 | 492, 495, 496 | 1 | 1 | 1 | 1 | | |
| | 9.155 - TRANSMISSION COUNTERSHAFT GEAR CLUSTER | | | | | | | | |
| 9-1-15 | Gear Cluster..... | 201313 | All | 1 | 1 | 1 | 1 | | |
| | Gear Cluster..... | 205801 | 491 | | | | | | 1 |
| 9-1-14 | Thrustwasher, Front (Bronze)..... | 201314 | All | 1 | 1 | 1 | 1 | 1 | 1 |
| 9-1-16 | Thrustwasher, Rear (1 15/16" O.D.)..... | 201315 | All | 1 | 1 | 1 | 1 | 1 | 1 |
| 9-1-17 | Thrustwasher, Rear (1 29/32" O.D.)..... | 201316 | All | 1 | 1 | 1 | 1 | 1 | 1 |
| | 9.160 - TRANSMISSION COUNTERSHAFT GEAR BEARINGS | | | | | | | | |
| 9-1-20 | Bearing (Roller)..... | 201317 | All | 44 | 44 | 44 | 44 | 44 | 44 |
| 9-1-19 | Spacer..... | 201318 | All | 1 | 1 | 1 | 1 | 1 | 1 |
| 9-1-18 | Washer..... | 201319 | All | 2 | 2 | 2 | 2 | 2 | 2 |
| | 9.165 - TRANSMISSION COUNTERSHAFT | | | | | | | | |
| 9-1-21 | Countershaft..... | 201312 | All | 1 | 1 | 1 | 1 | 1 | 1 |
| | 9.170 - TRANSMISSION REVERSE IDLER GEAR | | | | | | | | |
| 9-1-27 | Gear (incl. Bushing)..... | 201320 | All | 1 | 1 | 1 | 1 | | |
| | Gear (incl. Bushing)..... | 205815 | 491 | | | | | | 1 |
| 9-1-26 | Bushing..... | 201321 | All | 1 | 1 | 1 | 1 | 1 | 1 |

* As required

TRANSMISSION

9

| FIGURE NUMBER | GROUP, PART NAME and DESCRIPTION | PART NUMBER | MODELS | BODY STYLES | | | | | | |
|---------------|--|-------------|-------------|-------------|-------|-----------|---------|---------|---|--|
| | | | | 4-DR. SEDAN | CONV. | VIRGINIAN | UTILITY | TAMICAB | | |
| | | | | 1 | 2 | 3 | 5 | 6 | | |
| | 9.175 - TRANSMISSION REVERSE IDLER GEAR SHAFT | | | | | | | | | |
| 9-1-25 | Shaft..... | 201322 | All | 1 | 1 | 1 | 1 | 1 | 1 | |
| 9-1-24 | Lockplate..... | 201323 | All | 1 | 1 | 1 | 1 | 1 | 1 | |
| | 9.180 - TRANSMISSION SHIFTING LEVER-INNER | | | | | | | | | |
| 9-1-51 | Lever and Shaft, Second and High..... | 204845 | All | 1 | 1 | 1 | 1 | 1 | 1 | |
| 9-1-39 | Lever and Shaft, Low and Reverse..... | 204844 | All | 1 | 1 | 1 | 1 | 1 | 1 | |
| 9-1-53 | Pin..... | 201327 | All | 2 | 2 | 2 | 2 | 2 | 2 | |
| 9-1-50 | Oil Seal..... | 200903 | All | 2 | 2 | 2 | 2 | 2 | 2 | |
| | 9.185 - TRANSMISSION SHIFTING FORK AND SHOE | | | | | | | | | |
| 9-1-52 | Fork, Second and High..... | 201325 | All | 1 | 1 | 1 | 1 | 1 | 1 | |
| 9-1-38 | Shoe, Low and Reverse..... | 201324 | All | 1 | 1 | 1 | 1 | 1 | 1 | |
| | 9.190 - TRANSMISSION SHIFTING LEVER POPPET BALL | | | | | | | | | |
| 9-1-46 | Ball..... | 201329 | All | 2 | 2 | 2 | 2 | 2 | 2 | |
| 9-1-40 | Spring..... | 201330 | All | 1 | 1 | 1 | 1 | 1 | 1 | |
| 9-1-41 | Pin (grooved)..... | 204846 | All | 1 | 1 | 1 | 1 | 1 | 1 | |
| 9-1-47 | Sleeve (not marked) 1.299 Long..... | 201331 | All | * | * | * | * | * | * | |
| 9-1-47 | Sleeve (marked "A") 1.295 Long..... | 201332 | All | * | * | * | * | * | * | |
| 9-1-47 | Sleeve (marked "B") 1.291 Long..... | 201333 | All | * | * | * | * | * | * | |
| 9-1-47 | Sleeve (marked "C") 1.287 Long..... | 201334 | All | * | * | * | * | * | * | |
| 9-1-47 | Sleeve (marked "D") 1.303 Long..... | 201335 | All | * | * | * | * | * | * | |
| | 9.195 - TRANSMISSION SHIFTING LEVER-OUTER | | | | | | | | | |
| 9-1-49 | Lever, Second and High (incl. Insulator) (L.H.D.)..... | 204884 | All | 1 | 1 | 1 | 1 | 1 | 1 | |
| 9-1-45 | Lever, Low and Reverse (L.H.D.)..... | 204885 | All | 1 | 1 | 1 | 1 | 1 | 1 | |
| | Lever, Second and High (incl. Insulator) (R.H.D.)..... | 203510 | 491,495 | 1 | | | | | | |
| | Lever, Low and Reverse (incl. Insulator) (R.H.D.)..... | 203509 | 491,495 | 1 | | | | | | |
| 9-1-42 | Flatwasher, 5/16"..... | 201339 | All | 2 | 2 | 2 | 2 | 2 | 2 | |
| 9-1-43 | Lockwasher, 5/16" Med..... | 240 | All | 2 | 2 | 2 | 2 | 2 | 2 | |
| 9-1-44 | Nut, 5/16"-18 Hx..... | 205 | All | 2 | 2 | 2 | 2 | 2 | 2 | |
| 9-1-48 | Insulator..... | 201340 | All | 1 | 1 | 1 | 1 | 1 | 1 | |
| | 9.200 - TRANSMISSION OVERDRIVE HOUSING | | | | | | | | | |
| 9-2-36 | Housing..... | 200865 | 492,495,496 | 1 | 1 | 1 | 1 | 1 | 1 | |
| 9-2-37 | Bolt, 7/16"-14 x 2 1/2" Hx. Hd..... | 200866 | 492,495,496 | 4 | 4 | 4 | 4 | 4 | 4 | |
| 9-2-38 | Lockwasher, 7/16" Med..... | 193 | 492,495,496 | 4 | 4 | 4 | 4 | 4 | 4 | |
| 9-2-35 | Gasket (to Adapter)..... | 201310 | 492,495,496 | 1 | 1 | 1 | 1 | 1 | 1 | |
| 9-2-39 | Plug, Filler and Drain, 3/8" Pipe Sq. Hd..... | 121 | 492,495,496 | 2 | 2 | 2 | 2 | 2 | 2 | |
| | NOTE: For Transmission Main Shaft Bearing Retainer and Adapter SEE Group 9.145 | | | | | | | | | |

* As required

TRANSMISSION

| FIGURE NUMBER | GROUP, PART NAME and DESCRIPTION | PART NUMBER | MODELS | BODY STYLES | | | | |
|---------------|--|-------------|-------------|-------------|-------|-----------|---------|---------|
| | | | | 4-DR. SEDAN | CONV. | VIRGINIAN | UTILITY | TAXICAB |
| | | | | 1 | 2 | 3 | 5 | 6 |
| | 9.205 - TRANSMISSION OVERDRIVE GEAR AND BLOCKING RING-STATIONARY | | | | | | | |
| 9-2-8 | Gear and Blocking Ring..... | 200870 | 492,495,496 | 1 | 1 | 1 | 1 | |
| | Blocking Ring..... | 200876 | 492,495,496 | 1 | 1 | 1 | 1 | |
| | 9.210 - TRANSMISSION OVERDRIVE STATIONARY GEAR | | | | | | | |
| 9-2-11 | Gear (incl. Shifting Collar and Snap Rings).. | 200871 | 492,495,496 | 1 | 1 | 1 | 1 | |
| | Snap Ring (1 15/32" I.D.)..... | 200872 | 492,495,496 | 2 | 2 | 2 | 2 | |
| | Gear..... | 200873 | 492,495,496 | 1 | 1 | 1 | 1 | |
| | Collar..... | 200874 | 492,495,496 | 1 | 1 | 1 | 1 | |
| 9-2-28 | Pawl (grooved)..... | 204847 | 492,495,496 | 1 | 1 | 1 | 1 | |
| | 9.215 - TRANSMISSION OVERDRIVE STATIONARY GEAR COVER PLATE | | | | | | | |
| 9-2-9 | Plate..... | 200877 | 492,495,496 | 1 | 1 | 1 | 1 | |
| 9-2-10 | Snap Ring, .0625 Thick..... | 200878 | 492,495,496 | * | * | * | * | |
| 9-2-10 | Snap Ring, .0705 Thick..... | 200879 | 492,495,496 | * | * | * | * | |
| 9-2-10 | Snap Ring, .0665 Thick..... | 200880 | 492,495,496 | * | * | * | * | |
| | 9.220 - TRANSMISSION OVERDRIVE STATIONARY GEAR PINION CAGE | | | | | | | |
| 9-2-12 | Cage (incl. Pinions, Shafts, Pins, Oil Ring, Bearing Rollers and Spacers)..... | 200882 | 492,495,496 | 1 | 1 | 1 | 1 | |
| | 9.225 - TRANSMISSION OVERDRIVE FREE WHEELING CAM | | | | | | | |
| 9-2-13 | Cam (incl. Rollers, Retainer, Spring and Cage Clips)..... | 200883 | 492,495,496 | 1 | 1 | 1 | 1 | |
| 9-2-14 | Clip (Cam to Shaft)..... | 200884 | 492,495,496 | 1 | 1 | 1 | 1 | |
| | 9.230 - TRANSMISSION OVERDRIVE FREE WHEELING CAM BEARING | | | | | | | |
| 9-2-16 | Bearing, Roller..... | 200885 | 492,495,496 | 12 | 12 | 12 | 12 | |
| 9-2-15 | Retainer..... | 200886 | 492,495,496 | 1 | 1 | 1 | 1 | |
| 9-2-17 | Spring..... | 200888 | 492,495,496 | 2 | 2 | 2 | 2 | |
| | 9.235 - TRANSMISSION OVERDRIVE MAIN SHAFT | | | | | | | |
| 9-2-32 | Shaft (incl. Ring Gear and Snap Rings)..... | 200889 | 492,495,496 | 1 | 1 | 1 | 1 | |
| 9-2-47 | Oil Seal..... | 201311 | 492,495,496 | 1 | 1 | 1 | 1 | |
| | 9.240 - TRANSMISSION OVERDRIVE MAIN SHAFT BEARING | | | | | | | |
| 9-2-34 | Bearing..... | 200893 | 492,495,496 | 2 | 2 | 2 | 2 | |
| 9-2-46 | Snap Ring, .062 Thick..... | 201395 | 492,495,496 | * | * | * | * | |
| 9-2-46 | Snap Ring, .065 Thick..... | 201396 | 492,495,496 | * | * | * | * | |
| 9-2-46 | Snap Ring, .068 Thick..... | 201397 | 492,495,496 | * | * | * | * | |
| 9-2-46 | Snap Ring, .071 Thick..... | 201398 | 492,495,496 | * | * | * | * | |

* As required

TRANSMISSION

9

| FIGURE NUMBER | GROUP, PART NAME and DESCRIPTION | PART NUMBER | MODELS | BODY STYLES | | | | | | |
|---------------|--|-------------|-------------|-------------|-------|-----------|---------|---------|--|--|
| | | | | 4-DR. SEDAN | CONV. | VIRGINIAN | UTILITY | TAN/CAB | | |
| | | | | 1 | 2 | 3 | 5 | 6 | | |
| | 9.245 - TRANSMISSION OVERDRIVE RING GEAR | | | | | | | | | |
| 9-2-31 | Ring Gear..... | 200891 | 492,495,496 | 1 | 1 | 1 | 1 | | | |
| 9-2-33 | Snap Ring, .062 Thick..... | 200892 | 492,495,496 | * | * | * | * | | | |
| | 9.250 - TRANSMISSION OVERDRIVE SHIFT FORK | | | | | | | | | |
| 9-2-26 | Fork..... | 204848 | 492,495,496 | 1 | 1 | 1 | 1 | | | |
| 9-2-22 | Rail..... | 204849 | 492,495,496 | 1 | 1 | 1 | 1 | | | |
| 9-2-27 | Guide..... | 200901 | 492,495,496 | 1 | 1 | 1 | 1 | | | |
| 9-2-25 | "C" Washer..... | 204850 | 492,495,496 | 1 | 1 | 1 | 1 | | | |
| 9-2-24 | Cup..... | 204855 | 492,495,496 | 1 | 1 | 1 | 1 | | | |
| | 9.255 - TRANSMISSION OVERDRIVE SHIFT CONTROL SHAFT | | | | | | | | | |
| 9-2-21 | Shaft..... | 200902 | 492,495,496 | 1 | 1 | 1 | 1 | | | |
| 9-2-54 | Pin, 5/32" x 1 1/4" Taper..... | 201327 | 492,495,496 | 1 | 1 | 1 | 1 | | | |
| 9-2-23 | Spring, Lockup..... | 204856 | 492,495,496 | 1 | 1 | 1 | 1 | | | |
| 9-2-18 | Spring, Retractor..... | 200900 | 492,495,496 | 1 | 1 | 1 | 1 | | | |
| 9-2-20 | Oil Seal..... | 200903 | 492,495,496 | 1 | 1 | 1 | 1 | | | |
| | 9.260 - TRANSMISSION OVERDRIVE CONTROL SHAFT LEVER | | | | | | | | | |
| 9-2-19 | Lever..... | 203544 | 492,495,496 | 1 | 1 | 1 | 1 | | | |
| | Flatwasher..... | 201339 | 492,495,496 | 1 | 1 | 1 | 1 | | | |
| | Lockwasher, 5/16" Med..... | 240 | 492,495,496 | 1 | 1 | 1 | 1 | | | |
| | Nut, 5/16"-18 Hx..... | 205 | 492,495,496 | 1 | 1 | 1 | 1 | | | |
| | 9.261 - TRANSMISSION OVERDRIVE CONTROL SHAFT LEVER SWIVEL | | | | | | | | | |
| | Swivel..... | 202189 | 492,495,496 | 1 | 1 | 1 | 1 | | | |
| | Flatwasher, 3/8" Sm..... | 247 | 492,495,496 | 1 | 1 | 1 | 1 | | | |
| | Cotter Pin, 3/32" x 5/8"..... | 139 | 492,495,496 | 1 | 1 | 1 | 1 | | | |
| | Set Screw, No. 10-24 x 3/8" Soc. Hd. Cup Pt.. | 517 | 492,495,496 | 1 | 1 | 1 | 1 | | | |
| | 9.265 - TRANSMISSION OVERDRIVE GOVERNOR | | | | | | | | | |
| 9-2-41 | Governor..... | 200908 | 492,495,496 | 1 | 1 | 1 | 1 | | | |
| | Screw, Terminal, No. 8-32 x 1/4" Rd. Hd. Sl.. | 310 | 492,495,496 | 1 | 1 | 1 | 1 | | | |
| | Lockwasher, No. 8 Int. Tooth..... | 373 | 492,495,496 | 1 | 1 | 1 | 1 | | | |
| 9-2-43 | Pinion (15 Teeth)..... | 200909 | 492,495,496 | 1 | 1 | 1 | 1 | | | |
| 9-2-44 | Gear (7 Teeth)..... | 200910 | 492,495,496 | 1 | 1 | 1 | 1 | | | |
| 9-2-40 | Sleeve..... | 200905 | 492,495,496 | 1 | 1 | 1 | 1 | | | |
| 9-2-42 | Retainer..... | 200906 | 492,495,496 | 1 | 1 | 1 | 1 | | | |
| | Boot (Rubber)..... | 203101 | 492,495,496 | 1 | 1 | 1 | 1 | | | |
| | 9.270 - TRANSMISSION OVERDRIVE CONTROL | | | | | | | | | |
| | Control..... | 204249 | 492 | 1 | 1 | 1 | 1 | | | |
| | Control..... | 204248 | 495,496 | 1 | 1 | | | | | |
| | Lockwasher, 1/2" Int. Tooth..... | 642 | 492,495,496 | 1 | 1 | 1 | 1 | | | |
| | Nut, Jam, 1/2"-20 Hx. Lt..... | 632 | 492,495,496 | 1 | 1 | 1 | 1 | | | |
| | Clip (at Clutch Housing)..... | 205336 | 492,495,496 | 1 | 1 | 1 | 1 | | | |
| | Grommet..... | 205337 | 492,495,496 | 1 | 1 | 1 | 1 | | | |

* As required

TRANSMISSION

| FIGURE NUMBER | GROUP, PART NAME and DESCRIPTION | PART NUMBER | MODELS | BODY STYLES | | | | | | |
|---------------|---|-------------|-------------|-------------|-------|-----------|---------|---------|---|---|
| | | | | 4-DR. SEDAN | CONV. | VIRGINIAN | UTILITY | TAXICAB | | |
| | | | | 1 | 2 | 3 | 4 | 5 | 6 | |
| | 9.275 - TRANSMISSION-OVERDRIVE CONTROL BRACKET | | | | | | | | | |
| | Bracket (at Inst. Board)..... | 203512 | 492,495,496 | 1 | 1 | 1 | 1 | | | |
| | Screw, No. 10-24 x 1/2" Rd. Hd. Cr. Rec.... | 473 | 492,495,496 | 2 | 2 | 2 | 2 | | | |
| | Lockwasher, No. 10 Ext. Tooth..... | 294 | 492,495,496 | 2 | 2 | 2 | 2 | | | |
| | Nut, No. 10-24 Hx..... | 378 | 492,495,496 | 2 | 2 | 2 | 2 | | | |
| | Bracket (at Transmission)..... | 204254 | 492,495,496 | 1 | 1 | 1 | 1 | | | |
| | 9.282 - SPEEDOMETER CABLE | | | | | | | | | |
| | Cable and Housing (W/OD) (L.H.D.)..... | 204260 | 492,495,496 | 1 | 1 | 1 | 1 | | | |
| | Cable and Housing (WO/OD) (L.H.D.)..... | 204261 | 491 | 1 | | | 1 | | | |
| | Cable and Housing (WO/OD) (L.H.D.)..... | 205802 | 491 | | | | | | | 1 |
| | Cable and Housing (W/OD) (R.H.D.)..... | 203521 | 495 | 1 | | | | | | |
| | Cable and Housing (WO/OD) (R.H.D.)..... | 203520 | 491 | 1 | | | | | | |
| | Bolt, 1/4"-20 x 9/16" Rd. Hd. Sl..... | 440 | All | 1 | 1 | 1 | 1 | 1 | 1 | |
| | Lockwasher, 1/4" Med...#..... | 190 | All | 1 | 1 | 1 | 1 | 1 | 1 | |
| | Gasket..... | 200923 | All | 1 | 1 | 1 | 1 | 1 | 1 | |
| | Clip (on Cowl Panel)..... | 201637 | All | 1 | 1 | 1 | 1 | 1 | 1 | |
| | Clip (W/OD) (on No. 2 Body Bracket)..... | 205338 | 492,495,496 | 1 | 1 | 1 | 1 | | | |
| | 9.284 - SPEEDOMETER CABLE CORE | | | | | | | | | |
| | Core (W/OD) (L.H.D.)..... | 204262 | 492,495,496 | 1 | 1 | 1 | 1 | | | |
| | Core (WO/OD) (L.H.D.)..... | 204263 | 491 | 1 | | | 1 | | | |
| | Core (WO/OD) (L.H.D.)..... | 205803 | 491 | | | | | | | 1 |
| | Core (W/OD) (R.H.D.)..... | 203523 | 495 | 1 | | | | | | |
| | Core (WO/OD) (R.H.D.)..... | 203522 | 491 | 1 | | | | | | |
| | 9.286 - SPEEDOMETER DRIVE GEAR AND PINION | | | | | | | | | |

| Axle Ratio | Tire Size | Trans. Type | Speedo. Drive Gear | | Speedometer Pinion | | |
|------------|-----------|-------------|--------------------|--------------|--------------------|--------------|--------|
| | | | Part Number | Number Teeth | Part Number | Number Teeth | O.D. |
| 3.73:1 | 7:10-15 | Std. | 204307 | 6 | 204309 | 16 | 31/32" |
| 3.73:1 | 6:50-16 | Std. | 204307 | 6 | 204309 | 16 | 31/32" |
| 3.91:1 | 7:10-15 | Std. | 204307 | 5 | 204310 | 17 | 31/32" |
| 3.91:1 | 6:50-16 | Std. | 204307 | 6 | 204310 | 17 | 31/32" |
| 4.09:1 | 7:10-15 | Std. | 204307 | 6 | 204311 | 18 | 31/32" |
| 4.09:1 | 6:50-16 | Std. | 204307 | 6 | 204311 | 18 | 31/32" |
| 4.27:1 | 7:10-15 | W/OD | 204308 | 6 | 204311 | 18 | 31/32" |
| 4.27:1 | 6:50-16 | W/OD | 204308 | 6 | 204311 | 18 | 31/32" |
| 4.27:1 | 7:10-15 | Std. | 204307 | 6 | 204311 | 18 | 31/32" |
| 4.27:1 | 6:50-16 | Std. | 204307 | 6 | 204311 | 18 | 31/32" |
| 4.55:1 | 7:10-15 | Std. | 205559 | 6 | 205561 | 20 | 59/64" |
| 4.55:1 | 6:50-16 | Std. | 205559 | 6 | 205561 | 20 | 59/64" |
| 4.55:1 | 7:10-15 | W/OD | 205560 | 6 | 205561 | 20 | 59/64" |
| 4.55:1 | 6:50-16 | W/OD | 205560 | 6 | 205561 | 20 | 59/64" |

TRANSMISSION

9

| FIGURE NUMBER | GROUP, PART NAME and DESCRIPTION | PART NUMBER | MODELS | BODY STYLES | | | | | |
|---------------|--|-------------|---------|-------------|-------|-----------|---------|---------|---|
| | | | | 4-DR. SEDAN | CONV. | VIRGINIAN | UTILITY | TAXICAB | |
| | | | | 1 | 2 | 3 | 5 | 6 | |
| | 9.290 - SPEEDOMETER AND TAXIMETER DRIVE GEAR AND PINION | | | | | | | | |
| | Gear, Std. Trans. (3 Teeth) (4.09 and 4.27 Axle)..... | 205804 | 491 | | | | | | 1 |
| | Pinion, Speedometer..... | 205806 | 491 | | | | | | 1 |
| | Pinion, Taximeter..... | 205807 | 491 | | | | | | 1 |
| | Sleeve..... | 205805 | 491 | | | | | | 2 |
| | Dust Cap, Sleeve..... | 205808 | 491 | | | | | | 1 |
| | Bushing, Speedometer Pinion..... | 206076 | 491 | | | | | | 2 |
| | 9.300 - TRANSMISSION GEAR SHIFT LEVER | | | | | | | | |
| 9-3-23 | Lever, Upper (L.H.D.)..... | 204264 | All | 1 | 1 | 1 | 1 | 1 | 1 |
| | Lever, Upper (R.H.D.)..... | 203518 | 491,495 | 1 | | | | | |
| 9-3-24 | Cap (Chrome) (L.H.D.)..... | 204265 | All | 1 | 1 | 1 | 1 | 1 | 1 |
| 9-3-25 | Pin (Round)..... | 201242 | All | 1 | 1 | 1 | 1 | 1 | 1 |
| | Sleeve (R.H.D.)..... | 201243 | 491,495 | 1 | | | | | |
| | Knob (Starlight Pearl) (L.H.D.)..... | 204266 | 491,492 | 1 | 1 | 1 | 1 | 1 | 1 |
| 9-3-22 | Knob (Starlight Pearl) (L.H.D.)..... | 205172 | 495 | 1 | | | | | |
| 9-3-22 | Knob (Starlight Pearl) (L.H.D.)..... | 205174 | 496 | 1 | 1 | | | | |
| 9-3-22 | Knob (Teal Blue) (L.H.D.)..... | 204277 | 496 | 1 | 1 | | | | |
| 9-3-22 | Knob (Dubonnet) (L.H.D.)..... | 204280 | 496 | 1 | 1 | | | | |
| 9-3-22 | Knob (Blade Green) (L.H.D.)..... | 204281 | 496 | 1 | 1 | | | | |
| 9-3-22 | Knob (Garden Green) (L.H.D.)..... | 204283 | 496 | 1 | 1 | | | | |
| 9-3-22 | Knob (Wedgewood Blue Dark) (L.H.D.)..... | 204284 | 496 | 1 | 1 | | | | |
| | Knob (Starlight Pearl) (R.H.D.)..... | 206419 | 491,495 | 1 | | | | | |
| | 9.305 - TRANSMISSION GEAR SHIFT LEVER GUIDE | | | | | | | | |
| | Guide (R.H.D.)..... | 201247 | 491,495 | 1 | | | | | |
| | Spring, Upper (R.H.D.)..... | 201248 | 491,495 | 1 | | | | | |
| | Spring, Lower (R.H.D.)..... | 201249 | 491,495 | 1 | | | | | |
| | Flatwasher (R.H.D.)..... | 201250 | 491,495 | 1 | | | | | |
| | 9.310 - TRANSMISSION GEAR SHIFT SHAFT | | | | | | | | |
| 9-3-11 | Shaft (Prime) (L.H.D.)..... | 204285 | All | 1 | 1 | 1 | 1 | 1 | 1 |
| | Tube (Prime) (R.H.D.)..... | 203519 | 491,495 | 1 | | | | | |
| 9-3-26 | Guide (Chrome) (L.H.D.)..... | 205417 | All | 1 | 1 | 1 | 1 | 1 | 1 |
| 9-3-28 | Flatwasher..... | 204287 | All | 1 | 1 | 1 | 1 | 1 | 1 |
| 9-3-29 | Snap Ring, .042..... | 204288 | All | 1 | 1 | 1 | 1 | 1 | 1 |
| 9-3-29 | Snap Ring, .062..... | 205402 | All | 1 | 1 | 1 | 1 | 1 | 1 |
| 9-3-30 | Pin, Upper (Square) (L.H.D.)..... | 204289 | All | 1 | 1 | 1 | 1 | 1 | 1 |
| 9-3-9 | Pin, Lower (9/32" x 1 1/32")..... | 201511 | All | 1 | 1 | 1 | 1 | 1 | 1 |
| 9-3-2 | Spring (in Lower Brkt.) (L.H.D.)..... | 204290 | All | 1 | 1 | 1 | 1 | 1 | 1 |
| | 9.315 - TRANSMISSION GEAR SHIFT SHAFT BRACKET-UPPER | | | | | | | | |
| 9-3-27 | Bracket (L.H.D.)..... | 204291 | All | 1 | 1 | 1 | 1 | 1 | 1 |
| 9-3-21 | Cap (L.H.D.)..... | 204292 | All | 1 | 1 | 1 | 1 | 1 | 1 |
| 9-3-20 | Bolt, 5/16"-18 x 1" Hx. Hd..... | 735 | All | 1 | 1 | 1 | 1 | 1 | 1 |
| | Lockwasher, 5/16" Med..... | 240 | All | 1 | 1 | 1 | 1 | 1 | 1 |
| | Bracket (Prime) (R.H.D.)..... | 203524 | 491,495 | 1 | | | | | |
| | Bolt..... | 201246 | 491,495 | 2 | | | | | |

TRANSMISSION

| FIGURE NUMBER | GROUP, PART NAME and DESCRIPTION | PART NUMBER | MODELS | BODY STYLES | | | | | |
|---|---|-------------|---------|-------------|-------|-----------|---------|---------|--|
| | | | | 4-DR. SEDAN | CONV. | VIRGINIAN | UTILITY | TAXICAB | |
| | | | | 1 | 2 | 3 | 5 | 6 | |
| 9.320 - TRANSMISSION GEAR SHIFT LEVER-LOWER | | | | | | | | | |
| 9-3-4 | Lever, Low and Reverse (L.H.D.)..... | 204293 | All | 1 | 1 | 1 | 1 | 1 | |
| | Lever, Second and High (R.H.D.)..... | 201258 | 491,495 | 1 | | | | | |
| 9-3-16 | Springwasher..... | 201515 | All | 1 | 1 | 1 | 1 | 1 | |
| 9-3-5 | Insulator..... | 201517 | All | 1 | 1 | 1 | 1 | 1 | |
| 9-3-10 | Cover..... | 201514 | All | 1 | 1 | 1 | 1 | 1 | |
| 9-3-8 | Oiler..... | 202121 | All | 1 | 1 | 1 | 1 | 1 | |
| 9-3-12 | Lever, Second and High (L.H.D.)..... | 204294 | All | 1 | 1 | 1 | 1 | 1 | |
| | Lever, Low and Reverse (R.H.D.)..... | 201253 | 491,495 | 1 | | | | | |
| 9-3-15 | Seal..... | 201512 | All | 1 | 1 | 1 | 1 | 1 | |
| 9-3-14 | Retainer..... | 201513 | All | 1 | 1 | 1 | 1 | 1 | |
| 9-3-5 | Insulator..... | 201517 | All | 1 | 1 | 1 | 1 | 1 | |
| 9.330 - TRANSMISSION GEAR SHIFT LOWER LEVER RETAINER | | | | | | | | | |
| 9-3-17 | Retainer (L.H.D.)..... | 205300 | All | 1 | 1 | 1 | 1 | 1 | |
| | Retainer (R.H.D.)..... | 203545 | 491,495 | 1 | | | | | |
| 9-3-16 | Springwasher..... | 201515 | All | 2 | 2 | 2 | 2 | 2 | |
| 9.335 - TRANSMISSION GEAR SHIFT SHAFT BRACKET-LOWER | | | | | | | | | |
| 9-3-1 | Bracket (L.H.D.)..... | 204295 | All | 1 | 1 | 1 | 1 | 1 | |
| 9-3-18 | Cap (L.H.D.)..... | 204296 | All | 1 | 1 | 1 | 1 | 1 | |
| | Bracket (R.H.D.)..... | 203525 | 491,495 | 1 | | | | | |
| | Cap (R.H.D.)..... | 203526 | 491,495 | 1 | | | | | |
| 9-3-19 | Bolt, 5/16"-18 x 1 3/4" Hx. Hd..... | 587 | All | 2 | 2 | 2 | 2 | 2 | |
| | Lockwasher, 5/16" Med..... | 240 | All | 2 | 2 | 2 | 2 | 2 | |
| | Dowel Pin, 1/4" x 7/16" (R.H.D.)..... | 646 | 491,495 | 1 | | | | | |
| 9.340 - TRANSMISSION GEAR SHIFT ROD | | | | | | | | | |
| 9-3-3 | Rod, Upper, Low and Reverse (L.H.D.)..... | 204297 | All | 1 | 1 | 1 | 1 | 1 | |
| 9-3-13 | Rod, Upper, Second and High (L.H.D.)..... | 204298 | All | 1 | 1 | 1 | 1 | 1 | |
| | Rod, Upper, Low and Reverse (R.H.D.)..... | 203527 | 491,495 | 1 | | | | | |
| | Rod, Upper, Second and High (R.H.D.)..... | 203528 | 491,495 | 1 | | | | | |
| | Sleeve (Lever End)..... | 201518 | All | 2 | 2 | 2 | 2 | 2 | |
| | Sleeve (Bellcrank End) (L.H.D.)..... | 204299 | All | 2 | 2 | 2 | 2 | 2 | |
| 9-3-33 | Insulator (in Bellcrank) (L.H.D.)..... | 204300 | All | 2 | 2 | 2 | 2 | 2 | |
| 9-3-6 | Flatwasher, 3/8" Sm..... | 247 | All | * | * | * | * | * | |
| 9-3-7 | Springwasher..... | 201263 | All | 4 | 4 | 4 | 4 | 4 | |
| | Cotter Pin, 3/32" x 3/4"..... | 139 | All | 4 | 4 | 4 | 4 | 4 | |
| 9-3-31 | Rod, Lower, Low and Reverse (L.H.D.)..... | 204301 | All | 1 | 1 | 1 | 1 | 1 | |
| 9-3-32 | Rod, Lower, Second and High (L.H.D.)..... | 204302 | All | 1 | 1 | 1 | 1 | 1 | |
| 9-3-37 | Clevis (L.H.D.)..... | 205340 | All | 2 | 2 | 2 | 2 | 2 | |
| | Nut, 3/8"-24 Hx. (L.H.D.)..... | 188 | All | 2 | 2 | 2 | 2 | 2 | |
| 9-3-38 | Clevis Pin..... | 200239 | All | 2 | 2 | 2 | 2 | 2 | |
| | Cotter Pin, 3/32" x 3/4"..... | 139 | All | 2 | 2 | 2 | 2 | 2 | |
| | Flatwasher, 1/4" Lg..... | 344 | All | 4 | 4 | 4 | 4 | 4 | |
| | Springwasher..... | 201263 | All | 2 | 2 | 2 | 2 | 2 | |
| | Cotter Pin, 3/32" x 3/4"..... | 139 | All | 2 | 2 | 2 | 2 | 2 | |

As required

TRANSMISSION

9

| FIGURE NUMBER | GROUP, PART NAME and DESCRIPTION | PART NUMBER | MODELS | BODY STYLES | | | | |
|---|---|-------------|---------|-------------|-------|-----------|---------|---------|
| | | | | 4-DR. SEDAN | CONV. | VIRGINIAN | UTILITY | TAXICAB |
| | | | | 1 | 2 | 3 | 5 | 6 |
| 9.340 - TRANSMISSION GEAR SHIFT ROD (Cont'd) | | | | | | | | |
| | Rod, Lower, Low and Reverse (R.H.D.)..... | 203529 | 491,495 | 1 | | | | |
| | Rod, Lower, Second and High (R.H.D.)..... | 203530 | 491,495 | 1 | | | | |
| | Flatwasher, 3/8" Sm..... | 247 | 491,495 | 4 | | | | |
| | Springwasher..... | 201263 | 491,495 | 2 | | | | |
| | Cotter Pin, 3/32" x 3/4"..... | 139 | 491,495 | 2 | | | | |
| | Clevis (Low and Reverse Rod)(R.H.D.)..... | 203531 | 491,495 | 1 | | | | |
| | Clevis (Second and High Rod)(R.H.D.)..... | 201264 | 491,495 | 1 | | | | |
| | Nut, 3/8"-24 Hx. (R.H.D.)..... | 188 | 491,495 | 2 | | | | |
| | Clevis Pin (Low and Reverse Rod)..... | 203543 | 491,495 | 1 | | | | |
| | Clevis Pin (Second and High Rod)..... | 201265 | 491,495 | 1 | | | | |
| | Cotter Pin, 3/32" x 3/4"..... | 139 | 491,495 | 2 | | | | |
| 9.342 - TRANSMISSION GEAR SHIFT ROD CROSS # SHAFT-R.H.D. | | | | | | | | |
| | Shaft (incl. Bushings) (Low and Reverse)..... | 203532 | 491,495 | 1 | | | | |
| | Insulator (incl. Bushing)..... | 203533 | 491,495 | 1 | | | | |
| | Spring..... | 203534 | 491,495 | 1 | | | | |
| | Thrustwasher..... | 203535 | 491,495 | 3 | | | | |
| | Shaft (Second and High)..... | 203537 | 491,495 | 1 | | | | |
| | Bushing..... | 203538 | 491,495 | 2 | | | | |
| | Bracket (to Flywheel Housing)..... | 203539 | 491,495 | 1 | | | | |
| | Bolt, 5/16"-18 x 5/8" Hx. Hd..... | 208 | 491,495 | 2 | | | | |
| | Lockwasher, 5/16" Med..... | 240 | 491,495 | 2 | | | | |
| | Insulator (incl. Bushing)..... | 203540 | 491,495 | 1 | | | | |
| | Thrustwasher (1 1/2" O.D.)..... | 203541 | 491,495 | 1 | | | | |
| | Thrustwasher (1 1/4" O.D.)..... | 203535 | 491,495 | 1 | | | | |
| | Lever (Low and Reverse)..... | 203542 | 491,495 | 1 | | | | |
| | Bolt, 5/16"-18 x 1 3/4" Hx. Hd..... | 587 | 491,495 | 1 | | | | |
| | Flatwasher, 5/16" Sm..... | 225 | 491,495 | 1 | | | | |
| | Lockwasher, 5/16" Med..... | 240 | 491,495 | 1 | | | | |
| | Nut, 5/16"-18 Hx..... | 205 | 491,495 | 1 | | | | |
| 9.345 - TRANSMISSION GEAR SHIFT ROD BELLCRANK | | | | | | | | |
| 9-3-40 | Bellcrank, Low and Reverse (L.H.D.)..... | 204303 | All | 1 | 1 | 1 | 1 | 1 |
| 9-3-39 | Bellcrank, Second and High (L.H.D.)..... | 204410 | All | 1 | 1 | 1 | 1 | 1 |
| 9-3-36 | Thrustwasher, 21/32" I.D. x 1 5/16" O.D.... | 206120 | All | 1 | 1 | 1 | 1 | 1 |
| 9-3-35 | Snap Ring..... | 204304 | All | 1 | 1 | 1 | 1 | 1 |
| 9-3-34 | Oiler..... | 202121 | All | 1 | 1 | 1 | 1 | 1 |
| | | | | | | | | |
| | | | | | | | | |
| | | | | | | | | |
| | | | | | | | | |
| | | | | | | | | |
| | | | | | | | | |
| | | | | | | | | |