

FIGURE 14-1 — TYPICAL STEERING GEAR - EXPLODED VIEW

KEY	PART NAME	GROUP	KEY	PART NAME	GROUP
1	Locknut, Shaft and Roller.....	14.116	12	Roller and Cage, Worm Thrust Bearing.....	14.114
2	Lockplate, Shaft and Roller.....	14.116	13	Column and Worm.....	14.110
3	Plug, Shaft and Roller Oil.....	14.118	14	Cup, Worm Thrust Bearing, Lower..	14.112
4	Bolt, Cover.....	14.104	15	Shim.....	14.110
5	Cover, Shaft and Roller.....	14.118	16	Cover Assembly, Housing End.....	14.104
6	Thrustwasher, Shaft and Roller...	14.116	17	Housing Assembly.....	14.102
7	Screw, Roller Shaft Adjusting....	14.116	18	Seal, Roller Shaft.....	14.116
8	Gasket, Shaft Cover.....	14.118	19	Arm (Pitman).....	14.200
9	Shaft and Roller.....	14.116	20	Lockwasher, Lever Arm.....	14.200
10	Bushing, Roller Shaft.....	14.102	21	Nut, Lever Arm.....	14.200
11	Cup, Worm Thrust Bearing, Upper..	14.112	22	Nut, Steering Wheel.....	14.126

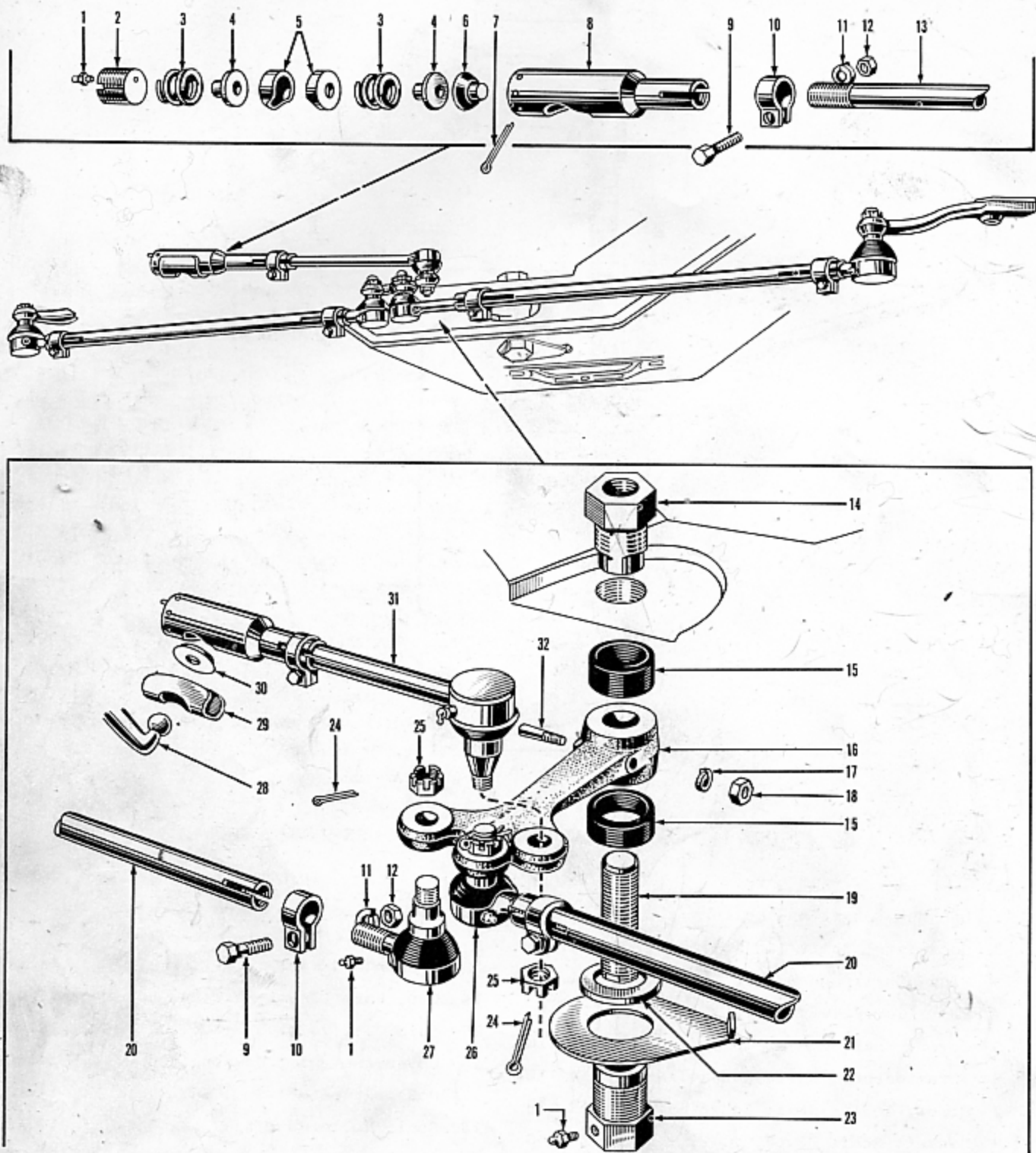

FIGURE 14-2 — STEERING CONTROL - EXPLODED VIEW

FIGURE 14-2 — STEERING CONTROL - EXPLODED VIEW

KEY	PART NAME	GROUP	KEY	PART NAME	GROUP
1	Oiler, Drag Link Socket.....	14.206	17	Lockwasher.....	14.212
2	Plug, Drag Link Socket.....	14.206	18	Nut.....	14.212
3	Spring, Drag Link Socket.....	14.206	19	Pin, Idler Lever (Serviced Only in Kit).....	14.212
4	Bumper, Drag Link Socket.....	14.206	20	Tie Rod Assembly.....	14.216
5	Bearing, Drag Link Socket.....	14.206	21	Lock, Idler Lever Bushing.....	14.214
6	Seat, Drag Link Socket.....	14.206	22	Washer, Idler Lever.....	14.214
7	Cotter Pin, Drag Link Socket.....	14.206	23	Bushing, Idler Lever, Lower.....	14.214
8	Socket, Drag Link.....	14.206	24	Cotter Pin, Tie Rod.....	14.216
9	Bolt.....	14.202	25	Nut, Tie Rod.....	14.216
10	Clamp.....	14.202	26	End, Tie Rod L.H. Thread.....	14.216
11	Lockwasher.....	14.202	27	End, Tie Rod R. H. Thread.....	14.216
12	Nut.....	14.202	28	Arm (Pitman).....	14.200
13	Serviced Only in Drag Link Assembly.....		29	Shield, Drag Link.....	14.204
14	Bushing, Idler Lever, Upper.....	14.214	30	Cover, Drag Link.....	14.204
15	Seal, Idler Lever.....	14.214	31	Link Assembly, Drag.....	14.202
16	Lever, Idler.....	14.212	32	Lockpin, Idler Lever.....	14.212

STEERING GEAR

FIGURE NUMBER	GROUP, PART NAME and DESCRIPTION	PART NUMBER	MODELS	BODY STYLES				
				4-DR. SEDAN	CONV.	VIRGINIAN	UTILITY	TAXICAB
				1	2	3	5	6
	14.000 - STEERING GEAR							
	Gear (incl. Column and Shaft) (L.H.D.).....	204381	All	1	1	1	1	1
	Bolt.....	201169	All	3	3	3	3	3
	Flatwasher.....	201170	All	3	3	3	3	3
	Locknut, 3/8"-24 Hx.....	202257	All	3	3	3	3	3
	Gear (incl. Column and Shaft) (R.H.D.).....	203574	491,495	1				
	Bolt, Front.....	203575	491,495	2				
	Bolt, Rear.....	203576	491,495	1				
	Flatwasher.....	201471	491,495	3				
	Lockwasher, 7/16" Med.....	193	491,495	3				
	14.102 - STEERING GEAR HOUSING							
14-1-17	Housing (incl. Shaft Bushing and Upper Bearing Cup) (L.H.D.).....	204379	All	1	1	1	1	1
14-1-10	Bushing.....	201196	All	2	2	2	2	2
	Housing (incl. Shaft Bushing and Upper Bearing Cup) (R.H.D.).....	203577	491,495	1				
	Bushing.....	203578	491,495	2				
	14.104 - STEERING GEAR HOUSING END COVER							
14-1-16	Cover (incl. Grease Tube).....	201193	All	1	1	1	1	1
14-1-4	Bolt.....	202758	All	4	4	4	4	4
	14.106 - STEERING COLUMN JACKET							
	Jacket (incl. Brg.) (Prime) (L.H.D.).....	204378	All	1		1	1	1
	Jacket (incl. Brg.) (Prime) (L.H.D.).....	206058	492,496		1			
	Clamp.....	201173	All	1	1	1	1	1
	Bolt.....	201174	All	1	1	1	1	1
	Lockwasher, 5/16" Med.....	240	All	1	1	1	1	1
	Nut, 5/16"-24 Hx.....	189	All	1	1	1	1	1
	Reinforcement.....	201176	All	1	1	1	1	1
	Jacket (incl. Brg. and Reinf.) (Prime) (R.H.D.).....	203579	495	1				
	Jacket (incl. Brg. and Reinf.) (Prime) (R.H.D.).....	203580	491	1				
	14.108 - STEERING COLUMN JACKET BEARING							
	Bearing.....	201177	All	1	1	1	1	1
	Spacer.....	201178	All	1	1	1	1	1
	Spring.....	201179	All	1	1	1	1	1
	14.110 - STEERING GEAR COLUMN AND WORM							
14-1-13	Column and Worm (L.H.D.).....	205342	All	1	1	1	1	1
	Column and Worm (R.H.D.).....	203581	491,495	1				
14-1-15	Shim, .002.....	201190	All	*	*	*	*	*
14-1-15	Shim, .005.....	201191	All	*	*	*	*	*
14-1-15	Shim, .010.....	201192	All	*	*	*	*	*
	14.112 - STEERING GEAR WORM THRUST BEARING CUP							
14-1-11	Cup, Upper.....	201188	All	1	1	1	1	1

* As required

STEERING GEAR

FIGURE NUMBER	GROUP, PART NAME and DESCRIPTION	PART NUMBER	MODELS	BODY STYLES						
				4-DR. SEDAN	CONV.	VIRGINIAN	UTILITY	TAXICAB		
				1	2	3	4	5	6	
	14.112 - STEERING GEAR WORM THRUST BEARING CUP (Cont'd)									
14-1-14	Cup, Lower.....	201189	All	1	1	1	1	1	1	
	14.114 - STEERING GEAR WORM THRUST BEARING ROLLER AND CAGE									
14-1-12	Roller and Cage.....	201187	All	2	2	2	2	2	2	
	14.116 - STEERING GEAR SHAFT AND ROLLER									
14-1-9	Shaft and Roller (L.H.D.).....	202759	All	1	1	1	1	1	1	
	Shaft and Roller (R.H.D.).....	203582	491,495	1						
14-1-18	Seal (L.H.D.).....	201197	All	1	1	1	1	1	1	
	Seal (R.H.D.).....	203589	491,495	1						
14-1-7	Screw, Adjusting, 1/2"-20.....	201198	All	1	1	1	1	1	1	
14-1-1	Locknut, 1/2"-20 Hx.....	201200	All	1	1	1	1	1	1	
14-1-2	Lockplate.....	201199	All	1	1	1	1	1	1	
14-1-6	Thrustwasher.....	202760	All	1	1	1	1	1	1	
60-41 †	Shaft and Bushing Kit.....	206407	All	1	1	1	1	1	1	
	14.118 - STEERING GEAR SHAFT COVER									
14-1-5	Cover (L.H.D.).....	202761	All	1	1	1	1	1	1	
	Cover (R.H.D.).....	203573	491,495	1						
14-1-4	Bolt, 5/16"-18 x 9/16" Hx. Hd.....	202758	All	4	4	4	4	4	4	
14-1-3	Plug, Oil.....	201204	All	1	1	1	1	1	1	
14-1-8	Gasket.....	201203	All	1	1	1	1	1	1	
	14.120 - STEERING GEAR SUPPORT BRACKET AND CAP									
	Bracket (L.H.D.) { 4 5/8" Long with Gear }.....	204377	All	1	1	1	1	1	1	
	Cap (L.H.D.) { Shift Shaft Hole }.....	204376	All	1	1	1	1	1	1	
	Bolt, 3/8"-24 x 1 1/2" { Bracket to Inst. }.....	494	All	2	2	2	2	2	2	
	Hx. Hd. { Panel }.....	247	All	2	2	2	2	2	2	
	Flatwasher, 3/8" Sm. { Cap. }.....									
	Bolt, 1/4"-20 x 1 1/2" { to }.....	491	All	2	2	2	2	2	2	
	Hx. Soc. { Bracket }.....	190	All	2	2	2	2	2	2	
	Lockwasher, 1/4" Med. { }.....									
	Insulator (1" Long).....	204375	All	1	1	1	1	1	1	
	Bracket (L.H.D.) { 3" Long less Gear }.....	206141	All	1	1	1	1	1	1	
	Cap (L.H.D.) { Shift Shaft Hole }.....	206142	All	1	1	1	1	1	1	
	Plate, Tapping (L.H.D.).....	206143	All	1	1	1	1	1	1	
	Bolt, 3/8"-24 x 1 1/2" { Bracket to Inst. }.....	494	All	2	2	2	2	2	2	
	Hx. Hd. { Panel }.....	192	All	2	2	2	2	2	2	
	Lockwasher, 3/8" Med. { Cap. }.....									
	Bolt, 1/4"-20 x 1 1/2" { to }.....	491	All	2	2	2	2	2	2	
	Hx. Soc. { Bracket }.....	190	All	2	2	2	2	2	2	
	Lockwasher, 1/4" Med. { }.....									
	Insulator (L.H.D.) (1 11/32" Long).....	206144	All	1	1	1	1	1	1	
	Brace, Inst. Panel to Steering Column Bracket (L.H.D.).....	206145	All	1	1	1	1	1	1	
	Bolt, 5/16"-18 x 11/16" Hx. Hd.....	397	All	2	2	2	2	2	2	
	Lockwasher, 5/16" Med.....	240	All	2	2	2	2	2	2	
	Bracket and Cap (Prime) (R.H.D.).....	203583	491,495	1						

† For Component Parts SEE Group 60.14

STEERING GEAR

FIGURE NUMBER	GROUP, PART NAME and DESCRIPTION	PART NUMBER	MODELS	BODY STYLES				
				4-DR. SEDAN	CONV.	VIRGINIAN	UTILITY	TAXICAB
				1	2	3	5	6
	14.120 - STEERING GEAR SUPPORT BRACKET AND CAP (Cont'd)							
	Bolt, 1/4"-20 x 1" Hx. Soc.....	490	491,495	2				
	Lockwasher, 1/4" Med.....	190	491,495	2				
	Bolt, 3/8"-24 x 2 1/4" Hx. Hd.....	748	491,495	1				
	Bolt, 3/8"-24 x 1 1/2" Hx. Hd.....	494	491,495	1				
	Flatwasher, 3/8" Sm.....	247	491,495	2				
	Lockwasher, 3/8" Med.....	192	491,495	2				
	Nut, 3/8"-24 Hx.....	188	491,495	2				
	Spacer (R.H.D.).....	204160	491,495	1				
	Insulator.....	204375	491,495	1				
	14.121 - STEERING GEAR SUPPORT "U" BOLT							
	Bracket, "U" Bolt (L.H.D.).....	205389	491,492	1	1	1	1	
	Bolt, 5/16"-18 x 11/16" Hx. Hd.....	397	491,492	2	2	2	2	
	Lockwasher, 5/16" Med.....	240	491,492	2	2	2	2	
	"U" Bolt (L.H.D.).....	205292	491,492	1	1	1	1	
	Lockwasher, 1/4" Med.....	190	491,492	2	2	2	2	
	Nut, 1/4"-20 Hx.....	203	491,492	2	2	2	2	
	Clamp (L.H.D.).....	205293	491,492	1	1	1	1	
	Spacer (L.H.D.).....	205294	491,492	1	1	1	1	
	Bracket, "U" Bolt (incl. Nuts) (R.H.D.).....	206146	491,495	1				
	Bolt, 5/16"-18 x 11/16" Hx. Hd.....	397	491,495	2				
	Lockwasher, 5/16" Med.....	240	491,495	2				
	Support, Bracket to Inst. Panel (R.H.D.).....	204374	491,495	1				
	Screw, No. 10-32 x 1/2" Rd. Hd. Cr. Rec....	654	491,495	2				
	Lockwasher, No. 10 Ext. Tooth.....	294	491,495	2				
	Nut, No. 10-32 Hx.....	202	491,495	2				
	"U" Bolt (R.H.D.).....	204373	491,495	1				
	Lockwasher, 1/4" Med.....	190	491,495	2				
	Nut, 1/4"-20 Hx.....	203	491,495	2				
	Spacer (R.H.D.).....	204372	491,495	1				
	14.122 - STEERING GEAR JACKET COVER							
	Cover, Right (L.H.D.).....	205683	491	1				1
	Cover, Right (L.H.D.).....	205683	492	1	1	1	1	
	Cover, Left (less Directional Signal) (L.H.D.)	205684	491	1				1
	Cover, Left (with Directional Signal) (L.H.D.)	205685	492	1	1	1	1	
	Cover (incl. Insulator) (L.H.D.).....	205686	495,496	1	1			
	Cover, Right.....	206261	491				1	
	Cover, Left.....	206262	491				1	
	Screw, No. 10-12 x 3/8" Rd. Hd. Cr. Rec.							
	Tap. (Chrome) (to Cover and Brkt.).....	609	All	4	4	4	4	4
	Screw, No. 8-32 x 3/8" Rd. Hd. Cr. Rec.							
	(Chrome) (to Upper Brkt.).....	599	All	2	2	2	2	2
	Lockwasher, No. 8 Lt. (Chrome) (to Upper Brkt.).....	749	All	2	2	2	2	2
	Silencer (L.H.D.).....	205678	491,492	2	2	2	2	2
	Retainer (on Support Brkt.) (4 1/8" Long) (L.H.D.).....	205304	491,492	1	1	1	1	1

30-21-36

STEERING GEAR

FIGURE NUMBER	GROUP, PART NAME and DESCRIPTION	PART NUMBER	MODELS	BODY STYLES						
				4-DR. SEDAN	CONV.	VIRGINIAN	UTILITY	TAXICAB		
				1	2	3	5	6		
	14.122 - STEERING GEAR JACKET COVER (Cont'd)									
	Retainer (on Support Brkt.) (1 1/4" Long)....	206543	All	1	1	1	1	1		
	Drive Screw.....	205591	All	2	2	2	2	2		
	Bumper (Rubber) (L.H.D.).....	200539	491,492	2	2	2	2	2		
	Moulding (Prime) (L.H.D.)... { attach }	205295	491,492	1	1	1	1	1		
30-21-28	Moulding (Prime) (L.H.D.)... {with Clips}	205296	495,496	1	1					
	Clip.....	205297	All	2	2	2	2	2		
	Moulding (Prime) (L.H.D.)... { attach }	205687	491,492	1	1	1	1	1		
30-21-28	Moulding (Prime) (L.H.D.)... {with Screws}	205688	495,496	1	1					
	Screw, No. 8-15 x 1/2" Oval Hd. Cr. Rec. (Chrome).....	750	All	2	2	2	2	2		
	Cover (R.H.D.).....	206147	491	1						
	Cover (R.H.D.).....	206148	495	1						
	Seal, Upper (R.H.D.).....	206149	491,495	1						
	Seal, Lower (R.H.D.).....	206150	491,495	1						
	14.124 - STEERING COLUMN DASH PANEL PAD									
	Pad, Upper (Black)(L.H.D.).....	204371	All	1	1	1	1	1		
	Pad, Upper (Hickory Brown)(L.H.D.).....	205344	All	1	1	1	1	1		
	Pad, Upper (Solar Gray)(L.H.D.).....	205345	All	1	1	1	1	1		
	Pad, Upper (Emblem Blue)(L.H.D.).....	205346	492,495,496	1		1				
	Pad, Upper (Maroon)(L.H.D.).....	205347	492,495,496	1						
	Pad, Upper (Crystal Green)(L.H.D.).....	205348	All	1	1	1	1	1		
	Pad, Upper (Teal Blue)(L.H.D.).....	205349	492,495,496	1		1				
	Pad, Lower (Black)(L.H.D.).....	204370	All	1	1	1	1	1		
	Pad, Lower (Hickory Brown)(L.H.D.).....	205350	All	1	1	1	1	1		
	Pad, Lower (Solar Gray)(L.H.D.).....	205351	All	1	1	1	1	1		
	Pad, Lower (Emblem Blue)(L.H.D.).....	205352	492,495,496	1		1				
	Pad, Lower (Maroon)(L.H.D.).....	205353	492,495,496	1						
	Pad, Lower (Crystal Green)(L.H.D.).....	205354	All	1	1	1	1	1		
	Pad, Lower (Teal Blue)(L.H.D.).....	205355	492,495,496	1		1				
	Pad, Right (Black) (R.H.D.).....	203586	491,495	1						
	Pad, Right (Hickory Brown) (R.H.D.).....	205714	491,495	1						
	Pad, Right (Emblem Blue) (R.H.D.).....	205716	491,495	1						
	Pad, Right (Maroon) (R.H.D.).....	205717	491,495	1						
	Pad, Right (Crystal Green) (R.H.D.).....	205718	491,495	1						
	Pad, Right (Teal Blue) (R.H.D.).....	205719	491,495	1						
	Pad, Left (Black) (R.H.D.).....	203590	491,495	1						
	Pad, Left (Hickory Brown) (R.H.D.).....	205720	491,495	1						
	Pad, Left (Emblem Blue) (R.H.D.).....	205722	491,495	1						
	Pad, Left (Maroon) (R.H.D.).....	205723	491,495	1						
	Pad, Left (Crystal Green) (R.H.D.).....	205724	491,495	1						
	Pad, Left (Teal Blue) (R.H.D.).....	205725	491,495	1						
	Screw, No. 10-12 x 1 1/2" Oval Hd. Cr. Rec. Tap.....	751	All	2	2	2	2	2		
	Reinforcement (L.H.D.).....	204369	All	1	1	1	1	1		
	Reinforcement (R.H.D.).....	203591	491,495	1						
	Screw, No. 10-12 x 3/8" Pan. Hd. Cr. Rec. Tap.....	594	All	4	4	4	4	4		
	14.126 - STEERING WHEEL									
7-7-5	Wheel (less Cancelling Pins) (Starlight Pearl) (Export only) (L.H.D.).....	205356	491	1				1		

STEERING GEAR

FIGURE NUMBER	GROUP, PART NAME and DESCRIPTION	PART NUMBER	MODELS	BODY STYLES					
				4-DR. SEDAN	CONV.	VIRGINIAN	UTILITY	TAXICAB	
				1	2	3	5	6	
	14.126 - STEERING WHEEL (Cont'd)								
7-7-5	Wheel (less Cancelling Pins) (Hickory Brown) (L.H.D.).....	205193	491	1			1	1	
7-7-5	Wheel (less Cancelling Pins) (Mineral Gray) (L.H.D.).....	205194	491	1			1	1	
7-7-20	Wheel (incl. Cancelling Pins) (Starlight Pearl) (L.H.D.) (3 3/4" Medallion Opening).	205357	492	1					
	Wheel (incl. Cancelling Pins) (Starlight Pearl) (L.H.D.) (4.7/16" Medallion Opening).	205195	492	1	1	1	1	1	
7-7-5	Wheel (incl. Cancelling Pins) (Starlight Pearl) (L.H.D.).....	205196	495	1					
7-8-6	Wheel (incl. Cancelling Pins) (Starlight Pearl) (L.H.D.).....	205197	496	1	1				
7-8-6	Wheel (incl. Cancelling Pins) (Dubonnet) (L.H.D.).....	205198	496	1	1				
7-8-6	Wheel (incl. Cancelling Pins) (Blade Green) (L.H.D.).....	205200	496	1	1				
7-8-6	Wheel (incl. Cancelling Pins) (Garden Green) (L.H.D.).....	205201	496	1	1				
7-8-6	Wheel (incl. Cancelling Pins) (Teal Blue) (L.H.D.).....	205203	496	1	1				
7-8-6	Wheel (incl. Cancelling Pins) (Wedgewood Blue Dark) (L.H.D.).....	205358	496	1	1				
	Wheel (incl. Cancelling Pins) (Starlight Pearl) (R.H.D.).....	206029	491,495	1					
7-7-21	Nut, 7/8"-18 Hx.....	201206	All	1	1	1	1	1	
	14.200 - STEERING GEAR LEVER ARM (PITMAN)								
14-1-19	Arm (L.H.D.) up to Serial 491-13138, 492-26460, 495-10948, 496-8048.....	202674	All	1					
14-1-19	Arm (L.H.D.) after Serial 491-13138, 492-26460, 495-10948 496-8048.....	205755	All	1	1	1	1	1	
	Arm (R.H.D.).....	203592	491,495	1					
14-1-20	Lockwasher, 7/8".....	201216	All	1	1	1	1	1	
14-1-21	Nut, 7/8"-14 Hx.....	201217	All	1	1	1	1	1	
	14.202 - STEERING DRAG LINK								
14-2-31	Link (L.H.D.) up to Serial 491-13138, 492-26460, 495-10948, 496-8048.....	202076	All	1					
	Link (L.H.D.) after Serial 491-13138, 492-26460, 495-10948, 496-8048.....	205756	All	1	1	1	1	1	
	Link (R.H.D.).....	203587	491,495	1					
	Nut, 1/4"-20 Hx. Sl.....	486	All	1	1	1	1	1	
	Cotter Pin, 3/32" x 1".....	480	All	1	1	1	1	1	
14-2-10	Clamp.....	201221	All	1	1	1	1	1	
14-2-9	Bolt.....	201222	All	1	1	1	1	1	
14-2-11	Lockwasher, 5/16" Hy.....	191	All	1	1	1	1	1	
14-2-12	Nut, 5/16"-24 Hx. Lt.....	189	All	1	1	1	1	1	
	14.204 - STEERING DRAG LINK STUD COVER								
14-2-30	Cover (Steering Gear End).....	201519	All	1	1	1	1	1	
14-2-29	Shield (Steering Gear End).....	201520	All	1	1	1	1	1	
	Cover (Idler Lever End).....	201219	All	1	1	1	1	1	

STEERING GEAR

FIGURE NUMBER	GROUP, PART NAME and DESCRIPTION	PART NUMBER	MODELS	BODY STYLES					
				4-DR. SEDAN	CONV.	VIRGINIAN	UTILITY	TAXICAB	
				1	2	3	5	6	
14.206 - STEERING DRAG LINK SOCKET									
14-2-8	Socket.....	202077	All	1	1	1	1	1	
14-2-5	Bearing.....	201226	All	2	2	2	2	2	
14-2-3	Spring.....	201225	All	2	2	2	2	2	
14-2-6	Seat.....	201223	All	1	1	1	1	1	
14-2-4	Bumper.....	201224	All	2	2	2	2	2	
14-2-2	Plug.....	202078	All	1	1	1	1	1	
14-2-7	Cotter Pin, 1/8" x 1 3/4".....	496	All	1	1	1	1	1	
14-2-1	Oiler (Straight).....	202121	All	2	2	2	2	2	
	Oiler (90°).....	202575	All	1	1	1	1	1	
14.212 - STEERING IDLER LEVER									
14-2-16	Lever (L.H.D.) up to Serial 491-13138, 492-26460, 495-10948, 496-8048.....	202093	All	1					
	Lever (L.H.D.) after Serial 491-13138, 492-26460, 495-10948, 496-8048.....	205757	All	1	1	1	1	1	
	Lever (R.H.D.).....	203588	491, 495	1					
60-42 †	Pin and Bushing Kit.....	205784	All	1	1	1	1	1	
14-2-32	Lockpin (Small Diam.).....	203002	All	1	1	1	1	1	
14-2-32	Lockpin (Large Diam.).....	206194	All	1	1	1	1	1	
14-2-17	Lockwasher, 3/8" Med.....	192	All	1	1	1	1	1	
14-2-18	Nut, 3/8"-24 Hx. Lt.....	188	All	1	1	1	1	1	
14.214 - STEERING IDLER LEVER BUSHING									
14-2-14	Bushing, Upper.....	201233	All	1	1	1	1	1	
14-2-23	Bushing, Lower.....	201234	All	1	1	1	1	1	
14-2-21	Lock.....	203944	All	1	1	1	1	1	
14-2-22	Washer.....	202094	All	2	2	2	2	2	
14-2-15	Seal.....	201232	All	2	2	2	2	2	
	Oiler (Straight).....	202121	All	1	1	1	1	1	
14.216 - STEERING TIE ROD									
14-2-20	Tie Rod (incl. Seals and Nuts).....	201235	All	2	2	2	2	2	
60-43 †	Tie Rod Kit.....	205783	All	2	2	2	2	2	
14-2-27	Tie Rod End (R.H. Thd.).....	201236	All	2	2	2	2	2	
14-2-26	Tie Rod End (L.H. Thd.).....	201237	All	2	2	2	2	2	
14-2-25	Nut, 1/2"-20 Hx. Sl.....	486	All	4	4	4	4	4	
14-2-24	Cotter Pin, 3/32" x 1".....	480	All	4	4	4	4	4	
	Clamp.....	201221	All	4	4	4	4	4	
	Bolt, 5/16"-24 x 1 7/16".....	201222	All	4	4	4	4	4	
	Lockwasher, 5/16" Hy.....	191	All	4	4	4	4	4	
	Nut, 5/16"-24 Hx.....	189	All	4	4	4	4	4	
	Oiler (Straight).....	202121	All	4	4	4	4	4	
	Dust Cover.....	201219	All	4	4	4	4	4	

† For Component Parts SEE Group 60.14

