

FIGURE 16-1 — TYPICAL FRONT WHEEL AND BEARINGS - EXPLODED VIEW

KEY	PART NAME	GROUP	KEY	PART NAME	GROUP
1	Cap, Grease.....	16.010	6	Cup, Outer.....	16.010
2	Cotter Pin.....	16.002	7	Cup, Inner.....	16.010
3	Nut.....	16.002	8	Cone, Inner.....	16.010
4	Flatwasher.....	16.002	9	Seal, Inner.....	16.010
5	Cone, Outer.....	16.010	10	Knuckle, Steering.....	13.000

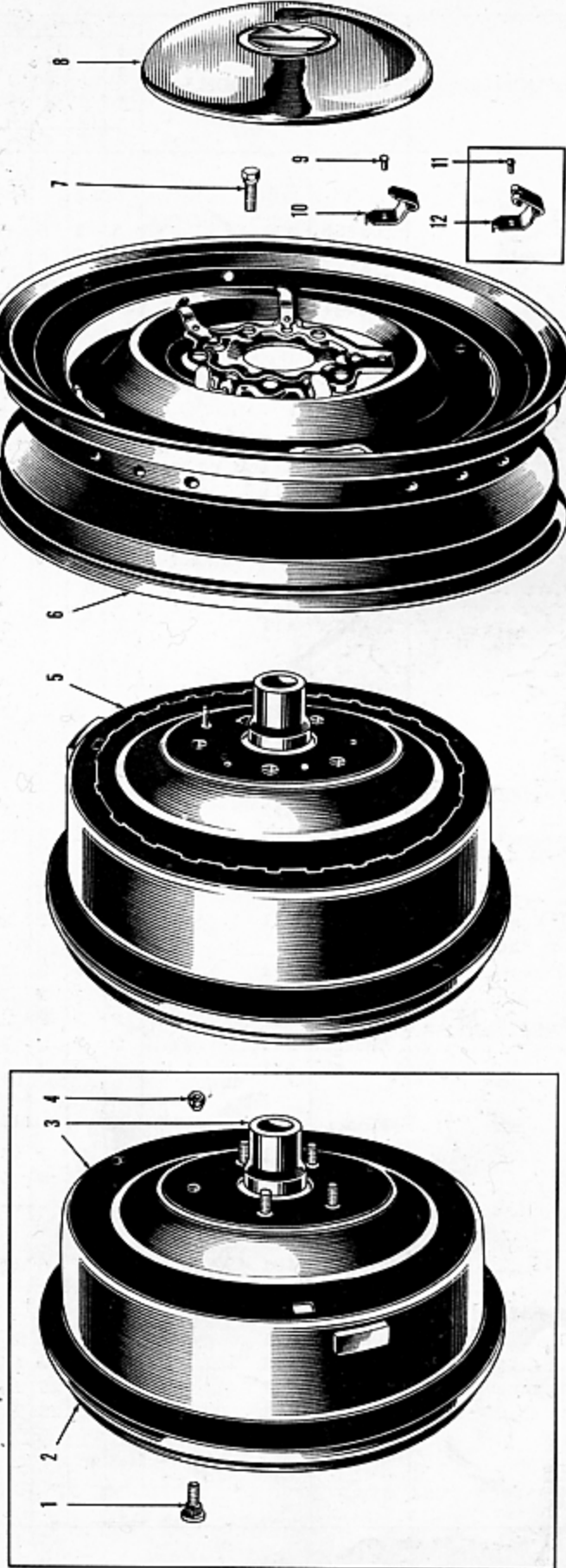

FIGURE 16-2 — TYPICAL WHEEL WITH HUBS AND DRUMS - EXPLODED VIEW

KEY	PART NAME	GROUP	KEY	PART NAME	GROUP
1	Stud, Wheel.....	16.006	7	Bolt, Wheel.....	16.000
2	Drum, Brake.....	16.006	8	Cap (or Cover), Hub.....	16.026
3	Hub and Drum Assembly.....	16.002	9	Rivet.....	16.026
4	Nut, Wheel.....	16.000	10	Clip, Spring.....	16.026
5	Hub and Drum Assembly.....	16.002	11	Rivet.....	16.026
6	Wheel.....	16.000	12	Clip, Spring.....	16.026

WHEELS

FIGURE NUMBER	GROUP, PART NAME and DESCRIPTION	PART NUMBER	MODELS	BODY STYLES						
				4-DR. SEDAN	CONV.	VIRGINIAN	UTILITY	TAMICAB		
				1	2	3	5	6		
	16.000 - WHEELS									
16-2-6	Wheel (9/16" Stud Holes) (15").....	203258	All	5	5	5	5	5		
	Wheel (9/16" Stud Holes) (16") (Export).....	203308	All	5	5	5	5	5		
16-2-4	Nut, R.H. Thd.....	203119	All	20	20	20	20	20		
16-2-7	Bolt, R.H. Thd.....	203121	All	20	20	20	20	20		
	16.002 - FRONT WHEEL HUB AND DRUM									
16-2-3	Hub and Drum (with Studs for Wheel Mtg. Nuts)	204632	All	2	2	2	2	2		
16-2-5	Hub and Drum (with Tapped Holes for Wheel Mtg. Bolts).....	204633	All	2	2	2	2	2		
16-1-4	Flatwasher, 3/4" x 1 11/16" x 1/8".....	201166	All	2	2	2	2	2		
16-1-3	Nut, 3/4"-16 Hx. Sl.....	436	All	2	2	2	2	2		
16-1-2	Cotter Pin, 1/8" x 1/2".....	341	All	2	2	2	2	2		
	16.006 - FRONT WHEEL BRAKE DRUM									
16-2-2 †	Drum.....	201156	All	2	2	2	2	2		
16-2-1	Stud, R.H. Thd. 1/2"-20 x 7/16".....	201158	All	5	5	5	5	5		
	16.010 - FRONT WHEEL BEARINGS									
16-1-8	Bearing Cone, Inner.....	204634	All	2	2	2	2	2		
16-1-7	Bearing Cup, Inner.....	204635	All	2	2	2	2	2		
16-1-5	Bearing Cone, Outer.....	204636	All	2	2	2	2	2		
16-1-6	Bearing Cup, Outer.....	204637	All	2	2	2	2	2		
16-1-9	Seal, Inner.....	204638	All	2	2	2	2	2		
16-1-1	Cap, Grease.....	201151	All	2	2	2	2	2		
	16.020 - REAR WHEEL HUB AND DRUM									
16-2-3	Hub and Drum (with Studs for Wheel Mtg. Nuts)	201154	All	2	2	2	2	2		
16-2-5	Hub and Drum (with Tapped Holes for Wheel Mtg. Bolts).....	203125	All	2	2	2	2	2		
12-1-25	Key.....	200374	All	2	2	2	2	2		
12-1-27	Flatwasher, 1 1/32" x 1 15/16" x 1/8".....	200376	All	2	2	2	2	2		
12-1-26	Nut, 1"-14 Hx.....	200375	All	2	2	2	2	2		
	Cotter Pin, 1/8" x 1 1/2".....	341	All	2	2	2	2	2		
	16.022 - REAR WHEEL BRAKE DRUM									
16-2-2 †	Drum.....	201157	All	2	2	2	2	2		
16-2-1	Stud, R.H. Thd. 1/2"-20 x 1 7/16".....	201158	All	5	5	5	5	5		
	16.026 - WHEEL HUB CAP OR COVER									
16-2-8	Cap, Kaiser.....	204658	491,492	4	4	4	4	4		
	Cap, Frazer.....	204659	495,496	4	4					
16-2-12	Clip, Spring (on Wheels) (free end rolled under).....	202681	All	25	25	25	25	25		
16-2-11	Rivet, Rd. Hd.....	202741	All	25	25	25	25	25		
16-2-10	Clip, Spring (on Wheels) (free end tapered).....	203262	All	25	25	25	25	25		
16-2-9	Rivet, Fl. Hd.....	203263	All	25	25	25	25	25		

† Replacement only on Hub and Drum fastened by Wheel Studs

