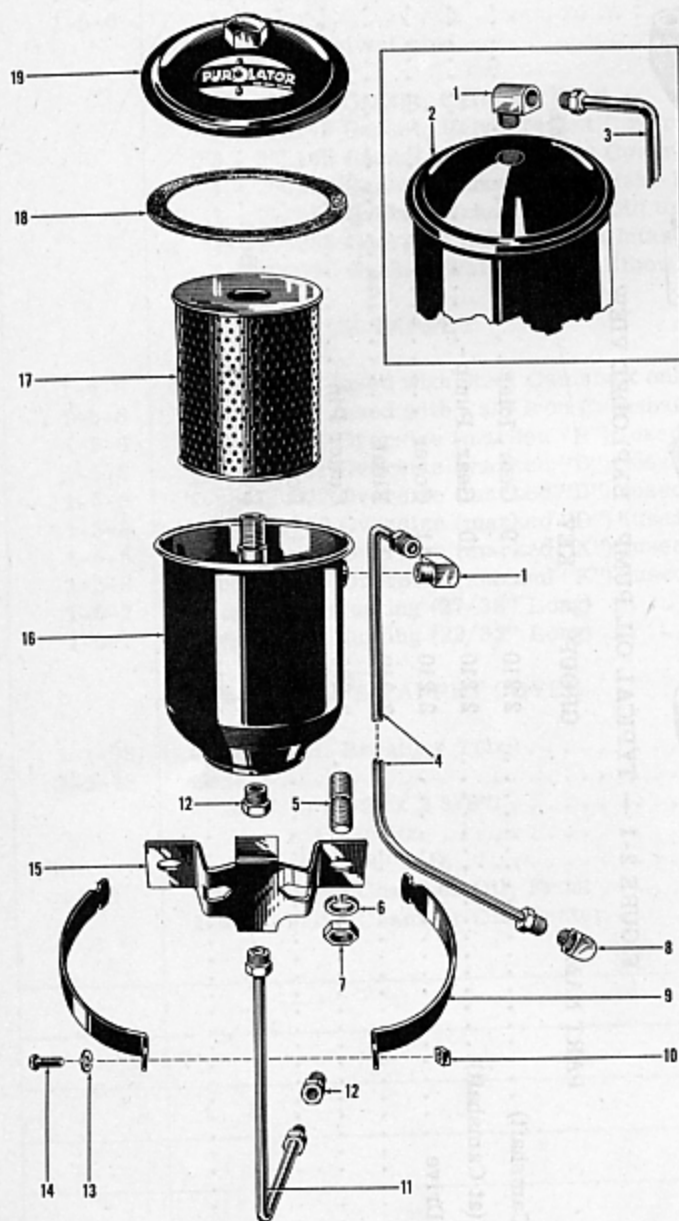

FIGURE 2-1 — TYPICAL OIL PUMP - EXPLODED VIEW

KEY	PART NAME	GROUP	KEY	PART NAME	GROUP
1	Gear, Drive (at Camshaft) . . . . .	2.210	9	Gear, Idler . . . . .	2.215
2	Pin, Drive Gear (at Camshaft) . . . . .	2.210	10	Gear, Pump . . . . .	2.210
3	Shaft Assembly, Drive . . . . .	2.210	11	Cover . . . . .	2.230
4	Key, Pump Gear . . . . .	2.210	12	Float . . . . .	2.235
5	Bushing, Body . . . . .	2.205	13	Cotter Pin . . . . .	2.235
6	Body Assembly . . . . .	2.205	14	Bolt, Cover . . . . .	2.230
7	Shaft, Idler Gear . . . . .	2.215	15	Lockwasher, Cover Bolt . . . . .	2.230
8	Gasket, Cover . . . . .	2.230			

FIGURE 2-2 — TYPICAL OIL FILTER - EXPLODED VIEW



KEY	PART NAME	GROUP
1	Elbow, Inlet Tube to Filter . . . . .	2.315
2	Filter (non-replaceable Element Type) . . . . .	2.300
3	Tube Assembly, Inlet . . . . .	2.315
4	Tube Assembly, Inlet . . . . .	2.315
5	Stud, Mounting . . . . .	2.300
6	Lockwasher, Mounting Stud . . . . .	2.300
7	Nut, Mounting . . . . .	2.300
8	Elbow, Inlet Tube to Block . . . . .	2.315
9	Strap, Mounting . . . . .	2.300
10	Nut, Mounting Strap . . . . .	2.300
11	Tube Assembly, Outlet . . . . .	2.316
12	Connector, Outlet Tube . . . . .	2.316
13	Lockwasher, Mounting Strap . . . . .	2.300
14	Bolt, Mounting Strap . . . . .	2.300
15	Bracket, Mounting . . . . .	2.300
16	Serviced only in Oil Filter Assembly . . . . .	
17	Element . . . . .	2.300
18	Gasket, Cover . . . . .	2.300
19	Cover . . . . .	2.300

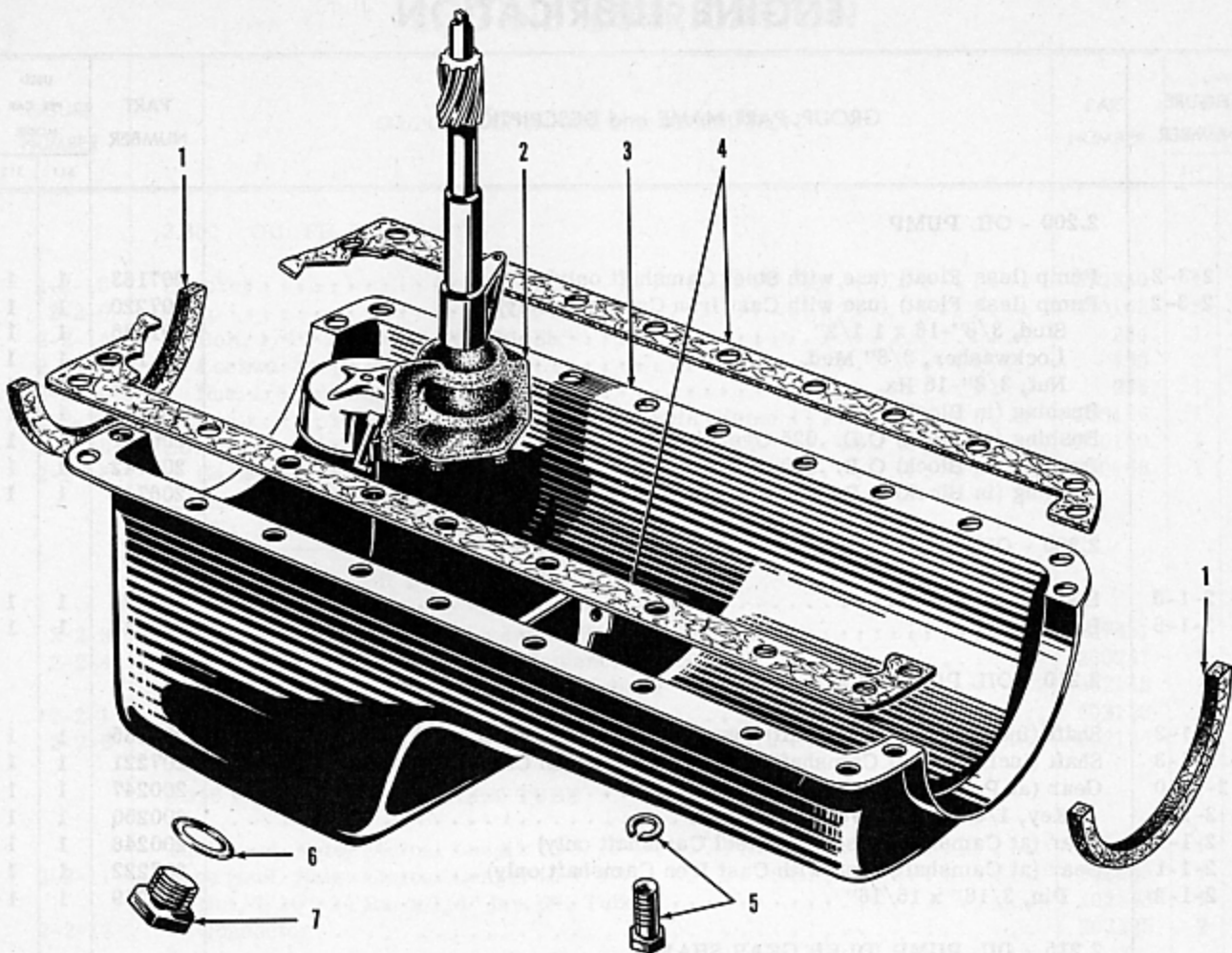

FIGURE 2-3 — OIL PAN - EXPLODED VIEW

KEY	PART NAME	GROUP	KEY	PART NAME	GROUP
1	Gasket, End .....	2.400	5	Bolt with L/W, Mounting .....	2.400
2	Pump, Oil .....	2.200	6	Gasket, Drain Plug .....	2.400
3	Pan .....	2.400	7	Plug, Drain .....	2.400
4	Gasket, Side .....	2.400			

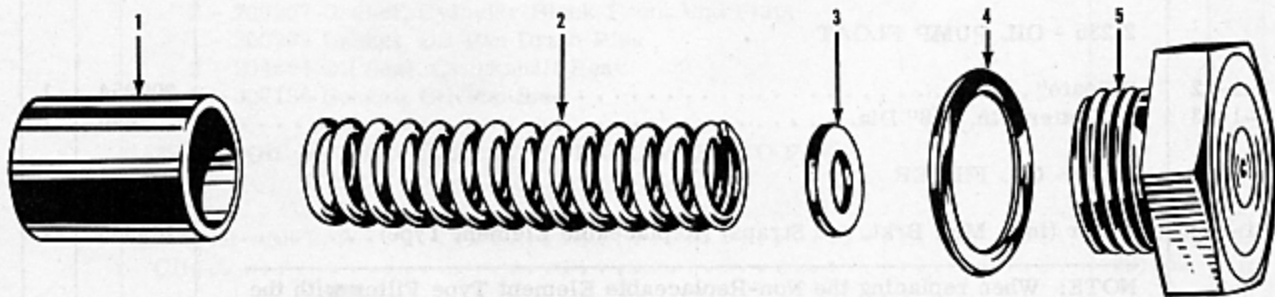

FIGURE 2-4 — OIL PRESSURE RELIEF VALVE - EXPLODED VIEW

KEY	PART NAME	GROUP	KEY	PART NAME	GROUP
1	Valve .....	2.410	4	Gasket .....	2.410
2	Spring .....	2.410	5	Plug .....	2.410
3	Washer .....	2.410			

## ENGINE LUBRICATION

FIGURE NUMBER	GROUP, PART NAME and DESCRIPTION	PART NUMBER	USED PER CAR MODEL	
			511	512
	<b>2.200 - OIL PUMP</b>			
2-3-2	Pump (less Float) (use with Steel Camshaft only) . . . . .	207183	1	1
2-3-2	Pump (less Float) (use with Cast Iron Camshaft only) . . . . .	207220	1	1
	Stud, 3/8"-16 x 1 1/2" . . . . .	201966	1	1
	Lockwasher, 3/8" Med. . . . .	192	1	1
	Nut, 3/8"-16 Hx. . . . .	204	1	1
	Bushing (in Block) Std. . . . .	200242	1	1
	Bushing (in Block) O.D. .025 Oversize (marked "XK"). . . . .	206741	1	1
	Bushing (in Block) O.D. .040 Oversize (marked "Z"). . . . .	206742	1	1
	Bushing (in Block) O.D. .050 Oversize (marked "ZW"). . . . .	206743	1	1
	<b>2.205 - OIL PUMP BODY</b>			
2-1-6	Body (incl. Bushing) . . . . .	207184	1	1
2-1-5	Bushing . . . . .	200244	1	1
	<b>2.210 - OIL PUMP DRIVE SHAFT</b>			
2-1-3	Shaft (incl. Gear at Camshaft) (use with Steel Camshaft only) . . . . .	203185	1	1
2-1-3	Shaft (incl. Gear at Camshaft) (use with Cast Iron Camshaft only) . . . . .	207221	1	1
2-1-10	Gear (at Pump). . . . .	200247	1	1
2-1-4	Key, 1/8" x 1/2" Woodruff No. 3. . . . .	200250	1	1
2-1-1	Gear (at Camshaft) (use with Steel Camshaft only) . . . . .	200248	1	1
2-1-1	Gear (at Camshaft) (use with Cast Iron Camshaft only) . . . . .	207222	1	1
2-1-2	Pin, 3/16" x 15/16" . . . . .	200249	1	1
	<b>2.215 - OIL PUMP IDLER GEAR SHAFT</b>			
2-1-7	Shaft . . . . .	200246	1	1
2-1-9	Gear . . . . .	200251	1	1
	<b>2.230 - OIL PUMP COVER</b>			
2-1-11	Cover. . . . .	200252	1	1
2-1-14	Bolt, 1/4"-20 x 5/8" Hx. Hd. . . . .	257	6	6
2-1-15	Lockwasher, 1/4" Med. . . . .	190	6	6
2-1-8	Gasket . . . . .	200253	1	1
	<b>2.235 - OIL PUMP FLOAT</b>			
2-1-12	"Floato" . . . . .	200254	1	1
2-1-13	Cotter Pin, 1/8" Dia. . . . .	496	1	1
	<b>2.300 - OIL FILTER</b>			
1-1-6	Filter (incl. Mtg. Brkt. and Straps) (Replaceable Element Type) . . . . .	209985	1	1
	<b>NOTE: When replacing the Non-Replaceable Element Type Filter with the above Filter, Inlet Tube, Part No. 200241, should be used.</b>			
2-2-2	Filter (less Mtg. Brkt. and Straps) (Non-Replaceable Element Type) . . . . .	208628	1	1
2-2-5	Stud, 3/8"-16 x 1 3/8" . . . . .	200164	2	2
2-2-6	Lockwasher, 3/8" Med. . . . .	192	2	2
2-2-7	Nut, 3/8"-16 Hx. . . . .	204	2	2
			{ to } { Block }	

# ENGINE LUBRICATION

2

FIGURE NUMBER	GROUP, PART NAME and DESCRIPTION	PART NUMBER	USED PER CAR MODEL	
			511	512
<b>2.300 - OIL FILTER (Cont'd)</b>				
2-2-15	Bracket .....	212840	1	1
2-2-9	Strap .....	200168	2	2
2-2-14	Bolt, 1/4"-20 x 3/4" Fil. Hd. Sl. ....	234	1	1
2-2-13	Lockwasher, 1/4" Med. ....	190	1	1
2-2-10	Nut, 1/4"-20 Sq. ....	235	1	1
2-2-17	Element ..... { Use with Element	200136	1	1
2-2-19	Cover ..... { Type Filter	200150	1	1
2-2-18	Gasket ..... { Part No. 209985. }	200166	1	1
<b>NOTE: For Dual Purpose Oil Filter See Group 40.145</b>				
<b>2.315 - OIL FILTER INLET TUBE</b>				
2-2-3	Tube (incl. Nuts) (Non-Replaceable Element Type Filter) .....	207451	1	1
2-2-4	Tube (incl. Nuts) (Replaceable Element Type Filter) .....	200241	1	1
	Nut, 7/16"-24 Hx. x 1/4" Inv. Fl. Tube. ....	202143	2	2
2-2-1	Elbow (at Filter) .....	202123	1	1
2-2-8	Elbow (at Block) .....	202124	1	1
<b>2.316 - OIL FILTER OUTLET TUBE</b>				
	Tube (incl. Nuts) (Actual Length 13 3/16") .....	200282	1	1
2-2-11	Tube (incl. Nuts) (Actual Length 10 1/8") .....	208695	1	1
	Nut, 7/16"-24 Hx. x 1/4" Inv. Fl. Tube .....	202143	2	2
2-2-12	Connector .....	202125	2	2
<b>2.400 - OIL PAN</b>				
2-3-3	Pan .....	207185	1	1
2-3-5	Bolt with L/W, 5/16"-18 x 3/4" Hx. Hd. ....	200353	18	18
2-3-7	Plug, Drain, 7/8"-18 Hx. ....	212954	1	1
2-3-6	Gasket, Drain Plug .....	200269	1	1
2-3-4	Gasket, Side .....	207186	2	2
2-3-1	Gasket, End .....	200267	2	2
	Gasket Set .....	208593	1	1
Consists of:				
2 - 200267 Gasket, Cylinder Block Front End Plate				
1 - 200269 Gasket, Oil Pan Drain Plug				
2 - 204654 Oil Seal, Crankshaft Rear				
2 - 207186 Gasket, Oil Pan Side				
<b>2.405 - OIL RETURN TUBE (VALVE CHAMBER TO PAN)</b>				
	Tube .....	201962	1	1
	Bolt with L/W .....	207449	1	1
	Clip .....	201963	1	1
<b>2.410 - OIL PRESSURE RELIEF VALVE</b>				
2-4-1	Valve .....	200270	1	1
2-4-2	Spring .....	200271	1	1
2-4-3	Washer .....	200272	*	*

\* As Required



# NOTES

Lined area for notes, featuring horizontal ruling lines and a faint background illustration of a mechanical assembly with various parts labeled with letters and numbers.