

FIGURE 8-1 — TYPICAL CLUTCH - 6 SPRING - EXPLODED VIEW

KEY	PART NAME	GROUP	KEY	PART NAME	GROUP
1	Cover, Pressure Plate	8.104	8	Eyebolt and Nut Assembly, Pressure Plate Lever	8.104
2	Spring, Pressure Plate Lever	8.104	9	Lever, Pressure Plate	8.104
3	Spring, Pressure Plate	8.104	10	Strut, Pressure Plate	8.104
4	Facing Set.	8.100	11	Plate Assembly, Pressure	8.104
5	Disc and Facing.	8.100	12	Bolt, Pressure Plate	8.104
6	Plate, Pressure	8.104	13	Lockwasher, Pressure Plate	8.104
7	Pin, Pressure Plate Lever	8.104			

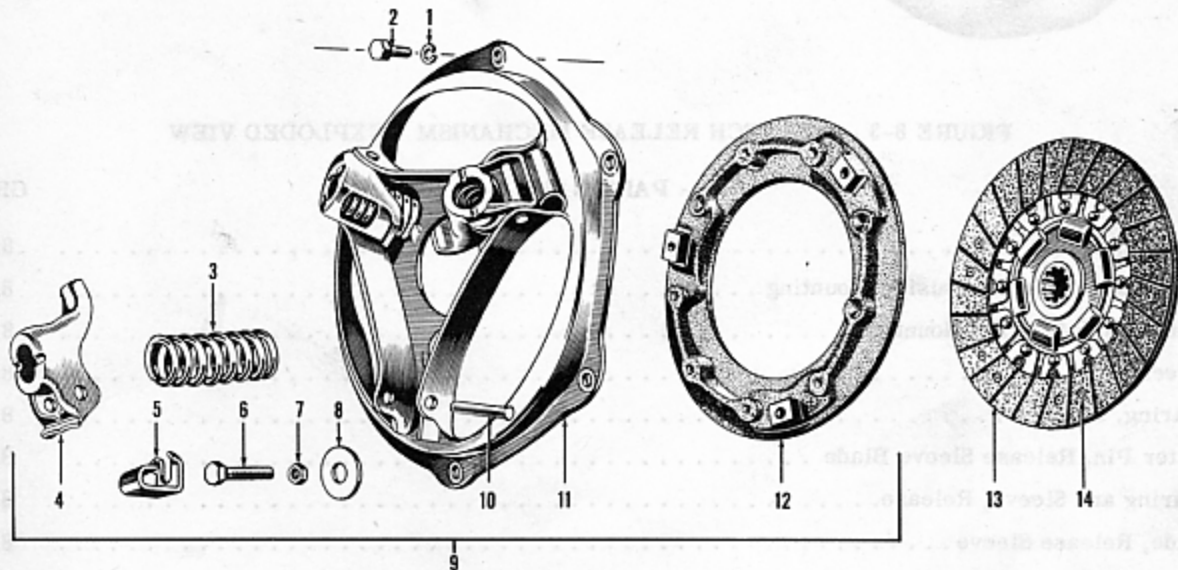

FIGURE 8-2 — TYPICAL CLUTCH - 3 SPRING - EXPLODED VIEW

KEY	PART NAME	GROUP	KEY	PART NAME	GROUP
1	Lockwasher, Pressure Plate Mounting	8.106	8	Flatwasher, Pressure Plate Lever Adjusting Screw	8.106
2	Bolt, Pressure Plate Mounting	8.106	9	Plate Assembly, Pressure	8.106
3	Spring, Pressure Plate	8.106	10	Pin, Pressure Plate Lever	8.106
4	Lever, Pressure Plate	8.106	11	Cover, Pressure Plate	8.106
5	Clip, Pressure Plate Lever	8.106	12	Plate, Pressure	8.106
6	Screw, Pressure Plate Lever Adjusting	8.106	13	Disc and Facing.	8.100
7	Locknut, Pressure Plate Lever Adjusting Screw	8.106	14	Facing Set.	8.100

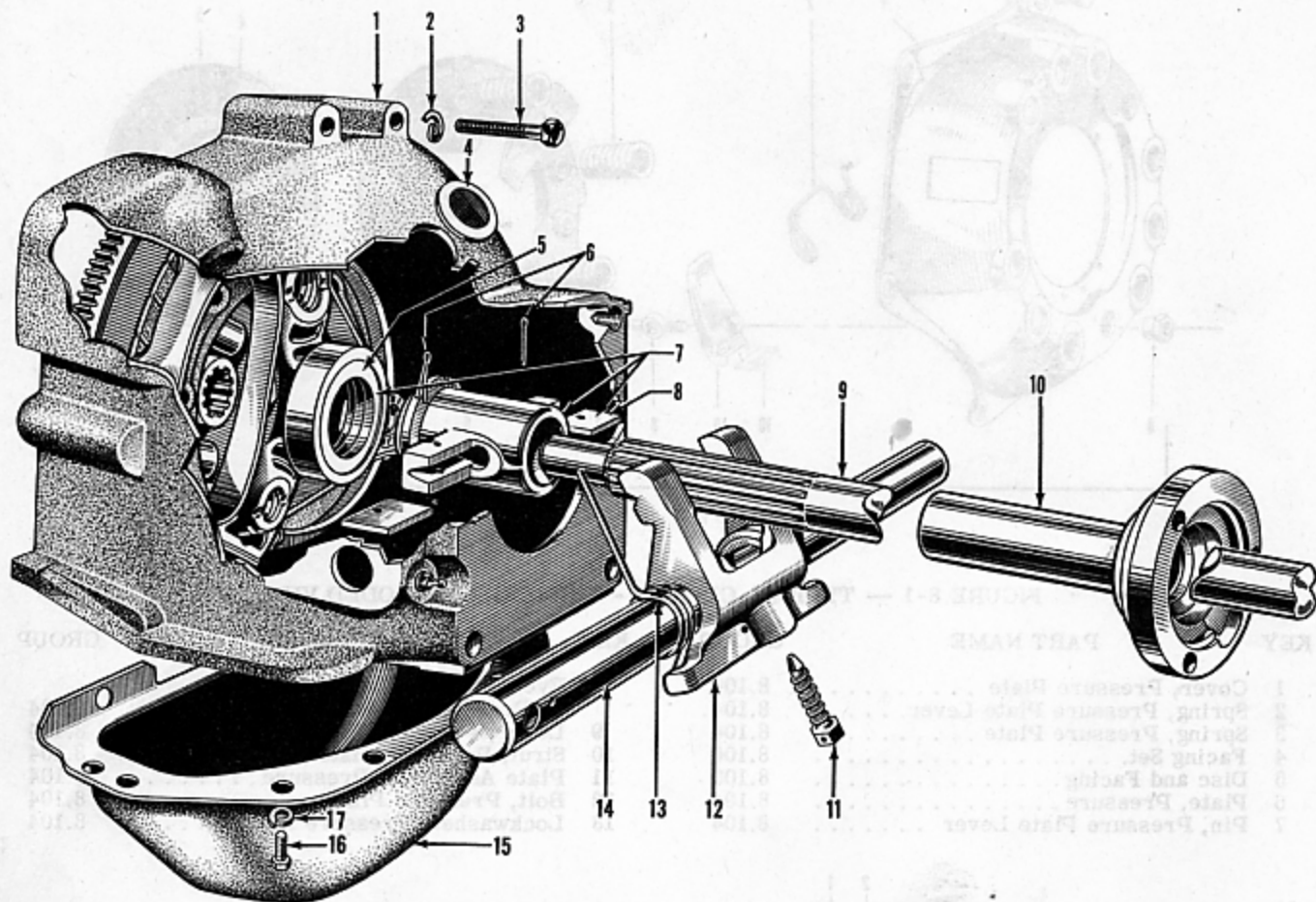

FIGURE 8-3 — CLUTCH RELEASE MECHANISM - EXPLODED VIEW

KEY	PART NAME	GROUP
1	Housing, Clutch	8.130
2	Lockwasher, Clutch Housing Mounting	8.130
3	Bolt, Clutch Housing Mounting	8.130
4	Screen	8.130
5	Bearing, Release	8.120
6	Cotter Pin, Release Sleeve Blade	8.120
7	Bearing and Sleeve, Release.	8.120
8	Blade, Release Sleeve	8.120
9	Pinion, Transmission Drive	9.100
10	Retainer, Transmission Drive Pinion Bearing	9.115
11	Set Screw, Release Fork	8.125
12	Fork, Release	8.125
13	Spring, Release Bearing	8.120
14	Shaft, Release	8.125
15	Pan, Housing	8.135
16	Bolt, Housing Pan Mounting	8.135
17	Lockwasher, Housing Pan Mounting Bolt	8.135

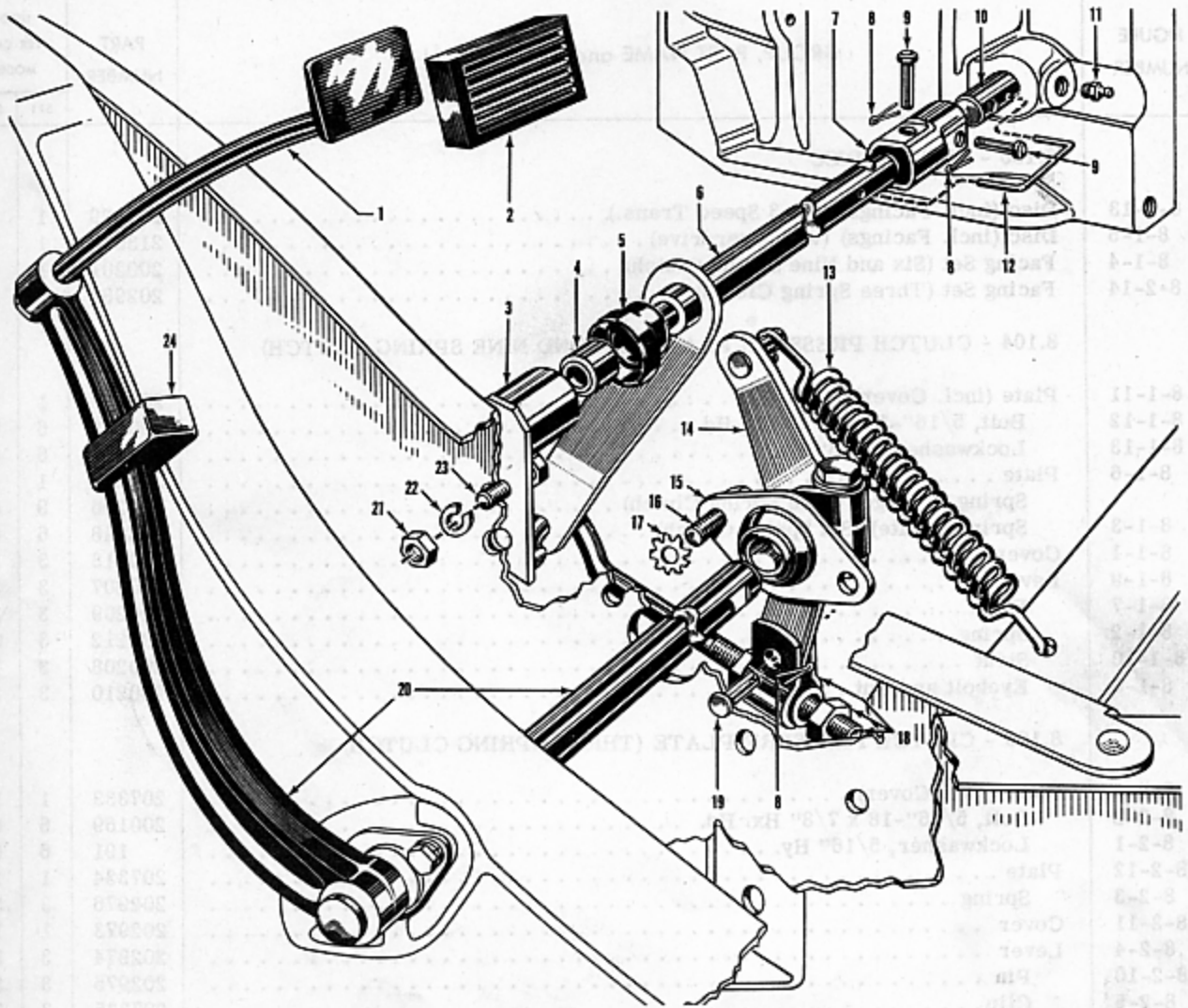

FIGURE 8-4 — TYPICAL CLUTCH LINKAGE - EXPLODED VIEW

KEY	PART NAME	GROUP	KEY	PART NAME	GROUP
1	Pedal	8.140	14	Lever Assembly, Pedal Shaft	8.145
2	Pad, Pedal	8.140	15	Bushing Assembly, Pedal Shaft	8.145
3	Support, Pedal Cross Shaft	8.155	16	Bolt, Pedal Shaft Bushing Assembly	8.145
4	Pivot, Pedal Cross Shaft	8.155	17	Lockwasher, Pedal Shaft Bushing Assembly	8.145
5	Dust Seal, Pedal Cross Shaft	8.155	18	Link Assembly, Adjusting	8.145
6	Shaft Assembly, Pedal Cross	8.155	19	Clevis Pin, Adjusting Link Assembly	8.145
7	Coupling, Pedal Cross Shaft	8.155	20	Shaft and Arm, Pedal	8.145
8	Cotter Pin	8.155	21	Nut, Pedal Cross Shaft Support	8.155
9	Clevis Pin	8.155	22	Lockwasher, Pedal Cross Shaft Support	8.155
10	Shaft, Release	8.130	23	Bolt, Pedal Cross Shaft Support	8.155
11	Oiler, Release Shaft	8.130	24	Bumper, Pedal	8.140
12	Spring, Pedal Cross Shaft Take-Up	8.155			
13	Spring, Pedal Return	8.140			

CLUTCH AND CONTROLS

FIGURE NUMBER	GROUP, PART NAME and DESCRIPTION	PART NUMBER	USED PER CAR MODEL	
			511	512
	8.100 - CLUTCH DISC			
8-2-13	Disc (incl. Facings) (for 3 Speed Trans.)	208629	1	1
8-1-5	Disc (incl. Facings) (with Overdrive)	213068	1	1
8-1-4	Facing Set (Six and Nine Spring Clutch)	200201	1	1
8-2-14	Facing Set (Three Spring Clutch)	202981	1	1
	8.104 - CLUTCH PRESSURE PLATE (SIX AND NINE SPRING CLUTCH)			
8-1-11	Plate (incl. Cover)	208630	1	1
8-1-12	Bolt, 5/16"-18 x 7/8" Hx. Hd.	200169	6	6
8-1-13	Lockwasher, 5/16" Hy.	191	6	6
8-1-6	Plate	208631	1	1
	Spring (Orange) (Nine Spring Clutch)	200206	9	9
8-1-3	Spring (White) (Six Spring Clutch)	208648	6	6
8-1-1	Cover	200213	3	3
8-1-9	Lever	200207	3	3
8-1-7	Pin	200209	3	3
8-1-2	Spring	200212	3	3
8-1-10	Strut	200208	3	3
8-1-8	Eyebolt and Nut	200210	3	3
	8.106 - CLUTCH PRESSURE PLATE (THREE SPRING CLUTCH)			
8-2-9	Plate (incl. Cover)	207333	1	1
8-2-2	Bolt, 5/16"-18 x 7/8" Hx. Hd.	200169	6	6
8-2-1	Lockwasher, 5/16" Hy.	191	6	6
8-2-12	Plate	207334	1	1
8-2-3	Spring	202976	3	3
8-2-11	Cover	202973	1	1
8-2-4	Lever	202974	3	3
8-2-10	Pin	202975	3	3
8-2-5	Clip	207335	3	3
8-2-8	Flatwasher	207336	3	3
8-2-6	Screw, Adjusting	202977	3	3
8-2-7	Locknut	202978	3	3
	8.120 - CLUTCH RELEASE BEARING			
8-3-7	Bearing and Sleeve (incl. Blades)	207257	1	1
8-3-5	Bearing	205745	1	1
8-3-13	Spring	200217	2	2
8-3-8	Blade	207258	2	2
8-3-6	Cotter Pin, 3/32" Dia.	791	4	4
	8.125 - CLUTCH RELEASE FORK			
8-3-12	Fork	200215	1	1
8-3-11	Set Screw	200216	1	1
	Lockwire, 1/32" x 3"		*	*
8-3-14	Shaft	207928	1	1
	8.130 - CLUTCH HOUSING			
8-3-1	Housing (less Hydra-Matic)	207268	1	1
	Bolt, 7/16"-14 x 1 1/8" Hx. Hd.	213	1	1

* As Required

CLUTCH AND CONTROLS

8

FIGURE NUMBER	GROUP, PART NAME and DESCRIPTION	PART NUMBER	USED PER CAR MODEL	
			511	512
	8.130 - CLUTCH HOUSING (Cont'd)			
	Bolt, 7/16"-14 x 1 1/2" Hx. Hd.	435	2	2
8-3-3	Bolt, 7/16"-14 x 3 3/8" Hx. Hd.	841	2	2
	Dowel Screw	207269	2	2
8-3-2	Lockwasher, 7/16"	193	5	5
8-3-4	Screen	206517	3	3
8-4-11	Oiler, 1/8" Pipe Thd. Straight	202120	2	2
	#Housing (incl. Front and Rear) (with Hydra-Matic)	209340	1	1
	†Housing (incl. Front and Rear) (with Hydra-Matic)	209405	1	1
	Dowel Pin (to Front Housing)	209011	2	2
	Dowel Screw	207269	2	2
	Bolt, 7/16"-14 x 1 1/2" Hx. Hd.	435	4	4
	Bolt, 7/16"-14 x 1 3/4" Hx. Hd.	431	4	4
	Bolt, 7/16"-14 x 1 1/8" Hx. Hd.	213	1	1
	Lockwasher, 7/16" Med.	193	6	6
	8.135 - CLUTCH HOUSING PAN			
8-3-15	Pan (less Hydra-Matic)	200174	1	1
8-3-16	Bolt, 5/16"-18 x 1 1/2" Hx. Hd.	322	2	2
8-3-17	Lockwasher, 5/16" Ext. Tooth	348	2	2
8-3-16	Bolt, 1/4"-20 x 1/2" Hx. Hd.	179	6	6
8-3-17	Lockwasher, 1/4" Ext. Tooth	370	6	6
	Pan (with Hydra-Matic)	209010	1	1
	Bolt, 5/16"-18 x 5/8" Hx. Hd.	208	4	4
	Lockwasher, 5/16" Ext. Tooth	348	4	4
	8.140 - CLUTCH PEDAL			
8-4-1	Pedal	207929	1	1
	Locknut, 3/8"-24 Hx.	202257	1	1
8-4-13	Spring, Return	207930	1	1
	Dust Seal (Felt) (2" Sq.)	207931	1	1
8-4-24	Bumper (Rubber)	207932	1	1
8-4-2	Pad (Black)	204232	1	1
	Plug, Hole (with Hydra-Matic)	202940	1	1
	8.145 - CLUTCH PEDAL SHAFT			
8-4-20	Shaft and Arm	207933	1	1
8-4-15	Bushing (incl. Retainer)	207934	2	2
8-4-16	Bolt, 5/16"-24 x 7/8" Hx. Hd.	270	4	4
8-4-17	Lockwasher, 5/16" Ext. Tooth	348	4	4
8-4-14	Lever (incl. Pin)	207935	1	1
	Bolt, 3/8"-24 x 2" Hx. Hd.	913	1	1
	Flatwasher, 3/8" Sm.	247	2	2
	Locknut, 3/8"-24 Hx.	203311	1	1
8-4-18	Link, Adjusting (incl. Guide and Nuts)	212764	1	1
	Nut, Guide to Link, 3/8"-24 Hx. Lt.	188	2	2
8-4-19	Clevis Pin	207938	1	1
8-4-8	Cotter Pin, 3/32" Dia.	791	1	1

Parts Peculiar to Model K50 Transmission

†Parts Peculiar to Model K51 Transmission

NOTES

1301E.81 - LACHE JAVIERRE - COMPLET E. LACHE JAVIERRE

