

FIGURE 14-1 — TYPICAL STEERING GEAR - EXPLODED VIEW

KEY	PART NAME	GROUP	KEY	PART NAME	GROUP
1	Locknut, Shaft and Roller	14.116	12	Roller and Cage, Worm Thrust Bearing	14.114
2	Lockplate, Shaft and Roller	14.116	13	Column and Worm	14.110
3	Oil Plug, Shaft and Roller Cover	14.118	14	Cup, Worm Thrust Bearing, Lower . . .	14.112
4	Bolt, Cover	14.118	15	Shim, Column and Worm	14.110
5	Cover, Shaft and Roller	14.118	16	Cover, Housing End	14.104
6	Thrustwasher, Shaft and Roller	14.116	17	Housing	14.102
7	Screw, Shaft and Roller Adjusting	14.116	18	Seal, Shaft and Roller	14.116
8	Gasket, Shaft and Roller Cover	14.118	19	Arm (Pitman)	14.200
9	Shaft and Roller	14.116	20	Lockwasher, Lever Arm	14.200
10	Bushing, Housing	14.102	21	Nut, Pitman Arm	14.200
11	Cup, Worm Thrust Bearing, Upper . . .	14.112	22	Nut, Steering Wheel	14.126

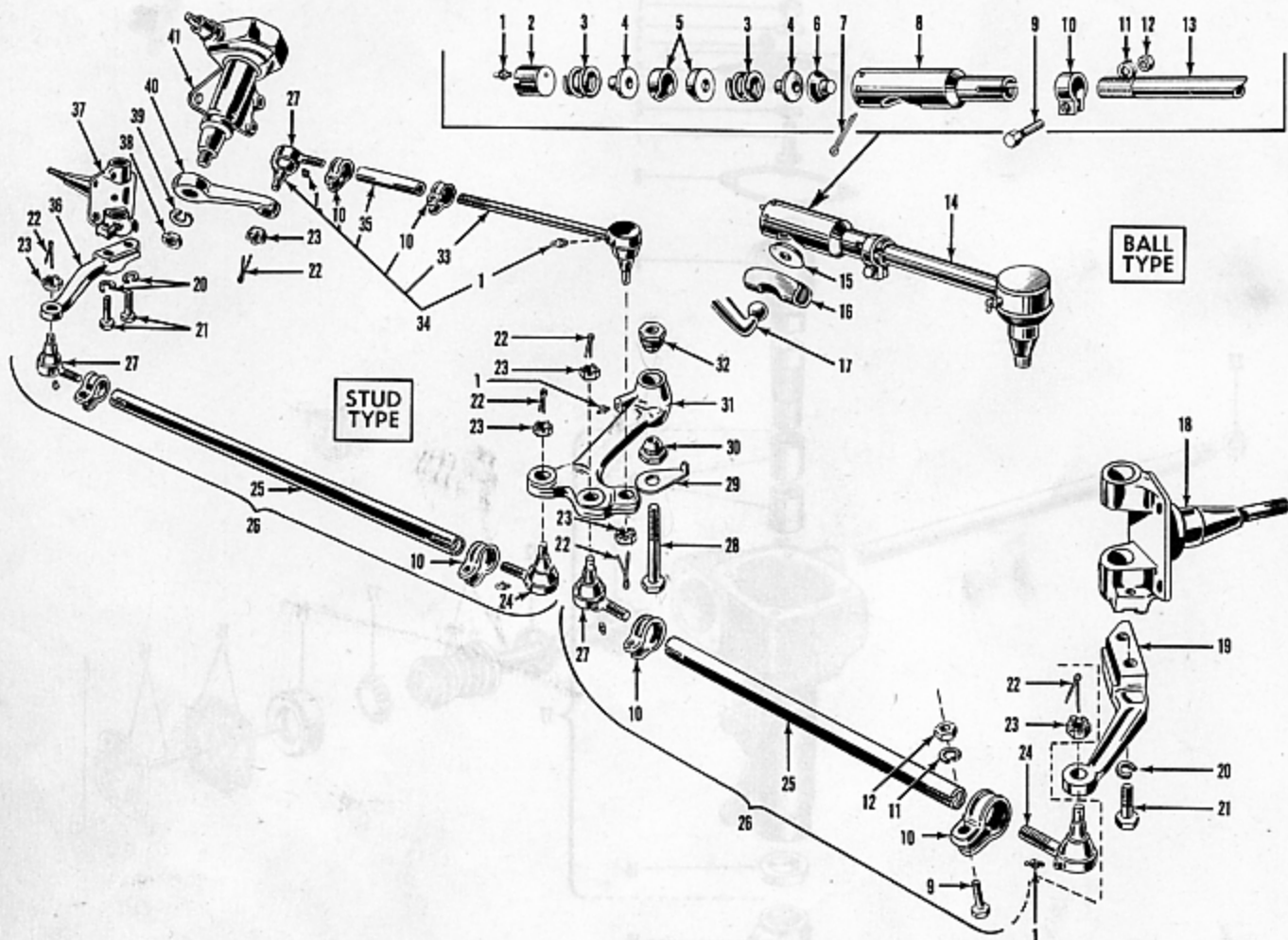

FIGURE 14-2 — STEERING CONTROL - EXPLODED VIEW

KEY	PART NAME	GROUP	KEY	PART NAME	GROUP
1	Oiler, Drag Link Socket	14.206	22	Cotter Pin	14.206
2	Plug, Drag Link Socket	14.206	23	Nut	14.216
3	Spring, Drag Link Socket	14.206	24	Tie Rod End	14.216
4	Bumper, Drag Link Socket	14.206	25	Serviced only in Tie Rod Assembly . . .	
5	Bearing, Drag Link Socket	14.206	26	Tie Rod Assembly	14.216
6	Seat, Drag Link Socket	14.206	27	Tie Rod End	14.216
7	Cotter Pin, Drag Link Socket	14.206	28	Bolt, Idler Lever	14.212
8	Socket, Drag Link.	14.206	29	Lock, Idler Lever Bolt	14.212
9	Bolt	14.202	30	Bearing, Idler Lever Lower	14.212
10	Clamp	14.202	31	Lever, Idler	14.212
11	Lockwasher	14.202	32	Bearing, Idler Lever Upper	14.212
12	Nut	14.202	33	Serviced only in Drag Link Assembly. .	
13	Serviced only in Drag Link Assembly. .		34	Drag Link Assembly (Stud Type)	14.202
14	Drag Link Assembly (Ball Type)	14.202	35	Adjusting Link	14.202
15	Shield.	14.204	36	Arm, Steering Knuckle, Left	13.006
16	Cover.	14.204	37	Knuckle, Left.	13.000
17	Arm, Pitman Lever	14.200	38	Nut, Pitman Lever Arm	14.200
18	Knuckle, Right.	13.000	39	Lockwasher.	14.200
19	Arm, Steering Knuckle, Right.	13.006	40	Arm, Pitman Lever	14.200
20	Lockwasher	13.006	41	Steering Gear	14.100
21	Bolt.	13.006			

STEERING

14

FIGURE NUMBER	GROUP, PART NAME and DESCRIPTION	PART NUMBER	USED PER CAR MODEL	
			511	512
			14.100 - STEERING GEAR	
14-2-41	Gear (incl. Column and Shaft)	208369	1	1
	Bolt, 7/16"-14 x 4 1/2" Hx. Hd.	606	3	3
	Flatwasher	201471	3	3
	Lockwasher, 7/16"	193	3	3
	Bolt, 7/16"-20 x 4 3/4" Hx. Hd.	935	3	3
	Locknut, 7/16"-20 Hx	202296	3	3
14.102 - STEERING GEAR HOUSING				
14-1-17	Housing (incl. Shaft Bushing and Upper Bearing Cup)	208370	1	1
14-1-10	Bushing	201196	2	2
14.104 - STEERING GEAR HOUSING END COVER				
14-1-16	Cover (incl. Grease Tube)	201193	1	1
14-1-4	Bolt	202758	4	4
14.106 - STEERING COLUMN JACKET				
	Jacket (incl. Bearing) (Prime)	208371	1	1
	Weatherseal (Front) (thru Dash)	208661	1	1
	Weatherseal (Rear) (thru Dash)	208372	1	1
	Fastener	205063	4	4
9-12-24	Jacket (less Bearing) (Prime)	209283	1	1
	Weatherseal (Front) (thru Dash)	208662	1	1
	Weatherseal (Rear) (thru Dash)	208663	1	1
	Fastener	205063	4	4
14.108 - STEERING COLUMN JACKET BEARING				
	Bearing	208373	1	1
	Spacer	208374	1	1
	Spring	212794	1	1
9-12-26	Retainer (with Hydra-Matic)	209324	1	1
14.110 - STEERING GEAR COLUMN AND WORM				
14-1-13	Column and Worm	208376	1	1
14-1-15	Shim, .002	201190	*	*
14-1-15	Shim, .005	201191	*	*
14-1-15	Shim, .010	201192	*	*
14.112 - STEERING GEAR WORM THRUST BEARING CUP				
14-1-11	Cup, Upper	201188	1	1
14-1-14	Cup, Lower	201189	1	1
14.114 - STEERING GEAR WORM THRUST BEARING ROLLER AND CAGE				
14-1-12	Roller and Cage	201187	2	2

*As Required

STEERING

FIGURE NUMBER	GROUP, PART NAME and DESCRIPTION	PART NUMBER	USED PER CAR MODEL	
			511	512
	14.116 - STEERING GEAR SHAFT AND ROLLER			
14-1-9	Shaft and Roller	208377	1	1
14-1-18	Seal	201197	1	1
14-1-7	Screw, Adjusting, 1/2"-20	201198	1	1
14-1-1	Locknut, 1/2"-20 Hx.	201200	1	1
14-1-2	Lockplate	201199	1	1
14-1-6	Thrustwasher	202760	1	1
	14.118 - STEERING GEAR SHAFT COVER			
14-1-5	Cover	202761	1	1
14-1-4	Bolt, 5/16"-18 x 9/16" Hx. Hd.	202758	4	4
14-1-3	Plug, Oil	201204	1	1
14-1-8	Gasket	201203	1	1
	14.120 - STEERING GEAR SUPPORT (AT INSTRUMENT PANEL)			
	Clamp (incl. Studs) (Lower)	208378	1	1
	Shim (around Jacket)	208380	1	1
	Clamp (Upper)	208379	1	1
	Support Rod, Inner	208381	1	1
	Support Rod, Outer	208382	1	1
	Lockwasher, 1/4" Med.	190	2	2
	Nut, 1/4"-20 Hx.	203	2	2
	Flatwasher	247	4	4
	Lockwasher, 3/8" Med.	192	4	4
	Nut, 3/8"-16 Hx.	204	4	4
	Anti-Squeak	201806	4	4
	Clamp (Lower)	209699	1	1
	Shim	208380	1	1
	Support Assembly	209783	1	1
	Bolt and L/W (Clamp to Support) 1/4"-20 x 1 1/4" Ov. Hd. Ct'sk.	209784	2	2
	Flatwasher	247	4	4
	Lockwasher, 3/8" Med.	192	4	4
	Nut, 3/8"-16 Hx.	204	4	4
	Anti-Squeak	201806	4	4
	14.122 - STEERING GEAR JACKET COVER (LESS HYDRA-MATIC)			
7-6-1	Cover (Upper)	208383	1	
7-6-3	Cover (Lower)	208384	1	
	Screw (Lower Cover to Upper Bracket)	821	3	
	Screw, No. 10-12 x 3/8" Rd. Hd. Cr. Rec. Tap. (Chrome)	875	7	
	Screw, Washer Head (Jacket to Lower Cover Bracket)	205680	2	
	Filler (Upper Cover to Inst. Panel)	208385	1	
	Bracket	208389	1	
	Clamp (incl. Studs)	208386	1	
	Lockwasher, No. 10 Ext. Tooth.	294	2	
	Nut, No. 10-32 Hx.	202	2	
	Bracket (incl. Studs)	209782	1	
	Clamp	209785	1	
	Lockwasher, No. 10 Ext. Tooth.	294	2	
	Nut, No. 10-32 Hx.	202	2	
	Collar (Jacket to Cover Support, Upper)	208388	1	

FIGURE NUMBER	GROUP, PART NAME and DESCRIPTION	PART NUMBER	USED PER CAR MODEL	
			511	512
	14.122 - STEERING GEAR JACKET COVER (LESS HYDRA-MATIC) (Cont'd)			
	Screw, No. 10-24 x 7/8" Rd. Hd. Sl.	401		1
	Lockwasher, No. 10 Ext. Tooth.	294		1
	Nut, No. 10-24 Hx.	378		1
	Support (Cover to Collar).	208387		1
	Screw, No. 8-15 x 3/8" Rd. Hd. Cr. Rec. Tap.	576		3
	14.126 - STEERING WHEEL			
7-6-6	Steering Wheel (incl. Cancelling Pins) (Rubber, Painted Starlight Pearl). . . .	208390	1	1
7-6-6	Steering Wheel (incl. Cancelling Pins) (Starlight Pearl Plastic).	209786	1	1
7-6-13	Nut, 5/8"-18 Hx.	201206	1	1
	14.200 - STEERING GEAR LEVER ARM (PITMAN)			
14-2-40	Arm (with Stud Connection to Drag Link).	208391	1	1
14-2-17	Arm (with Ball Connection to Drag Link).	212386	1	1
14-2-39	Lockwasher.	201216	1	1
14-2-38	Nut	201217	1	1
	14.202 - STEERING DRAG LINK			
14-2-34	Link (Bent) (less Oiler) { with Stud Connection to Pitman Arm }	209725	1	1
14-2-14	Link (less Oiler) (with Ball Connection to Pitman Arm).	212387	1	1
14-2-23	Nut, 1/2"-20 Hx. Sl.	486	*	*
14-2-22	Cotter Pin, 3/32" Dia.	791	*	*
14-2-10	Clamp	201221	*	*
14-2-9	Bolt.	201222	*	*
14-2-11	Lockwasher, 5/16" Hy.	191	*	*
14-2-12	Nut, 5/16"-24 Hx. Lt.	189	*	*
14-2-35	Adjusting Link (used only on 209725)	208393	1	1
	Oiler	202575	2	2
	14.204 - STEERING DRAG LINK STUD COVER			
	Cover.	201219	1	1
14-2-15	Shield (Steering Gear End).	201520	1	1
14-2-16	Cover (Steering Gear End).	201519	1	1
	14.206 - STEERING DRAG LINK END AND SOCKET			
14-2-27	Drag Link End (R.H. Thd.) { used with Drag Link with Stud Connection to Pitman Arm }	201236	1	1
14-2-23	Nut, 1/2"-20 Hx. Sl.	486	2	2
14-2-22	Cotter Pin, 3/32"	791	2	2
14-2-10	Clamp	201221	*	*
14-2-9	Bolt.	201222	*	*
14-2-11	Lockwasher, 5/16" Hy.	191	*	*
14-2-12	Nut, 5/16"-24 Hx. Lt.	189	*	*
14-2-8	Socket	202077	1	1
14-2-5	Bearing	201226	2	2
14-2-3	Spring	201225	2	2
14-2-6	Seat.	201223	1	1
14-2-4	Bumper	201224	2	2
14-2-2	Plug.	202078	1	1
14-2-7	Cotter Pin, 1/8"	496	1	1

* As Required

FIGURE NUMBER	GROUP, PART NAME and DESCRIPTION	PART NUMBER	USED PER CAR MODEL	
			511	512
	14.206 - STEERING DRAG LINK END AND SOCKET (Cont'd)			
14-2-1	Oiler (Straight)	202121	1	1
	Oiler (90°)	202575	1	1
	14.212 - STEERING IDLER LEVER KIT 212890 7 ⁸⁵			
14-2-31	Lever	207223	1	1
14-2-32	Bearing, Upper	207225	1	1
14-2-30	Bearing, Lower	207224	1	1
14-2-28	Bolt, 1/2"-20 x 3 1/4" Hx. Hd.	838	1	1
14-2-29	Lock	207226	1	1
14-2-1	Oiler (Straight)	202121	1	1
	14.216 - STEERING TIE ROD			
14-2-26	Tie Rod (incl. Seals and Nuts)	201235	2	2
14-2-27	Tie Rod End (R.H. Thd.)	201236	2	2
14-2-24	Tie Rod End (L.H. Thd.)	201237	2	2
14-2-23	Nut, 1/2"-20 Hx. Sl.	486	4	4
14-2-22	Cotter Pin, 3/32" Dia	791	4	4
14-2-10	Clamp	201221	4	4
14-2-9	Bolt, 5/16"-24 x 1 7/16" Hx. Hd.	201222	4	4
14-2-11	Lockwasher, 5/16" Hy.	191	4	4
14-2-12	Nut, 5/16"-24 Hx	189	4	4
14-2-1	Oiler (Straight)	202121	4	4
	Cover	201219	4	4
	Repair Kit.	205783	2	2
	Consists of:			
	1 - 201236 Tie Rod End, R.H. Thd.			
	1 - 201237 Tie Rod End, L. H. Thd.			
	2 - 480 Cotter Pin			
	2 - 201222 Bolt			
	2 - 191 Lockwasher			
	2 - 189 Nut			