

FIGURE 14-1—TYPICAL STEERING GEAR—EXPLODED VIEW

KEY	PART NAME	GROUP	KEY	PART NAME	GROUP
1	Locknut, Shaft and Roller . . . . .	14.116	13	Column and Worm . . . . .	14.110
2	Lockplate, Shaft and Roller . . . . .	14.116	14	Cup, Worm Thrust Bearing, Lower . .	14.112
3	Oil Plug, Shaft and Roller Cover . . .	14.118	15	Shim, Column and Worm . . . . .	14.110
4	Bolt, Cover . . . . .	14.118	16	Cover, Housing End . . . . .	14.104
5	Cover, Shaft and Roller . . . . .	14.118	17	Housing Assembly . . . . .	14.102
6	Thrustwasher, Shaft and Roller . . . .	14.116	18	Seal, Shaft and Roller . . . . .	14.116
7	Screw, Shaft and Roller Adjusting . . .	14.116	19	Arm (Pitman) . . . . .	14.200
8	Gasket, Shaft and Roller Cover . . . .	14.118	20	Lockwasher, Lever Arm . . . . .	14.200
9	Shaft and Roller . . . . .	14.116	21	Nut, Pitman Arm . . . . .	14.200
10	Bushing, Housing . . . . .	14.102	22	Nut, Steering Wheel . . . . .	14.126
11	Cup, Worm Thrust Bearing, Upper . .	14.112			
12	Roller and Cage, Worm Thrust Bearing . . . . .	14.114			

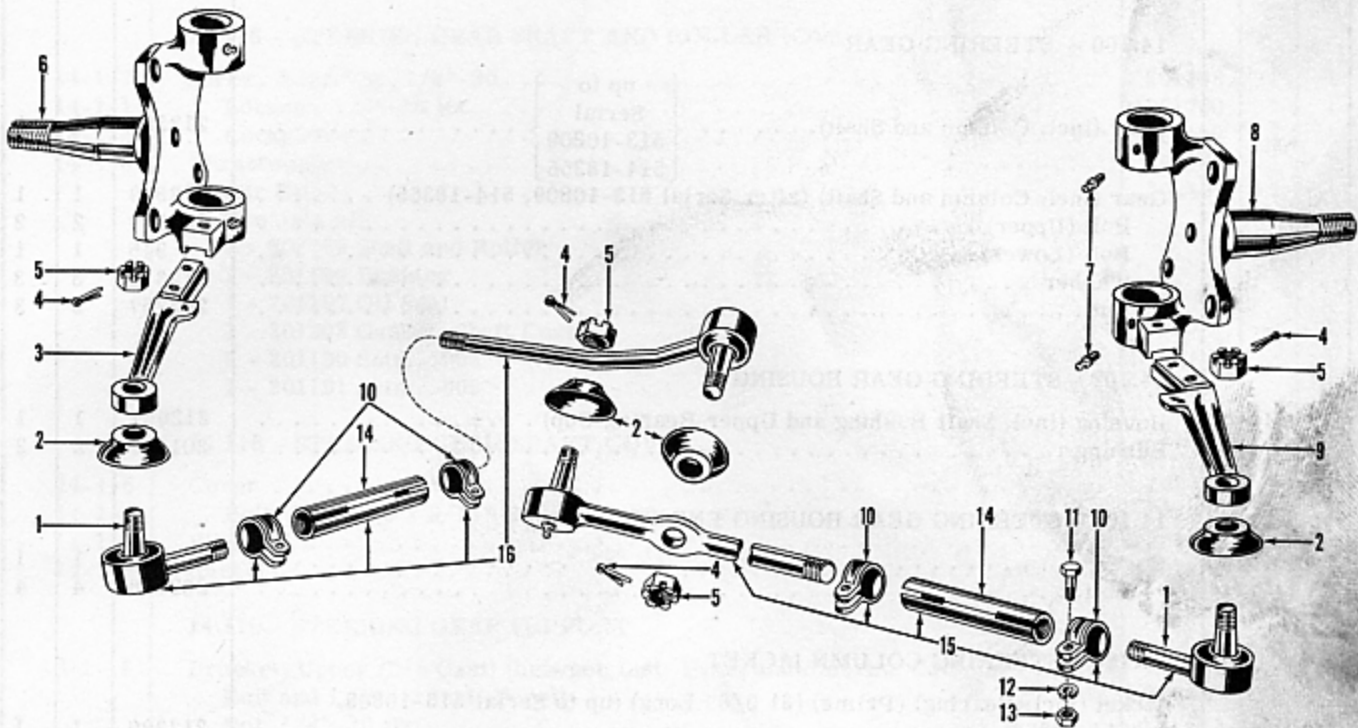

FIGURE 14-2—STEERING CONTROL—EXPLODED VIEW

KEY	PART NAME	GROUP
1	Tie Rod End, Steering . . . . .	14.216
2	Dust Seal, Steering Tie Rod . . . . .	14.216
3	Arm, Steering Knuckle, Left . . . . .	13.006
4	Cotter Pin . . . . .	14.216
5	Nut . . . . .	14.216
6	Knuckle, Steering, Left . . . . .	13.000
7	Oiler, Steering Knuckle . . . . .	13.000
8	Knuckle, Steering, Right . . . . .	13.000
9	Arm, Steering Knuckle, Right . . . . .	13.006
10	Clamp, Steering Tie Rod. . . . .	14.216
11	Bolt . . . . .	14.216
12	Lockwasher . . . . .	14.216
13	Nut . . . . .	14.216
14	Adjusting Link, Steering Tie Rod . . . . .	14.216
15	Tie Rod and Ball Stud, Steering, Right . . . . .	14.216
16	Tie Rod and Ball Stud, Steering, Left . . . . .	14.216

## STEERING

FIGURE NUMBER	GROUP, PART NAME and DESCRIPTION	PART NUMBER	USED PER CAR MODEL	
			513	514
	<b>14.100 - STEERING GEAR</b>			
	Gear (incl. Column and Shaft) . . . . . { up to Serial 513-10809 } . . . . .	212388	1	1
	Gear (incl. Column and Shaft) (after Serial 513-10809, 514-18355) . . . . .	212829	1	1
	Bolt (Upper) . . . . .	201169	2	2
	Bolt (Lower) . . . . .	945	1	1
	Washer . . . . .	212389	3	3
	Nut . . . . .	202257	3	3
	<b>14.102 - STEERING GEAR HOUSING</b>			
14-1-17	Housing (incl. Shaft Bushing and Upper Bearing Cup) . . . . .	212657	1	1
14-1-10	Bushing . . . . .	201196	2	2
	<b>14.104 - STEERING GEAR HOUSING END COVER</b>			
14-1-16	Cover . . . . .	201193	1	1
14-1-4	Bolt . . . . .	202758	4	4
	<b>14.106 - STEERING COLUMN JACKET</b>			
	Jacket (incl. Bearing) (Prime) (31 5/8" Long) (up to Serial 513-10809, 514-18355) . . . . .	212390	1	1
	Jacket (incl. Bearing) (Prime) (32 5/8" Long) (after Serial 513-10809, 514-18355) . . . . .	212817	1	1
	Seal . . . . .	212391	1	1
	Screw, No. 10-12 x 1" Ov. Hd. Cr. Rec. Tap . . . . .	979	6	6
	<b>14.108 - STEERING COLUMN JACKET BEARING</b>			
	Bearing . . . . .	208373	1	1
	Spacer . . . . .	208374	1	1
	Spring . . . . .	201179	1	1
	<b>14.110 - STEERING GEAR COLUMN AND WORM</b>			
14-1-13	Column and Worm, 36 7/8" Long (up to Serial 513-10809, 514-18355) . . . . .	212658	1	1
14-1-15	Column and Worm, 37 7/8" Long (after Serial 513-10809, 514-18355) . . . . .	212830	1	1
14-1-15	Shim, .002 . . . . .	201190	*	*
14-1-15	Shim, .005 . . . . .	201191	*	*
14-1-15	Shim, .010 . . . . .	201192	*	*
	<b>14.112 - STEERING GEAR WORM THRUST BEARING CUP</b>			
14-1-11	Cup, Upper . . . . .	201188	1	1
14-1-14	Cup, Lower . . . . .	201189	1	1
	<b>14.114 - STEERING GEAR WORM THRUST BEARING ROLLER AND CAGE</b>			
14-1-12	Roller and Cage . . . . .	201187	2	2
	<b>14.116 - STEERING GEAR SHAFT AND ROLLER</b>			
14-1-9	Shaft and Roller . . . . .	202759	1	1
14-1-18	Seal . . . . .	201197	1	1

# STEERING

FIGURE NUMBER	GROUP, PART NAME and DESCRIPTION	PART NUMBER	USED PER CAR MODEL	
			513	514
<b>14.116 - STEERING GEAR SHAFT AND ROLLER (Cont'd)</b>				
14-1-7	Screw, Adjusting, 1/2"-20.....	201198	1	1
14-1-1	Locknut, 1/2"-20 Hx. ....	201200	1	1
14-1-2	Lockplate.....	201199	1	1
14-1-6	Thrustwasher.....	202760	1	1
	Repair Kit.....	206407	1	1
	Consists of:			
	1 - 202759 Shaft and Roller			
	2 - 201196 Bushing			
	1 - 201197 Oil Seal			
	1 - 201203 Gasket, Shaft Cover			
	2 - 201190 Shim, .002			
	2 - 201191 Shim, .005			
<b>14.118 - STEERING GEAR SHAFT COVER</b>				
14-1-5	Cover.....	202761	1	1
14-1-4	Bolt, 5/16"-18 x 9/16" Hx. Hd.....	202758	4	4
14-1-3	Plug, Oil.....	201204	1	1
14-1-8	Gasket.....	201203	1	1
<b>14.120 - STEERING GEAR SUPPORT</b>				
19-1-16	Bracket, Upper (Die Cast) (between Inst. Panel and Steering Column).....	212544	1	1
	Bolt and L/W (to Inst. Panel).....	212663	2	2
	Nut, 1/4"-20 Hx. ....	203	2	2
	Anti-Squeak (to Inst. Panel).....	212914	1	1
19-1-15	Clamp, Lower (Die Cast) (around Steering Column to Upper Bracket).....	212543	1	1
	Bolt and L/W (to Upper Bracket).....	212663	2	2
	Shim.....	212662	1	1
	Plug (Directional Signal Switch Wiring Hole).....	212707	1	1
	Plate, Retaining.....	212708	1	1
	Screw, No. 8-32 x 1 3/4" Pan Hd. Cr. Rec.....	972	1	1
	Plug (Vent Control Hole).....	207578	2	2
<b>14.126 - STEERING WHEEL</b>				
7-4-2	Wheel (Starlight Pearl).....	212396	1	1
7-4-8	Nut.....	201206	1	1
<b>14.200 - STEERING GEAR LEVER ARM (PITMAN)</b>				
14-1-19	Arm.....	212397	1	1
14-1-20	Lockwasher.....	201216	1	1
14-1-21	Nut.....	201217	1	1
<b>14.216 - STEERING TIE ROD</b>				
14-2-15	Tie Rod and Ball Stud, Right (Long).....	212398	1	1
14-2-16	Tie Rod and Ball Stud, Left (Short).....	212399	1	1
14-2-1	Tie Rod End.....	212400	2	2
14-2-5	Nut, 7/16"-20 Hx. Sl.....	500	4	4
14-2-4	Cotter Pin, 3/32" Dia.....	791	4	4
14-2-2	Dust Seal.....	212401	4	4
14-2-14	Adjusting Link.....	208393	2	2
14-2-10	Clamp.....	201221	4	4
14-2-11	Bolt, 5/16"-24 x 1 1/4" Hx. Hd.....	418	4	4
14-2-12	Lockwasher.....	191	4	4
14-2-13	Nut, 5/16"-24 Hx.....	641	4	4
	Oiler.....	202121	4	4