

FIGURE 40-1—HEATER (Part No. 100171) AND AIR DUCTS

FIGURE 40-1-HEATER (Part No. 100171) AND AIR DUCTS

KEY	PART NAME	GROUP	KEY	PART NAME	GROUP
1	Tube, Fresh Air Intake, Left.....	40.010	26	Hose, Heater to Engine.....	40.002
2	Damper, Fresh Air, Left.....	40.010	27	Motor, Heater.....	40.002
3	Bracket, Tube Mounting, Left.....	40.010	28	Fan, Heater.....	40.002
4	Flange, Fresh Air Intake.....	40.010	29	Clamp, Hose.....	40.002
5	Screw, Fresh Air Intake Flange.....	40.010	30	Nut, Switch Mounting Bracket Screw.....	40.002
6	Gasket, Fresh Air Damper Mounting.....	40.010	31	Screw, Switch Mounting Bracket.....	40.002
7	Nut, Fresh Air Damper Control Cable.....	40.010	32	Cable, Switch Feed.....	40.002
8	Lockwasher, Fresh Air Damper Control Cable.....	40.010	33	Bracket, Switch Mounting.....	40.002
9	Cable, Fresh Air Damper Control, Left.....	40.010	34	Bracket, Hose Support.....	40.002
10	Clamp Assembly, Fresh Air Intake Tube.....	40.010	35	Screw, Switch Terminal.....	40.002
11	Screw, Fresh Air Damper.....	40.010	36	Lockwasher, Switch Terminal Screw.....	40.002
12	Screen, Fresh Air Intake.....	40.010	37	Knob, Switch Control.....	40.002
13	Air Duct Package, Left.....	40.010	38	Nut, Switch Mounting.....	40.002
14	Hose, Defroster, Left.....	40.008	39	Nipple, Water Pump to Hose.....	40.002
15	Hose, Defroster, Right.....	40.008	40	Valve, Heater Shut-Off.....	40.002
16	Core, Heater.....	40.002	41	Switch, Heater.....	40.002
17	Nut, Heater Mounting.....	40.002	42	Heater Package.....	40.002
18	Lockwasher, Heater Mounting.....	40.002	43	Tube, Fresh Air Intake, Right.....	40.010
19	Flatwasher, Heater Mounting.....	40.002	44	Cable, Fresh Air Intake Control, Right.....	40.010
20	Spacer, Heater Mounting.....	40.002	45	Damper, Fresh Air, Right.....	40.010
21	Gasket, Heater Mounting.....	40.002	46	Nut, Tube Mounting Bracket.....	40.010
22	Heater (serviced in Heater Package).....	40.002	47	Lockwasher, Tube Mounting Bracket.....	40.010
23	Baffle (Nozzle) Defroster, Right.....	40.008	48	Screw, Tube Mounting Bracket.....	40.010
24	Baffle (Nozzle) Defroster, Left.....	40.008	49	Bracket, Tube Mounting.....	40.010
25	Hose (serviced in Rolls only).....	40.002	50	Air Duct Package, Right.....	40.010

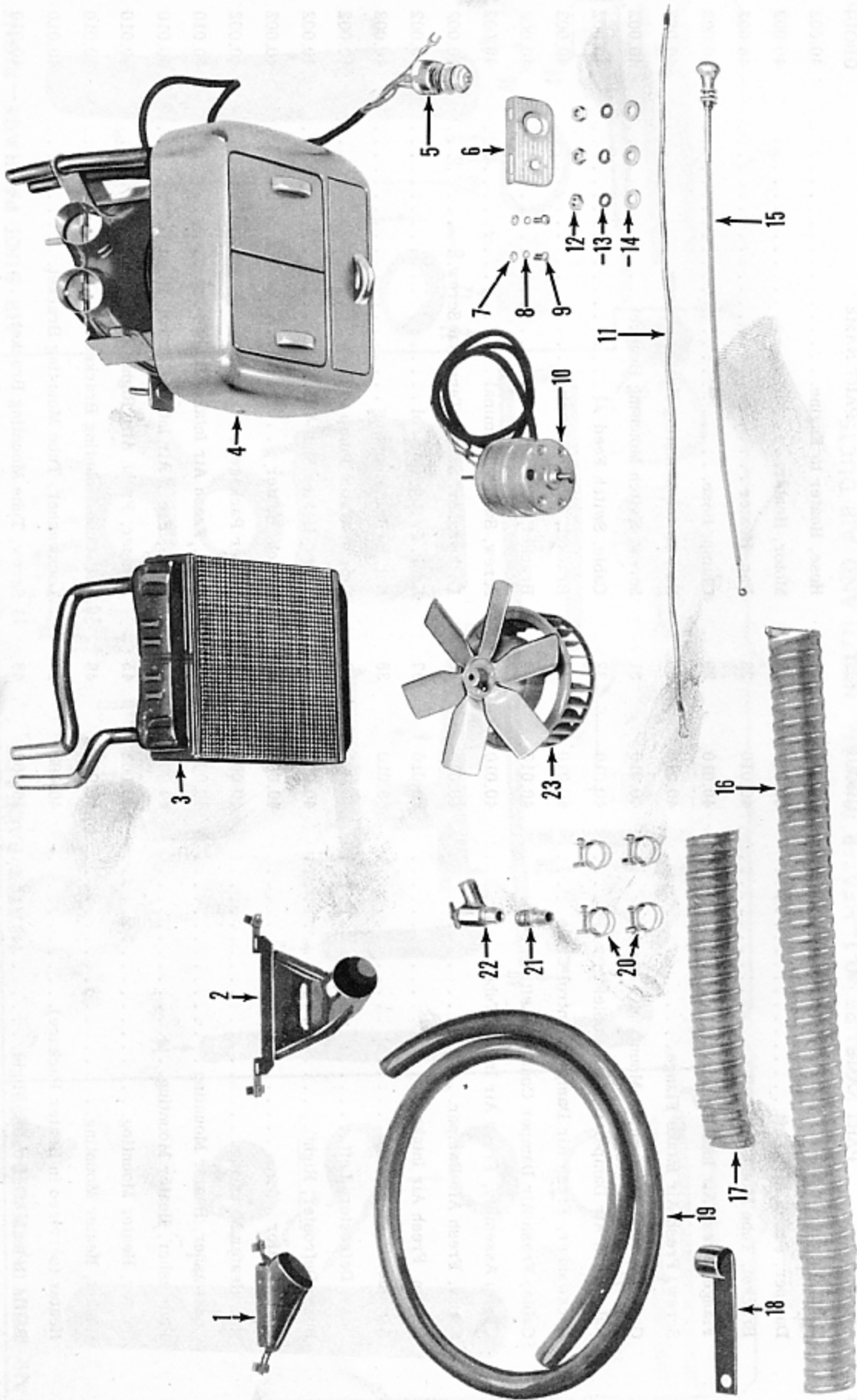

FIGURE 40-2-HEATER (Part No. 100238)—EXPLODED VIEW

FIGURE 40-2—HEATER (Part No. 100238)—EXPLODED VIEW

KEY	PART NAME	GROUP	KEY	PART NAME	GROUP
1	Nozzle, Defroster, Left	40.008	13	Lockwasher, Heater Mounting	40.002
2	Nozzle, Defroster, Right	40.008	14	Flatwasher, Heater Mounting	40.002
3	Core, Heater	40.002	15	Cable, Defroster Control	40.008
4	Heater (not serviced separately)		16	Hose, Defroster, Left	40.008
5	Switch and Knob, Heater	40.002	17	Hose, Defroster, Right	40.008
6	Bracket, Defroster Control Cable Support	40.008	18	Bracket, Hose Support	40.002
7	Nut, Cable Support Bracket	40.008	19	Hose (serviced in Rolls only)	40.002
8	Lockwasher, Cable Support Bracket	40.008	20	Clamp, Hose	40.002
9	Screw, Cable Support Bracket	40.008	21	Nipple, Hose to Water Pump	40.002
10	Motor, Heater	40.002	22	Valve, Heater Shut-Off	40.002
11	Cable, Switch Feed	40.002	23	Fan and Wheel, Heater	40.002
12	Nut, Heater Mounting	40.002			

ACCESSORIES

FIGURE NUMBER	GROUP, PART NAME and DESCRIPTION	PART NUMBER	USED PER CAR MODEL	
			513	514
	40.002 - AIR CONDITIONER (HEATER)			
	NOTE: Heater Package includes Heater, Defroster and all parts necessary for installation.			
40-1-42	Heater (Package)	100171	1	1
	NOTE: The following parts are furnished separately for repairs.			
40-1-21	Gasket, Heater Mounting	212519	1	1
40-1-20	Spacer, Heater Mounting	212425	1	1
40-1-18	Lockwasher, 5/16" Ext. Tooth	348	4	4
40-1-19	Flatwasher, 5/16" Lg.	300	4	4
40-1-17	Nut, 5/16"-24 Hx.	189	4	4
40-2-13	Lockwasher, 5/16" Med	240	3	3
40-2-14	Flatwasher, 5/16" Med	344	3	3
40-2-12	Nut, 5/16"-18 Hx.	862	3	3
40-1-16	Core, Heater (for 100171 Heater)	212520	1	1
40-2-3	Core, Heater (for 100238 Heater)	213034	1	1
40-1-27	Motor, Heater (for 100171 Heater)	212521	1	1
40-2-10	Motor, Heater (for 100238 Heater)	212958	1	1
40-1-28	Fan, Heater (for 100171 Heater)	212522	1	1
40-2-23	Fan and Wheel, Heater (for 100238 Heater)	213018	1	1
40-1-41	Switch, Heater	212426	1	1
40-1-38	Nut, Switch Mounting	212092	1	1
40-2-5	Switch and Knob (for 100238 Heater)	212957	1	1
40-1-35	Screw, Terminal, No. 8-32 x 1/4" Rd. Hd. Cr. Rec.	357	2	2
40-1-36	Lockwasher, No. 8 Int. Tooth	273	2	2
40-1-33	Bracket, Switch Mounting	212427	1	1
40-1-31	Screw, No. 10-24 x 7/16" Rd. Hd. Cr. Rec.	706	2	2
40-1-30	Nut	212368	1	1
40-1-32	Cable, Switch Feed (25" Long) (for 100171 Heater)	212428	1	1
40-2-11	Cable, Switch Feed (22" Long)	212959	1	1
	Clip, Cable Support	213035	2	2
40-1-37	Knob, Switch Control (for 100171 Heater)	212429	1	1
40-1-40	Valve, Heater Shut-Off (for 100171 Heater)	212430	1	1
40-2-22	Valve, Heater Shut-Off (for 100238 Heater)	213036	1	1
40-1-39	Nipple, Water Pump to Hose (for 100171 Heater)	201998	1	1
40-2-21	Nipple, Water Pump to Hose (for 100238 Heater)	213037	1	1
40-1-34	Bracket, Hose Support (for 100171 Heater)	212431	1	1
40-2-18	Bracket, Hose Support (for 100238 Heater)	213038	1	1
40-1-25	Hose, Heater (for 100171 Heater)	201994	1	1
40-2-19	Hose, Heater (for 100238 Heater)	213039	1	1
40-1-26	Hose, Heater to Engine (Formed) (for 100171 Heater)	212433	1	1
40-2-20	Clamp, Heater Hose	205101	4	4
	Hose, 5/8" I.D. x 50'	202004	*	*
	Hose, 5/8" I.D. x 100'	202006	*	*
	NOTE: Part Nos. 201994 and 213039 to be cut from 202004 (or) 202006.			
	40.008 - DEFROSTER CONTROLS			
	Knob, Defroster Control (for 100171 Heater)	212523	1	1
40-2-15	Cable, Defroster Control	212973	1	1
	Lockwasher, 3/8" Ext. Tooth	291	1	1
	Nut, 3/8"-24 Hx. Lt.	290	1	1
40-2-6	Bracket, Cable Support	213040	1	1
40-2-9	Screw, No. 10-32 x 5/8" Rd. Hd. Cr. Rec.	688	2	2
40-2-8	Lockwasher, No. 10 Med	254	2	2
40-2-7	Nut, No. 10-32 Hx	202	2	2

FIGURE NUMBER	GROUP, PART NAME and DESCRIPTION	PART NUMBER	USED PER CAR MODEL		
			513	514	
40.008 - DEFROSTER CONTROLS (Cont'd)					
40-1-23	Baffle (Nozzle) Defroster, Right	for 100171 Heater	212675	1	1
40-1-24	Baffle (Nozzle) Defroster, Left		212674	1	1
	Screw, No. 8-15 x 7/8" Ov. Hd. Cr. Rec. Tap		520	4	4
	Nut ("J" Type)		212995	4	4
40-2-2	Nozzle, Defroster, Right	for 100238 Heater	212916	1	1
40-2-1	Nozzle, Defroster, Left		212915	1	1
	Clip, Nozzle ("S" Type)		212978	4	4
	Screw, No. 10-12 x 3/8" Pan Hd. Cr. Rec. Tap		594	4	4
40-1-15	Hose, Defroster, Right	for 100171 Heater	212524	1	1
40-1-14	Hose, Defroster, Left		212525	1	1
40-2-17	Hose, Defroster, Right	for 100238 Heater	213043	1	1
40-2-16	Hose, Defroster, Left		213044	1	1
40.010 - FRESH AIR DUCTS					
40-1-50	Air Duct (Package) Right		100172	1	1
40-1-13	Air Duct (Package) Left		100173	1	1
NOTE: The following parts are furnished separately for repairs.					
40-1-45	Damper, Fresh Air, Right		212434	1	1
40-1-2	Damper, Fresh Air, Left		212435	1	1
40-1-11	Screw, No. 10-12 x 1/2" Rd. Hd. Cr. Rec. Tap. (Right)		648	8	8
40-1-6	Gasket, Fresh Air Damper Mounting		212889	2	2
40-1-4	Flange, Fresh Air Intake		212437	2	2
40-1-5	Screw, No. 14-10 x 1/2" Rd. Hd. Cr. Rec. Tap		619	6	6
40-1-12	Screen, Fresh Air Intake		212438	2	2
40-1-43	Tube, Fresh Air Intake, Right		212439	1	1
40-1-1	Tube, Fresh Air Intake, Left		212440	1	1
40-1-49	Bracket, Tube Mounting, Right		212441	1	1
40-1-48	Screw, No. 10-24 x 3/8" Tr. Hd. Cr. Rec.		946	1	1
40-1-47	Lockwasher, No. 10 Int. Tooth		259	1	1
40-1-46	Nut, No. 10-24 Hx		378	1	1
40-1-3	Bracket, Tube Mounting, Left		212442	1	1
	Screw, No. 10-24 x 7/8" Rd. Hd. Sl.		401	1	1
	Lockwasher, No. 10 Ext. Tooth		294	1	1
	Nut, No. 10-24 Hx		378	1	1
40-1-10	Clamp, Fresh Air Intake Tube		212443	4	4
40-1-44	Cable, Fresh Air Intake Control, Right		212444	1	1
40-1-9	Cable, Fresh Air Damper Control, Left		212445	1	1
40-1-8	Lockwasher, 3/8" Ext. Tooth		291	2	2
40-1-7	Nut, 3/8"-24 Hx. Lt.		290	2	2
40.020 - "SAV-A-BATTERY" Filler-CAPS					
	Cap, Filler (Package) (set of 3) (3/4" Dia.) (Regular)		100289	*	*
	Cap, Filler (Package) (set of 3) (3/4" Dia.) (Willard only)		100290	*	*
	Cap, Filler (Package) (set of 3) (7/8" Dia.)		100291	*	*
	Cap, Filler (Package) (set of 3) (1" Dia.)		100292	*	*
	Cap, Filler (Package) (set of 3) (1 1/4" Small)		100293	*	*
	Cap, Filler (Package) (set of 3) (1 1/4" Large)		100294	*	*
	Cap, Filler (Package) (12 sets assorted sizes)		100295	*	*
40.100 - RADIO					
NOTE: Radio Package as listed does not include Antenna.					
19-1-13	Radio (Package) (6 Tube)		100205	1	1
40.102 - ANTENNA (MANUAL)					
	Antenna (63")		100152	1	1
	Antenna (93")		100153	1	1

*As Required

ACCESSORIES

FIGURE NUMBER	GROUP, PART NAME and DESCRIPTION	PART NUMBER	USED PER CAR MODEL	
			513	514
	40.104 - SPOTLIGHT			
	Spotlight (Package) (Large)	100104	1	1
	Spotlight (Package) (Small)	100094	1	1
	Spotlight (Package) (Small) (Hand Type)	100236	1	1
	NOTE: The following parts are furnished separately for repairs.			
	Sealed Beam Unit (Large)	205076	1	1
	Sealed Beam Unit (Small) (used with 100094 and 100236)	205077	1	1
	Bezel, Sealed Beam Unit (Large)	204886	1	1
	Bezel, Sealed Beam Unit (Small) (used with 100094 and 100236)	204887	1	1
	Screw, No. 10-32 x 5/8" Ov. Hd. Sl. (Chrome)	769	1	1
	Bracket, Outer, Right	202765	1	1
	Bracket, Outer, Left	202766	1	1
	Screw, No. 10-12 x 5/8" Ov. Hd. Cr. Rec.	702	1	1
	Switch, Hand Spotlight	213178	1	1
	Stand, Spotlight Display	100057		
	40.105 - SPOTLITER			
	Spotliter (Package)	100270	1	1
	40.108 - BACK-UP LIGHTS			
	Back-Up Light (Package) Right	100100	1	1
	Back-Up Light (Package) Left	100101	1	1
	Wiring (Package) Back-Up Light	100222	1	1
	NOTE: The following parts are furnished separately for repairs.			
	Bulb	201360	2	2
	Lens	205420	2	2
	Gasket, Lens	205425	2	2
	Bezel (Door) Lens	205421	2	2
	Screw, No. 8-32 x 5/8" Rd. Hd. Sl.	707	2	2
	Switch	202955	1	1
	Lockwasher, 7/16" Int. Tooth	305	1	1
	Nut, 7/16"-20 Hx.	205671	1	1
	Bracket, Switch Mounting	209639	1	1
	Spacer	209640	2	2
	Screw, No. 10-24 x 1 3/4" Rd. Hd. Cr. Rec.	924	2	2
	Lockwasher, No. 10 Ext. Tooth	294	2	2
	40.112 - FOGLIGHTS			
	Foglight (Package) (Pair)	100103	1	1
	NOTE: The following parts are furnished separately for repairs.			
	Sealed Beam Unit	202178	2	2
	Switch	205407	1	1
	Fuse (14 Amp.)	202011	1	1
	Stand, Foglight Display	100057		
	40.113 - DOOR FRAME AND FRONT WINDOW VENTILATOR			
	Ventilator (Package)	100254	1	1
	NOTE: For Component parts SEE Group 30.206.			

ACCESSORIES

FIGURE NUMBER	GROUP, PART NAME and DESCRIPTION	PART NUMBER	USED PER CAR MODEL	
			513	514
	40.115 - WINDSHIELD VISOR			
	Windshield Visor, Outside (Package)	100146	1	1
	Windshield Visor End Bracket, Outside (Package)	213278	1	1
	Glareshield (Package) Inside Visor	100250	1	1
	40.116 - WINDSHIELD WASHER			
	Washer (Package)	100105	1	1
	<u>NOTE: The following parts are furnished separately for repairs.</u>			
	Bracket, Mounting	209674	1	1
	Tank (Glass) (Wide Mouth) (used with 100105)	213062	1	1
	Jet	202773	2	2
	Valve, Control	205430	1	1
	Connector, "Y", Vacuum Line	212469	1	1
	Solvent Fluid (Anti-Freeze) (6 oz. Bottle)	200033	*	*
	40.117 - SPARE TIRE VALVE EXTENSION			
	Extension, Spare Tire Valve	100257	1	1
	40.118 - REAR VIEW MIRROR (OUTSIDE)			
	Mirror, Right (or) Left (Clamp-On Type)	100142	*	*
	Mirror, Right (or) Left (Door Panel Type)	100143	*	*
	40.120 - VANITY MIRROR			
	Mirror	200021	1	1
	40.122 - WHEEL TRIM RINGS			
	<u>NOTE: For Single Ring SEE Group 16.028.</u>			
	Ring (Package) (set of 5) (Stainless Steel)	100217	1	
	40.123 - CONTINENTAL SPARE WHEEL MOUNT			
	Continental Spare Wheel Mount (Package)	100282	1	1
	Cover, Continental Spare Tire	213295	1	1
	40.132 - SEAT COVERS			
	<u>NOTE: The following are used in cars with Folding Rear Seat.</u>			
	Cover Set, Matting	100237	1	1
	Cover Set, Plastic (Toreador Pattern)	100264		1
	<u>NOTE: The following are used in cars with Stationary Rear Seat.</u>			
	Cover Set, Matting	100255	1	1
	Cover Set, Plastic (Toreador Pattern)	100265		1

ACCESSORIES

FIGURE NUMBER	GROUP, PART NAME and DESCRIPTION	PART NUMBER	USED PER CAR MODEL		
			513	514	
	40.133 - SEALERS				
	Perfect Seal Gasket Paste	200047			
	Presstite Cord (80' Roll)	100117			
	Sealzit (2 oz. Bottle)	100051			
	40.134 - PROTECTIVE MATERIALS				
	Auto Cleaner and Wax (Pint)	200037			
	Auto Polish and Cleaner (Pint)	200036			
	Auto Polish and Cleaner (Gallon)	100055			
	Black Rubber Finish (Gallon)	200043			
	Chrome Coating (8 oz.)	100247			
	Chrome Coating (Gallon)	100248			
	Chrome Polish (8 oz.)	200044			
	Fabric Cleaner (Pint)	200040			
	General Use Oil (4 oz.)	200039			
	Glass Cleaner (10 oz. Can)	100256			
	Radiator Flush (Pint)	200046			
	Radiator Rust Resistor (Pint)	200041			
	Radiator Stop Leak (10 oz.)	200038			
	Spot Remover (5 oz.)	200045			
	White Side Wall Tire Cleaner (13 oz.)	100052			
	White Side Wall Tire Cleaner (Gallon)	100053			
	Lustur Seal No. 1	100065			
	Lustur Seal No. 2	100066			
	Lustur Seal Applicator	100068			
	Lustur Seal Banner	100278			
	Lustur Seal Buffer Pad Backing Plate	100069			
	Lustur Seal Decal	100279			
	Lustur Seal Haze Cream	100067			
	Lustur Seal Literature Kit	100175			
	Pads, Buffer (Lambswool)	100098			
	Miracle Power (8 oz. Bottle)	100281			
	Miracle Power Spray (11 oz. Can)	100296			
	DGF 123 (Dry Graphite Film) (11 oz. Can)	100297			
	40.1345 - LUBRIPLATE				
	Lubriplate (2 oz.)	200032			
	40.142 - DIRECTIONAL SIGNAL				
	Directional Signal (Package)	100216	1	1	
	NOTE: The following parts are furnished separately for repairs.				
	Switch	212750	1	1	
	Bracket, Switch Mounting	212751	1	1	
	Screw, No. 8-32 x 3/8" Pan Hd. Sl.	975	2	2	
	Lockwasher, No. 8 Ext. Tooth	447	2	2	
	Strap, Switch Mounting (Slotted)	213375	1	1	
	Strap, Switch Mounting (with Tongue) (with Nut)	212752	1	1	
	Screw, No. 8-32 x 5/8" Rd. Hd. Sl.	976	1	1	
	Lever, Directional Signal Switch	213172	1	1	
	Ring, Switch Cancelling	212753	1	1	
	Screw, No. 8-15 x 5/16" Pan Hd. Sl. Tap	977	3	3	
	Clip, Switch Ground	212754	1	1	
	Flasher, Signal Light	203831	1	1	
	Bracket, Flasher	203832	1	1	
	Screw, No. 10-12 x 1/2" Rd. Hd. Cr. Rec. Tap	648	1	1	

ACCESSORIES

FIGURE NUMBER	GROUP, PART NAME and DESCRIPTION	PART NUMBER	USED PER CAR MODEL	
			513	514
			<p>40.142 - DIRECTIONAL SIGNAL (Cont'd)</p> <p>Cable, Signal and Parking Light 212755 2 2</p> <p>Bulb 204579 2 2</p> <p>Grommet, Cable 212756 1 1</p> <p>Shield, Wiring Harness 212757 1 1</p> <p>Shim, Shield to Bracket 212758 1 1</p> <p>Clip (Wrap-Around) Wiring Harness 205427 7 7</p> <p>Clip, Wiring Harness 205693 4 4</p>	
<p>40.146 - ANTI-FREEZE</p> <p>Alcohol (24 - 1 Quart Cans) 100128</p> <p>Alcohol (6 - 1 Gallon Cans) 100127</p> <p>Alcohol (54 Gallon Drum) 100126</p> <p>Permanent (6 - 1 Gallon Cans) 100145</p>				
<p>40.149 - ELECTRIC SHAVER</p> <p>Shaver 100131</p>				
<p>40.150 - DOOR VENTSHADES</p> <p>Ventshade (Set of 2) (2 Door Models) 100283 1 1</p>				
<p>40.157 - CIGAR LIGHTER</p> <p>Lighter (Package) 100209 1</p>				
<p><u>NOTE: The following parts are furnished separately for repairs.</u></p>				
<p>Nut, Terminal, No. 8-32 Hx. 272 1</p> <p>Lockwasher, No. 8 Int. Tooth. 273 1</p> <p>Knob and Element 212100 1</p> <p>Base and Clamp. 201504 1</p> <p>Cable, Feed 212101 1</p>				
<p>40.158 - COURTESY LIGHT</p> <p>Light (Package) 100210 1 1</p>				
<p><u>NOTE: The following parts are furnished separately for repairs.</u></p>				
<p>Switch 200821 1 1</p> <p>Screw, No. 8-32 x 1/4" Rd. Hd. Cr. Rec. 357 2 2</p> <p>Lockwasher, No. 8 Ext. Tooth 447 2 2</p> <p>Screw, Terminal, No. 8-32 x 1/4" Rd. Hd. Cr. Rec 357 2 2</p> <p>Lockwasher, No. 8 Ext. Tooth 447 2 2</p> <p>Harness, Wiring 212098 1 1</p> <p>Bulb 6-8V, 6 C.P. S.C. 202658 2 2</p> <p>Socket, Wiring Harness. 212099 2 2</p>				

ACCESSORIES

FIGURE NUMBER	GROUP, PART NAME and DESCRIPTION	PART NUMBER	USED PER CAR MODEL	
			513	514
			40.159 - DOOR ARM REST	
	Arm Rest (Package) (Century Brown) { Plain }	100211	1	
	Arm Rest (Package) (Temple Gray) { Vinylite }	100212	1	
	Arm Rest (Package) (Burma Dragon) { Dragon }	100213		1
	Arm Rest (Package) (Cape Verde Green) { Vinylite }	100214		1
40.161 - QUARTER PANEL WINDOW VENTILATOR				
	Ventilator (Package)	100220	1	1
<u>NOTE: The following parts are furnished separately for repairs.</u>				
	Ventilator Complete, Right	212494	1	1
	Ventilator Complete, Left	212495	1	1
	Weatherstrip, Ventilator Frame, Right	212496	1	1
	Weatherstrip, Ventilator Frame, Left	212500	1	1
	Retainer, Ventilator Weatherstrip	212718	2	2
	Filler, Ventilator Glass (Medium)	212717	2	2
	Clamp, Upper Pivot	212719	2	2
	Clamp, Lower Pivot	212720	2	2
	Handle, Ventilator, Right	212490	1	1
	Handle, Ventilator, Left	212491	1	1
	Pin, Ventilator Handle	200761	2	2
	Bracket, Ventilator Locking	212721	2	2
	Screw, No. 6-18 x 1/2" Ov. Hd. Cr. Rec. Tap. (Chrome)	509	6	6
4/52	40-164 - Wind Guards Wind Guards	100235	100235	
	40.165 - Rear Window Air Circulator Air Circulator		100239	1 1